



8 Bridge Meadow Close, Sedgeberrow, Evesham, WR11 7FJ

**£280,000**



CHRISTIAN  
LEWIS  
— PROPERTY —



## 8 Bridge Meadow Close, Sedgeberrow, Evesham, WR11 7FJ

£280,000

An immaculately presented three bedroom semi-detached home with garage and parking situated in a peaceful cul-de-sac village location, backing onto fields.

Situated at the bottom of the cul-de-sac this wonderful starter home must be viewed. The property has been well maintained by the current owners, ideal for someone looking for something slightly more rural. The property comprises of; entrance hall, kitchen, lounge/diner and w/c. Upstairs are three bedrooms and a family bathroom. Other benefits include single garage, parking and rear gardens backing out onto fields.

Additional Information

Tenure: We understand that the property is for sale Freehold.

Local Authority: Wychavon District Council

Council Tax Band: We understand that the Council Tax Band for the property is Band C

EPC Rating: E



## Floor Plans

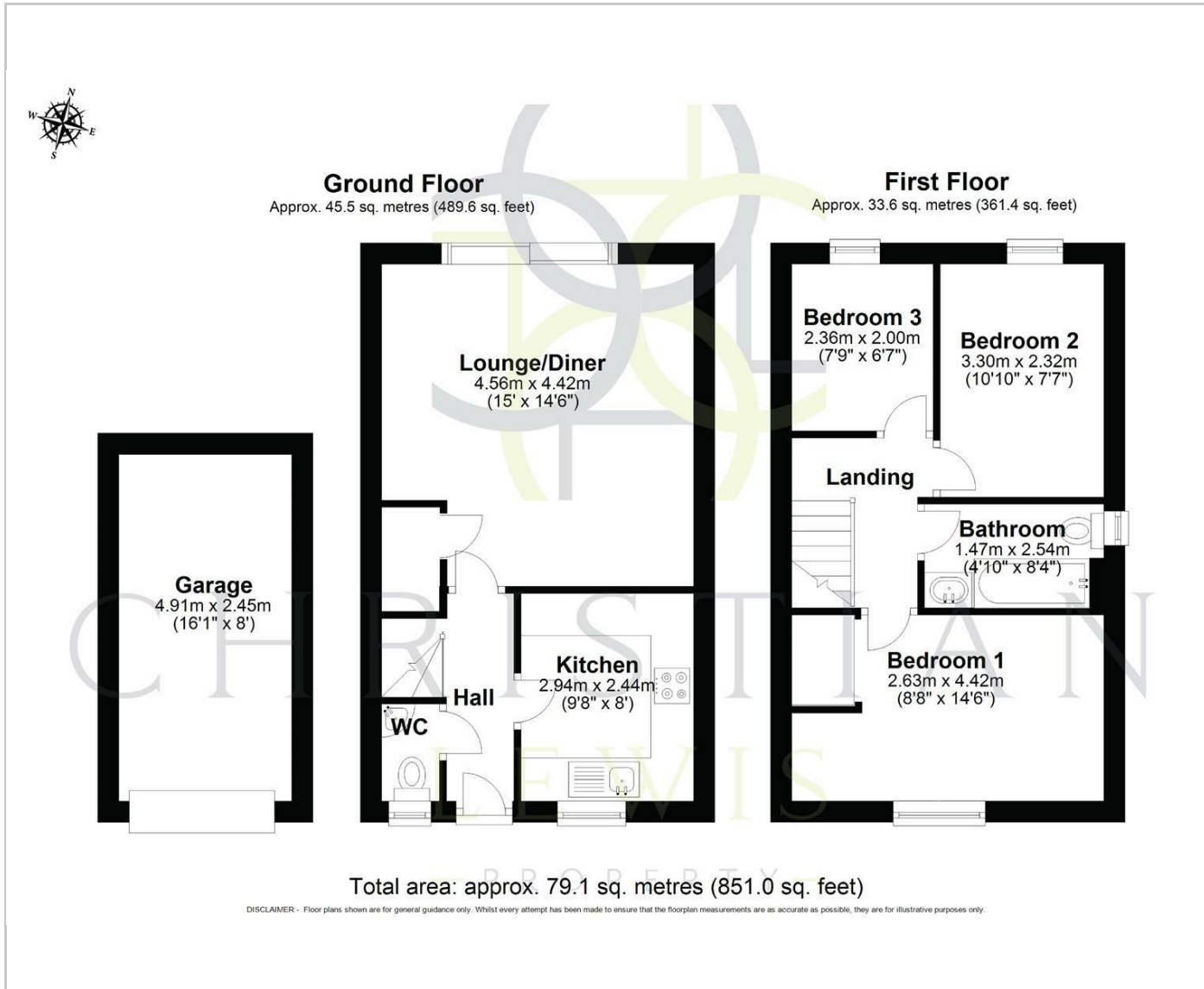

## Area Map

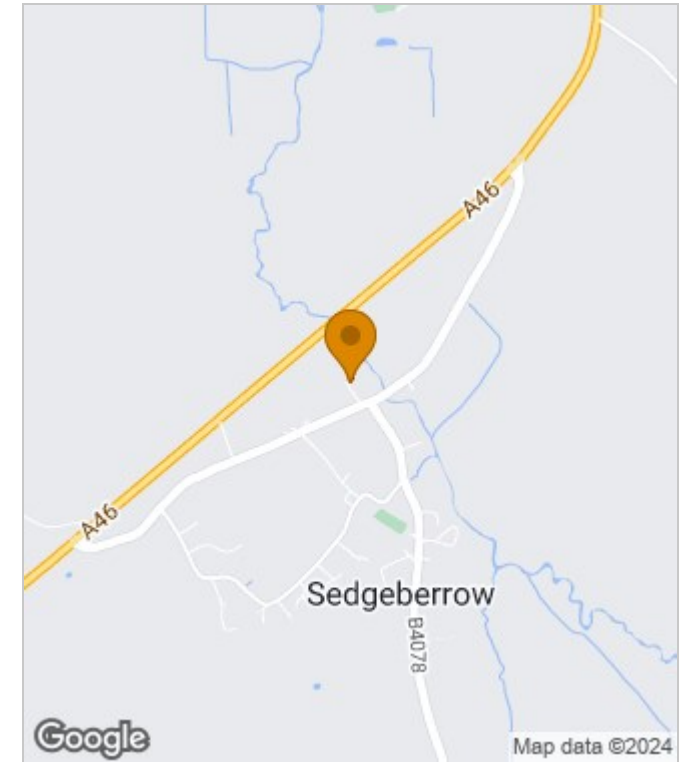

## Energy Performance Graph

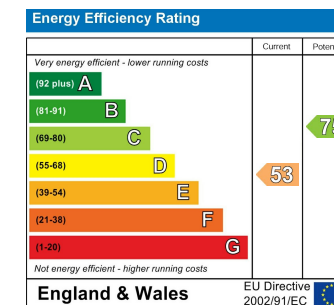

These particulars, whilst believed to be accurate are set out as a general outline only for guidance and do not constitute any part of an offer or contract. Intending purchasers should not rely on them as statements of representation of fact, but must satisfy themselves by inspection or otherwise as to their accuracy. No person in this firm's employment has the authority to make or give any representation or warranty in respect of the property.