



Kimbolton Court, Peterborough, PE1 2NL

Offers Over £75,000

 2  1  1



Butler & Co estate agents would like to welcome you to this spacious two bedroom bungalow within an over 55s retirement complex, this property benefits from being tucked away in a quiet cul-de-sac location while being less than a mile from the town centre.

This property offers a entrance hallway, living / dining room, kitchen, two bedrooms and a wet room. Outside there are front and rear gardens communal gardens and a communal parking area.

Located in the heart of Peterborough, this home offers easy access to local amenities and transport links, ensuring convenience for daily living.

Key Features

- RETIREMENT BUNGALOW - OVER 55'S ONLY
- No Chain
- Great access to local amenities
- Resident management support team
- Low maintenance
- For Sale By Online Auction, T&C Apply
- Less than a mile from city centre
- Communal gardens, seating areas and parking
- Spacious two bedroom
- Great access to transport links

GROUND FLOOR
585 sq.ft. (54.4 sq.m.) approx.

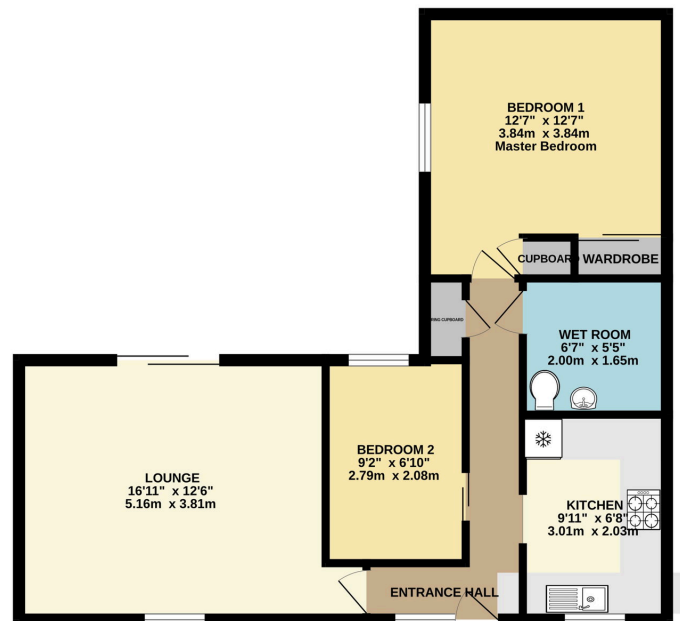

TOTAL FLOOR AREA: 585 sq.ft. (54.4 sq.m.) approx.
Whilst every attempt has been made to ensure the accuracy of the description contained here, measurements of doors, windows, rooms and any other items are approximate and no responsibility is taken for any error, omission or mis-statement. This plan is for illustrative purposes only and should be used as such by any prospective purchaser. The services, systems and appliances shown have not been tested and no guarantee is given as to their operability or efficiency on the given date.
 Made with Metropix 02024