

Cotlandswick

London Colney, AL2 1EH



Cotlandswick

London Colney, AL2 1EH

£1,750 PCM

- Available NOW
- Two Bedrooms
- End Terrace House
- Open Plan Living Room & Kitchen
- Basement With Access To Garden
 - Balcony
 - On Street Parking
 - Gas & Electric Heating
- Family Shower Room & WC
- Council Tax Band TBC (estimated D)

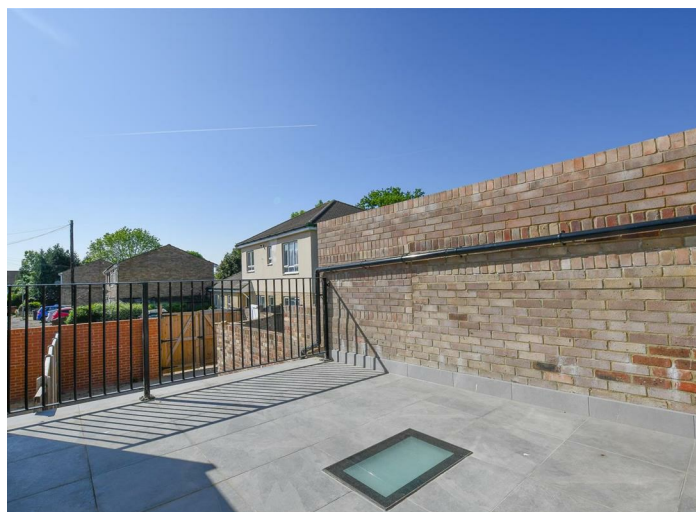



Cotlandswick

London Colney, AL2 1EH

A newly built two-bedroom mid-terraced house, located in the popular area of London Colney, within walking distance of local amenities and well-regarded schools.

The property features a spacious open-plan living room and kitchen, with direct access to a balcony overlooking the garden. Additional accommodation includes a basement room with access to a private patio and WC. On the first floor, there are two bedrooms and a modern family shower room.

The property is offered unfurnished and benefits from on-street parking.

Available NOW

Five week deposit = £2019.00



Basement
Approx. 27.2 sq. metres (292.7 sq. feet)

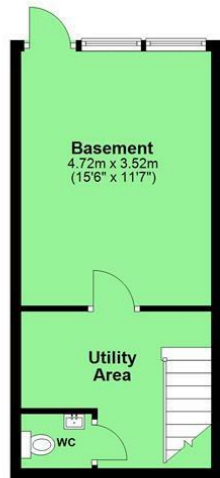

Ground Floor
Approx. 35.6 sq. metres (383.2 sq. feet)



First Floor
Approx. 33.1 sq. metres (355.8 sq. feet)

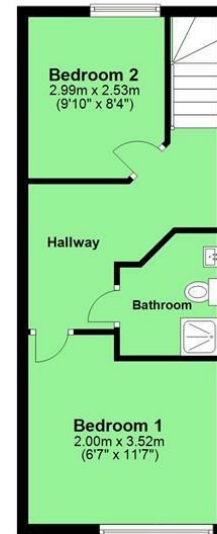

Total area: approx. 95.9 sq. metres (1031.7 sq. feet)



Energy Efficiency Rating		
	Current	Potential
Very energy efficient - lower running costs		
(92 plus) A		
(81-91) B		
(69-80) C		
(55-68) D		
(39-54) E		
(21-38) F		
(1-20) G		
Not energy efficient - higher running costs		
England & Wales		EU Directive 2002/91/EC

Environmental Impact (CO ₂) Rating		
	Current	Potential
Very environmentally friendly - lower CO ₂ emissions		
(92 plus) A		
(81-91) B		
(69-80) C		
(55-68) D		
(39-54) E		
(21-38) F		
(1-20) G		
Not environmentally friendly - higher CO ₂ emissions		
England & Wales		EU Directive 2002/91/EC

In accordance with the Consumer Protection from Unfair Trading Regulations 2008 (CPRs) and the Business Protection from Misleading Markets Regulations 2008 (BPRs) JW&CO have prepared these property particulars as a general guide to a broad description of the property. JW&CO as agents for the vendor or lessor and for themselves give notice that (a) these particulars are not intended to constitute part of an offer or contract (b) have not carried out a structural survey and the services, appliances and fittings have not been tested (c) all measurements, photographs, distances and floor plans referred to are given as a guide only and should not be relied upon for the purchase of fixtures and fittings (d) tenure details, service charges and ground rent (where applicable) are given as a guide only and should be checked and confirmed by your solicitor prior to exchange of contracts (e) neither the vendor nor any person in the employment JW&CO has any authority to make or give any representation or warranty whatsoever in respect of the property.