

# Cotlandswick

, AL2 1EG





# Cotlandswick

, AL2 1EG

£185,000

- No Upper Chain
  - Leasehold
- One Double Bedroom
  - Bathroom
- Bright Living Room
  - Kitchen
- Gas Central Heating
- Short Walk To All Local Amenities
  - Great Transportation Routes
- Ideal for First-Time Buyers Or Investors





# Cotlandswick

, AL2 1EG

Chain-Free One-Bedroom Flat in Cotlandswick, London Colney

This first-floor flat offers a bright and spacious layout, including an entrance hall, a double bedroom, a living room, a separate kitchen, and a bathroom.

Located just off the High Street, the property is within easy reach of local shops, cafes, and other amenities. The area is well connected with good transport links by road, bus, and train, making it a convenient location for commuters.

The property would benefit from some updating, offering a great opportunity for buyers looking to add their own touch. It may also appeal to investors seeking a property with strong rental potential.

Offered chain-free for a straightforward purchase. Viewings available on request.

## First Floor

Approx. 44.4 sq. metres (477.9 sq. feet)

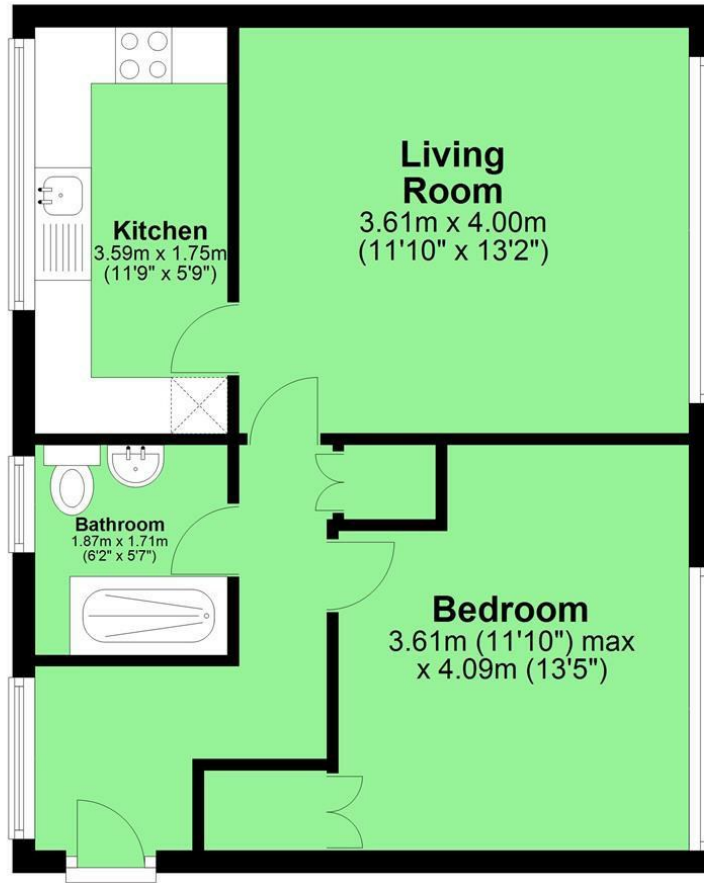

Total area: approx. 44.4 sq. metres (477.9 sq. feet)

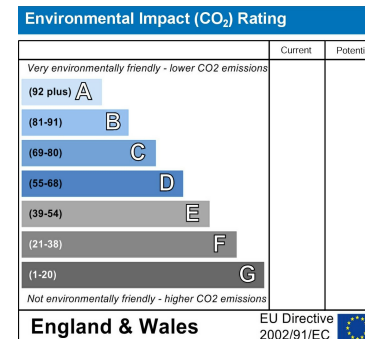
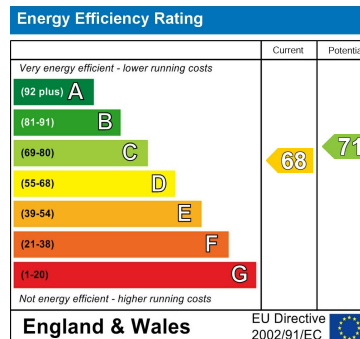
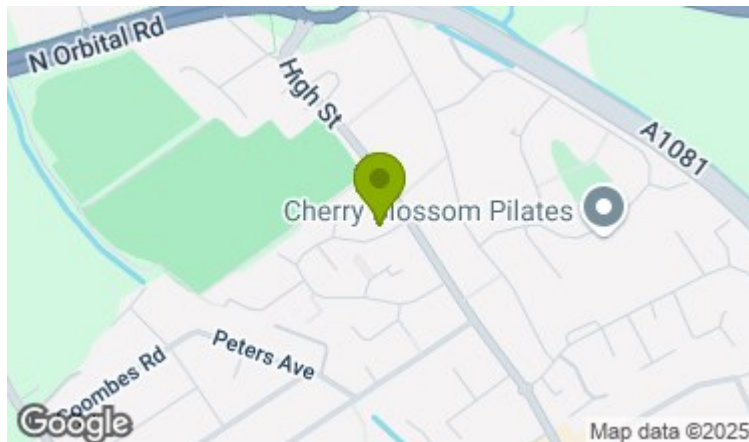

**JW&Co St Albans**  
3 London Road, St Albans, Hertfordshire, AL1 1LA  
01727 844444  
stalbands@jwandco.co.uk

**Entrance Hall**

**Bedroom**  
11'10" x 13'5" (3.61 x 4.09)

**Bathroom**  
6'1" x 5'7" (1.87 x 1.71)

**Living Room**  
11'10" x 13'1" (3.61 x 4.00)

**Kitchen**  
11'9" x 5'8" (3.59 x 1.75)

**EPC**  
D

**Council Tax Band**  
B

**Service Charge**  
£935.69 per year

**Ground Rent**  
£10 per year

**Lease Length**  
103 years remaining

### A.M.L Identity Verification

In line with UK Anti Money Laundering (AML) regulations, we are obligated to verify the identity of all prospective purchasers once an offer has been accepted. To carry out this process, we use a trusted third-party identity verification system. A nominal fee of £45 + vat per person applies for this service.

In accordance with the Consumer Protection from Unfair Trading Regulations 2008 (CPRs) and the Business Protection from Misleading Markets Regulations 2008 (BPRs) JW&CO have prepared these property particulars as a general guide to a broad description of the property. JW&CO as agents for the vendor or lessor and for themselves give notice that (a) these particulars are not intended to constitute part of an offer or contract (b) have not carried out a structural survey and the services, appliances and fittings have not been tested (c) all measurements, photographs, distances and floor plans referred to are given as a guide only and should not be relied upon for the purchase of fixtures and fittings (d) tenure details, service charges and ground rent (where applicable) are given as a guide only and should be checked and confirmed by your solicitor prior to exchange of contracts (e) neither the vendor nor any person in the employment JW&CO has any authority to make or give any representation or warranty whatsoever in respect of the property.