

Hardwicke Place

London Colney, AL2 1PX



Hardwicke Place

London Colney, AL2 1PX

£240,000

- No Upper Chain
 - Leasehold
- New Lease Extension
 - Two Bedrooms
- Quiet No Through Road
- Spacious Living Room
- Communal Grounds
- Communal Parking





Hardwicke Place

London Colney, AL2 1PX

This two-bedroom first-floor flat is located on Hardwicke Place, London Colney. Situated within easy reach of London Colney's local amenities, public transport, and excellent motorway links, this property is an ideal opportunity for investors looking to grow their buy-to-let portfolios.

Internally, the property comprises an entrance hallway, two bedrooms, a bathroom, a lounge/dining room, and a kitchen with appliances. It also benefits from residents' parking.

Additionally, the property has recently undergone a lease extension, providing long-term security and added value for prospective buyers.

Offered chain-free.



First Floor

Approx. 51.1 sq. metres (550.2 sq. feet)



JW&Co St Albans
3 London Road, St Albans, Hertfordshire, AL1 1LA
01727 844444
stalbans@jwandco.co.uk

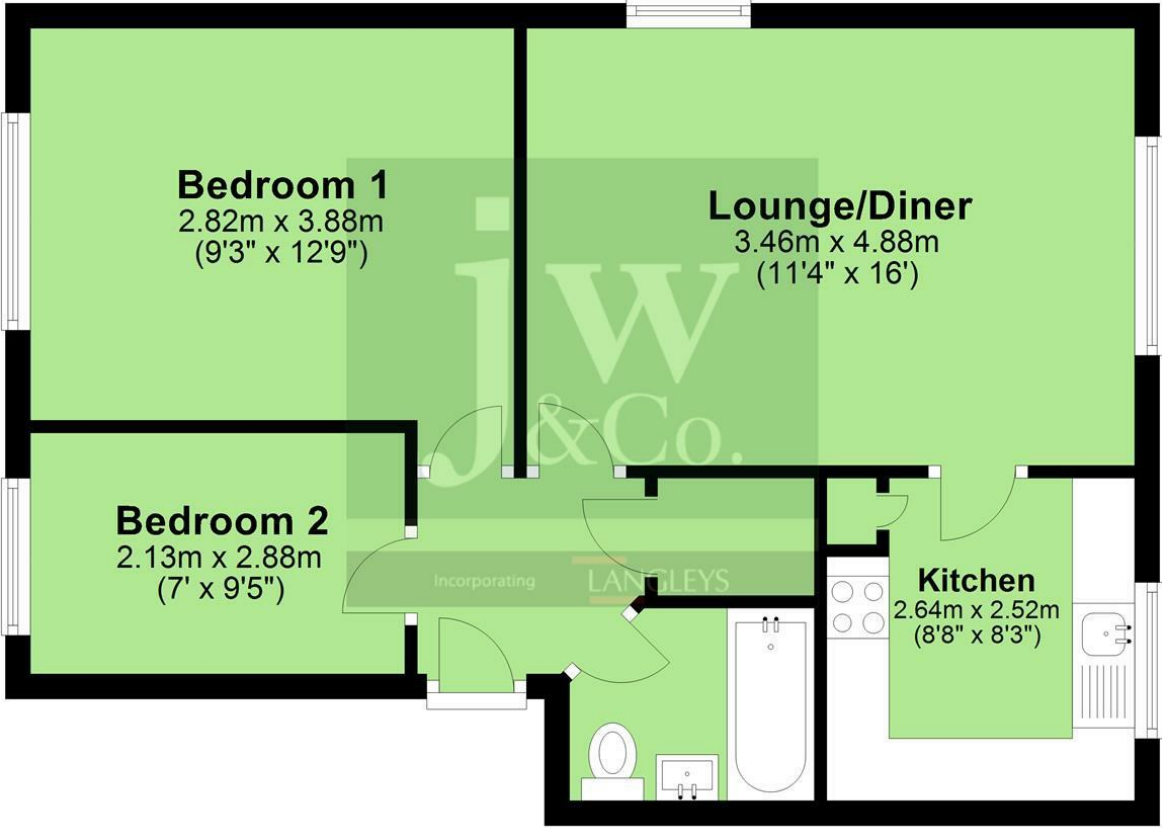

- Entrance Hallway
- Bedroom 1
9'3" x 12'8" (2.82 x 3.88)
- Bedroom 2
6'11" x 9'5" (2.13 x 2.88)
- Bathroom
- Living Room/Dining Room
11'4" x 16'0" (3.46 x 4.88)
- Kitchen
8'7" x 8'3" (2.64 x 2.52)

Total area: approx. 51.1 sq. metres (550.2 sq. feet)



Energy Efficiency Rating		
	Current	Potential
Very energy efficient - lower running costs		
(92 plus) A		82
(81-91) B		
(69-80) C		
(55-68) D		
(39-54) E		
(21-38) F		
(1-20) G		
Not energy efficient - higher running costs		
	56	
England & Wales		
EU Directive 2002/91/EC		

Environmental Impact (CO ₂) Rating		
	Current	Potential
Very environmentally friendly - lower CO ₂ emissions		
(92 plus) A		
(81-91) B		
(69-80) C		
(55-68) D		
(39-54) E		
(21-38) F		
(1-20) G		
Not environmentally friendly - higher CO ₂ emissions		
England & Wales		
EU Directive 2002/91/EC		

In accordance with the Consumer Protection from Unfair Trading Regulations 2008 (CPRs) and the Business Protection from Misleading Markets Regulations 2008 (BPMRs) JW&CO have prepared these property particulars as a general guide to a broad description of the property. JW&CO as agents for the vendor or lessor and for themselves give notice that (a) these particulars are not intended to constitute part of an offer or contract (b) have not carried out a structural survey and the services, appliances and fittings have not been tested (c) all measurements, photographs, distances and floor plans referred to are given as a guide only and should not be relied upon for the purchase of fixtures and fittings (d) tenure details, service charges and ground rent (where applicable) are given as a guide only and should be checked and confirmed by your solicitor prior to exchange of contracts (e) neither the vendor nor any person in the employment JW&CO has any authority to make or give any representation or warranty whatsoever in respect of the property.