

# North Cottages

Napsbury, AL2 1AP



# North Cottages

Napsbury, AL2 1AP

£425,000

- No Upper Chain
- Three Bedrooms
  - Mid Terrace
- Spacious Kitchen/Dining Room
  - Separate Lounge
  - Utility Area
- Downstairs Bathroom
- En Suite To Bedroom One
- Front and Rear Gardens
- Further Extension Potential (S.T.P.P)





# North Cottages

Napsbury, AL2 1AP

Presented with no upper chain, this charming three-bedroom terrace cottage offers spacious accommodation and boasts both front and rear gardens, as well as stunning countryside views. Starting on the ground floor, the accommodation comprises an entrance hall, a separate lounge, a spacious kitchen/dining room, an additional reception room, a utility area, and a downstairs bathroom. Moving upstairs, you will find three bedrooms. Bedroom one benefits from built-in wardrobes and an en suite. The property also offers ample scope for extension, subject to obtaining the necessary planning permissions.



## Ground Floor

Approx. 51.7 sq. metres (556.6 sq. feet)



## First Floor

Approx. 31.8 sq. metres (342.6 sq. feet)

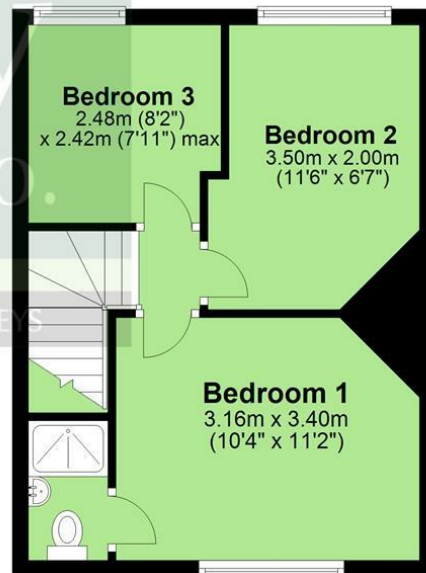

Total area: approx. 83.5 sq. metres (899.2 sq. feet)



JW&Co St Albans  
3 London Road, St Albans, Hertfordshire, AL1 1LA  
01727 844444  
stalbans@jwandco.co.uk

### Entrance Hall

**Lounge**  
10'2" x 13'1" (3.12 x 4.00)

**Kitchen/Dining Room**  
13'1" x 16'2" (4.00 x 4.95)

**Sitting Room**  
11'5" x 7'8" (3.48 x 2.34)

**Utility Area**  
4'4" x 6'10" (1.34 x 2.09)

**Bathroom**  
5'10" x 8'8" (1.80 x 2.65)

### Stairs to First Floor Landing

**Bedroom One**  
10'4" x 11'1" (3.16 x 3.40)

**En Suite**  
6'5" x 2'7" (1.98 x 0.80)

**Bedroom Two**  
11'5" x 8'8" (3.50 x 2.65)

**Bedroom Three**  
8'1" x 7'11" (2.48 x 2.42)

**EPC Rating**  
D

**Council Tax**  
Band C

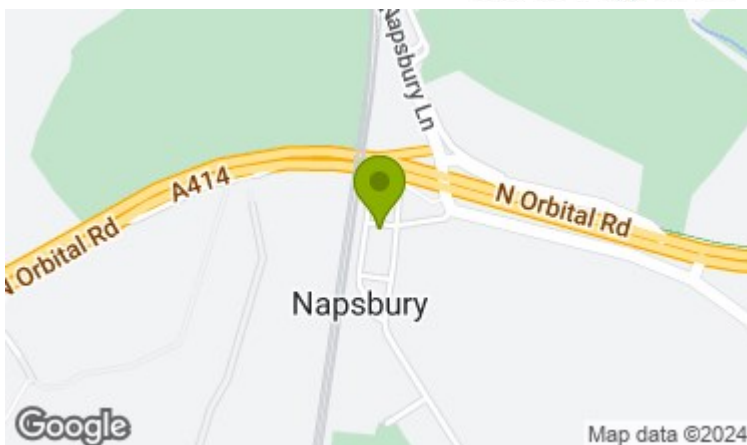

Energy Efficiency Rating		Current	Potential
Very energy efficient - lower running costs			
(92 plus) A			82
(81-91) B			
(69-80) C			
(55-68) D			
(39-54) E		66	
(21-38) F			
(1-20) G			
Not energy efficient - higher running costs			
England & Wales		EU Directive 2002/91/EC	

Environmental Impact (CO <sub>2</sub> ) Rating		Current	Potential
Very environmentally friendly - lower CO <sub>2</sub> emissions			
(92 plus) A			82
(81-91) B			
(69-80) C			
(55-68) D			
(39-54) E			
(21-38) F			
(1-20) G			
Not environmentally friendly - higher CO <sub>2</sub> emissions			
England & Wales		EU Directive 2002/91/EC	

In accordance with the Consumer Protection from Unfair Trading Regulations 2008 (CPRs) and the Business Protection from Misleading Markets Regulations 2008 (BPMRs) JW&CO have prepared these property particulars as a general guide to a broad description of the property. JW&CO as agents for the vendor or lessor and for themselves give notice that (a) these particulars are not intended to constitute part of an offer or contract (b) have not carried out a structural survey and the services, appliances and fittings have not been tested (c) all measurements, photographs, distances and floor plans referred to are given as a guide only and should not be relied upon for the purchase of fixtures and fittings (d) tenure details, service charges and ground rent (where applicable) are given as a guide only and should be checked and confirmed by your solicitor prior to exchange of contracts (e) neither the vendor nor any person in the employment JW&CO has any authority to make or give any representation or warranty whatsoever in respect of the property.