



## Allerdene Walk

Newcastle Upon Tyne NE16 4LL

£189,995







This footer paragraph is an example only and should not be relied upon as complying with current legislation. These particulars, whilst believed to be accurate are set out as a general outline only for guidance and do not constitute any part of an offer or contract. Intending purchasers should not rely on them as statements of representation of fact, but must satisfy themselves by inspection or otherwise as to their accuracy. No person in this firms employment has the authority to make or give any representation or warranty in respect of the property.

# Allerdene Walk

Newcastle Upon Tyne NE16 4LL



x 2



x 1



x 1

Seven Keys welcome to the market this two bedroom detached bungalow, with no onward chain that is ready to move straight into. The property has been improved in recent years with an updated kitchen, bathroom and redecoration throughout.

Briefly comprising a spacious entrance hallway with storage, leading into the modern fitted kitchen with integrated oven, hob and extractor hood, stainless steel sink with mixer tap and tiled splashbacks. Two double bedrooms, generous living room and desirable modern bathroom with three piece suite finish off the internal accommodation.

Externally, the property has a paced walkway and garden to the front, whilst a paved garden to the back is accessed from both the side and rear of the property.

The property's location offers convenient access to village life in Whickham with a range of convenience stores, Church's including St, Marys Parish Church and pubs. The village borders the Derwent Valley and allows for beautiful walks to appreciate the Semi Rural location. Transport routes and frequent bus services provide commuter links to Newcastle, City Centre, Metrocentre and the surrounding areas.

EPC rating D  
Council tax band B

## PLEASE NOTE

Please be advised that these for sale details and images have been supplied to us via a third party. We therefore cannot verify there accuracy and would recommend that you arrange to visit and take a look for yourself.

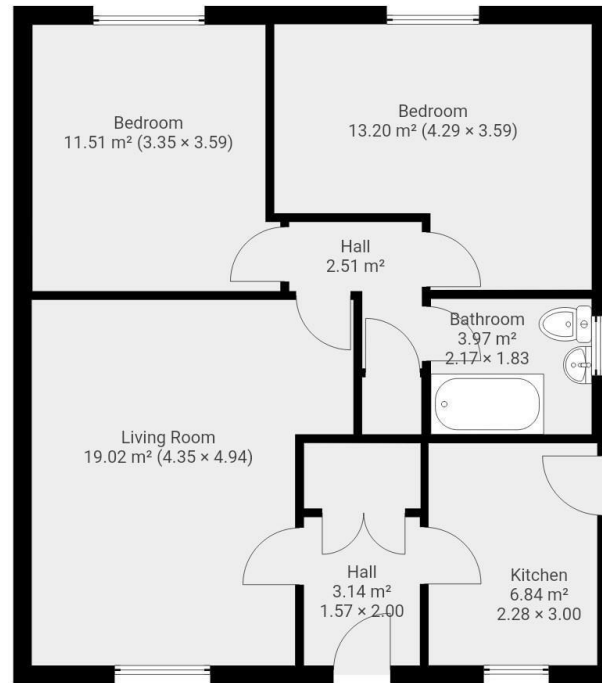

THIS FLOORPLAN IS PROVIDED WITHOUT WARRANTY OF ANY KIND. SEVEN KEYS DISCLAIMS ANY WARRANTY INCLUDING, WITHOUT LIMITATION, SATISFACTORY QUALITY OR ACCURACY OF DIMENSIONS.

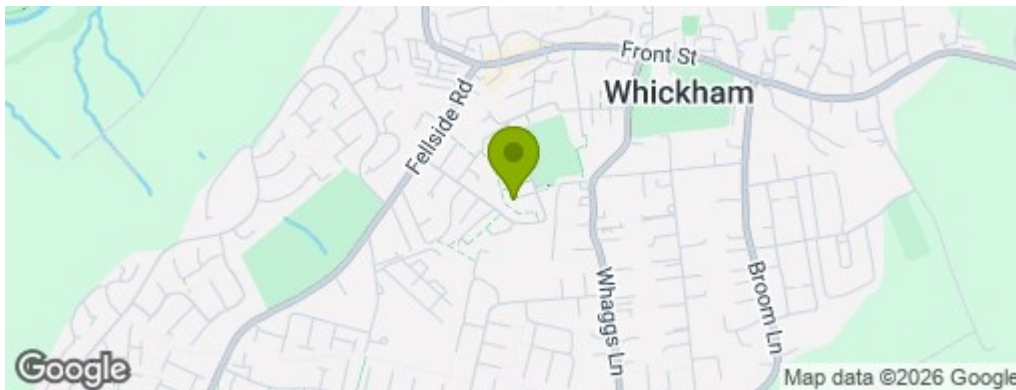

## Property Information

**0191 372 9898**

Suite 6, 15 North Burns, Chester-le-Street, County Durham, DH3 3TF  
[sales.cls@venturepropertiesuk.com](mailto:sales.cls@venturepropertiesuk.com)