



Worsley Close

Wallsend NE28 8TF

£129,950



Venture
PROPERTIES



This footer paragraph is an example only and should not be relied upon as complying with current legislation. These particulars, whilst believed to be accurate are set out as a general outline only for guidance and do not constitute any part of an offer or contract. Intending purchasers should not rely on them as statements of representation of fact, but must satisfy themselves by inspection or otherwise as to their accuracy. No person in this firms employment has the authority to make or give any representation or warranty in respect of the property.

Worsley Close

Wallsend NE28 8TF



x 2



x 1



x 1

* SOLD, SUBJECT TO CONTRACT, SIMILAR PROPERTIES REQUIRED* We are pleased to offer for sale this two bedroom property located on the popular Worsley Close, Wallsend, North Tyneside.

The property briefly comprises of spacious lounge with bay window, understairs storage cupboard, kitchen with a range of wall/base units, integrated oven and hob and space for a washing machine, whilst the kitchen also has access to the rear garden. On the first floor there are two bedrooms, include double master bedroom and the second room being a company double or single, whilst finally there is a family bathroom which is fully tiled and benefits from a shower over bath. Externally, there are gardens to both front and rear.

The property is an ideal base for Newcastle city, the coast and access to the A19. A new boiler was installed in 2024 with 5 year warranty.

Although it states online the property is of leasehold tenure, we have received confirmation that the current owner has completed on the freehold acquisition for the property.

EPC rating C
Council tax band A

DISCLAIMER

Please be advised that these for sale details and images have been supplied to us via a third party. We therefore cannot verify their accuracy and would recommend that you arrange to visit and take a look for yourself.

www.venturepropertiesuk.com

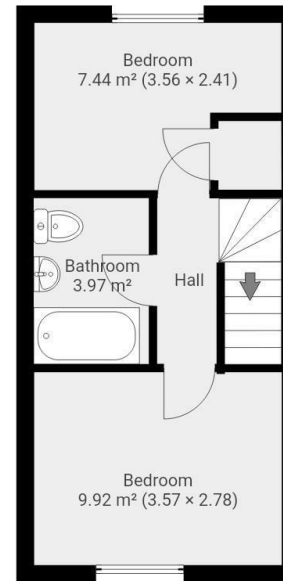
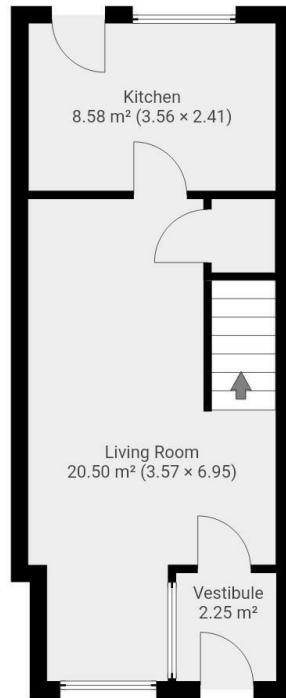

THIS FLOORPLAN IS PROVIDED WITHOUT WARRANTY OF ANY KIND. SEVEN KEYS DISCLAIMS ANY WARRANTY INCLUDING, WITHOUT LIMITATION, SATISFACTORY QUALITY OR ACCURACY OF DIMENSIONS.

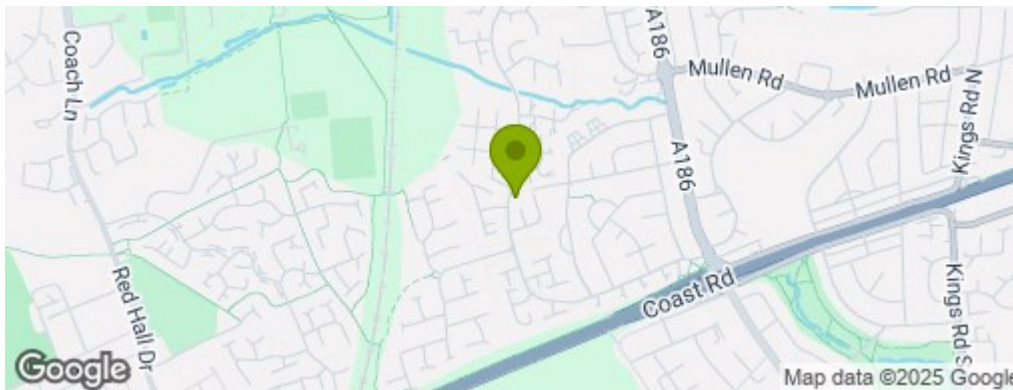

Property Information

0191 372 9898

Suite 6, 15 North Burns, Chester-le-Street, County Durham, DH3 3TF
sales.cls@venturepropertiesuk.com