



Elwin Place

Chester Le Street DH2 1EJ

£155,000





This footer paragraph is an example only and should not be relied upon as complying with current legislation. These particulars, whilst believed to be accurate are set out as a general outline only for guidance and do not constitute any part of an offer or contract. Intending purchasers should not rely on them as statements of representation of fact, but must satisfy themselves by inspection or otherwise as to their accuracy. No person in this firm's employment has the authority to make or give any representation or warranty in respect of the property.

Elwin Place

Chester Le Street DH2 1EJ



****SOLD, SUBJECT TO PROPERTY. SIMILAR PROPERTIES REQUIRED**** Nestled in the village of Pelton, near the historic town of Chester-le-Street, this extended three-bedroom semi-detached house on Elwin Place is a true gem waiting to be discovered.

As you step into the property, you are greeted by an inviting entrance vestibule, the spacious lounge boasts a delightful feature fireplace, perfect for cosy evenings with loved ones. Additionally, the sun lounge at the rear of the house offers a tranquil space to relax and enjoy the view of the newly refurbished garden.

The heart of the home lies in the refitted kitchen/dining room, complete with built-in appliances, making it a practical and stylish space for cooking and entertaining. The property also features good-sized bedrooms, ideal for creating your own personal sanctuary, and a refitted white bathroom that exudes a sense of modern elegance.

Outside, the shared driveway provides convenient parking, while the enclosed rear garden offers a private outdoor oasis, perfect for enjoying a morning coffee or hosting summer barbecues.

Don't miss the opportunity to make this charming semi-detached house in Pelton your new home. With its desirable location and well-appointed living spaces, this property is sure to capture your heart.

Freehold
Council tax band A
EPC rating - C

ENTRANCE VESTIBULE

LOUNGE

17'1" x 11'3" (5.21m x 3.43m)

SUN LOUNGE

14'1" x 9' (4.29m x 2.74m)

KITCHEN/DINING ROOM

17'1" x 10'8" (5.21m x 3.25m)

FIRST FLOOR

BEDROOM 1

11'8" x 10'8" (3.56m x 3.25m)

BEDROOM 2

11'4" max x 9' (3.45m max x 2.74m)

BEDROOM 3

8'5" x 7'10" (2.57m x 2.39m)

BATHROOM/WC/SHOWER

OUTSIDE

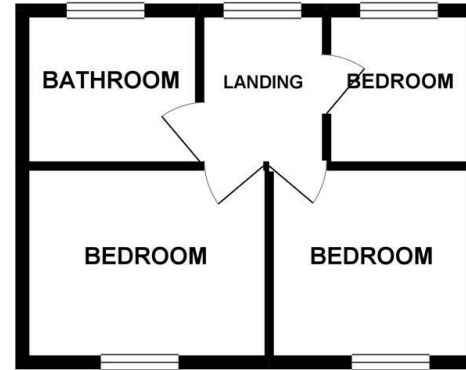
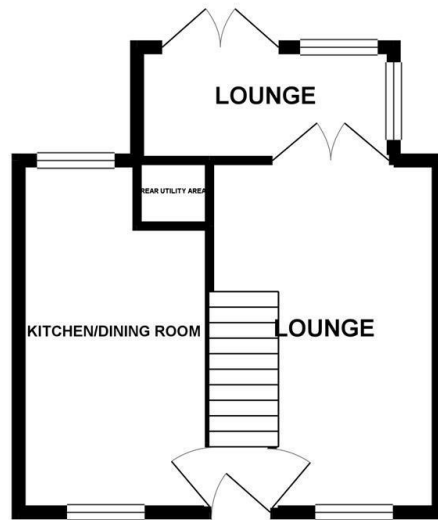

Whilst every attempt has been made to ensure the accuracy of the floorplan contained here, measurements of doors, windows, rooms and any other items are approximate and no responsibility is taken for any error, omission or mis-statement. This plan is for illustrative purposes only and should be used as such by any prospective purchaser. The services, systems and appliances shown have not been tested and no guarantee as to their operability or efficiency can be given.
Made with Metropix ©2024

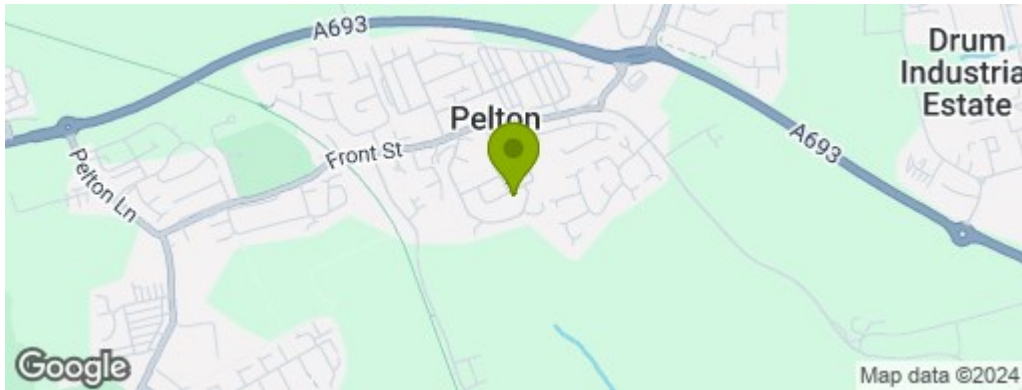

Property Information

0191 372 9898

Suite 6, 15 North Burns, Chester-le-Street, County Durham, DH3 3TF
sales.cls@venturepropertiesuk.com