



**Wensley Close**  
Chester Le Street DH2 1SE  
**£85,000**







This footer paragraph is an example only and should not be relied upon as complying with current legislation. These particulars, whilst believed to be accurate are set out as a general outline only for guidance and do not constitute any part of an offer or contract. Intending purchasers should not rely on them as statements of representation of fact, but must satisfy themselves by inspection or otherwise as to their accuracy. No person in this firm's employment has the authority to make or give any representation or warranty in respect of the property.

# Wensley Close

Chester Le Street DH2 1SE



\*\*SOLD, SUBJECT TO CONTRACT. SIMILAR PROPERTIES REQUIRED\*\* WELL PRESENTED TWO BEDROOM FIRST FLOOR FLAT with GARDEN to the front and GARAGE in a block. This property is offered with IMMEDIATE VACANT POSSESSION and comprises of UPVC DOUBLE GLAZING, GAS CENTRAL HEATING VIA RADIATORS, SPACIOUS LOUNGE with EXTENSIVE VIEWS, FITTED KITCHEN with built in hob/oven/extractor, GOOD SIZED BEDROOMS, FITTED WHITE BATHROOM/WC/SHOWER. Call 0191 3729898 to view..

Leasehold, 168 years left on the lease, £15 per annum ground rent  
EPC rating C  
Council tax band A

## Entrance Porch

## Living Room

15'8" x 11'2" (4.78m x 3.40m)

## Kitchen

8'8" x 6'7" (2.64m x 2.01m)

## Bathroom

## Bedroom One

12'9" x 10'8" (3.89m x 3.25m)

## Bedroom Two

9'8" x 7'6" (2.95m x 2.29m)

## Garage

## External

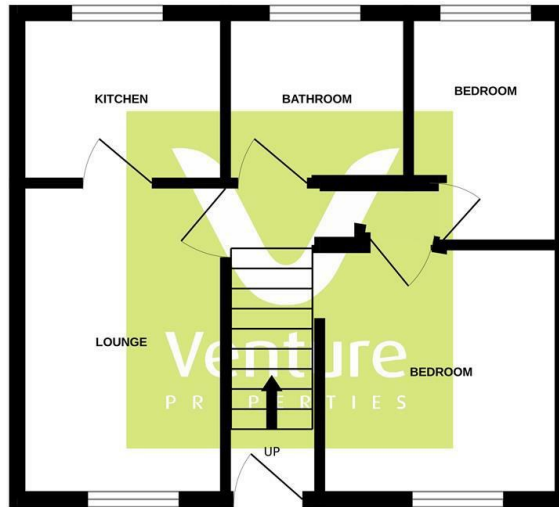

Whilst every attempt has been made to ensure the accuracy of the floorplan contained here, measurements of doors, windows, rooms and any other items are approximate and the responsibility is taken for any error, omission or misstatement. This plan is for illustrative purposes only and should be used as such by any prospective purchaser. The services, systems and appliances shown have not been tested and no guarantee as to their quantity or efficiency can be given. Made with Ventagon ©2024

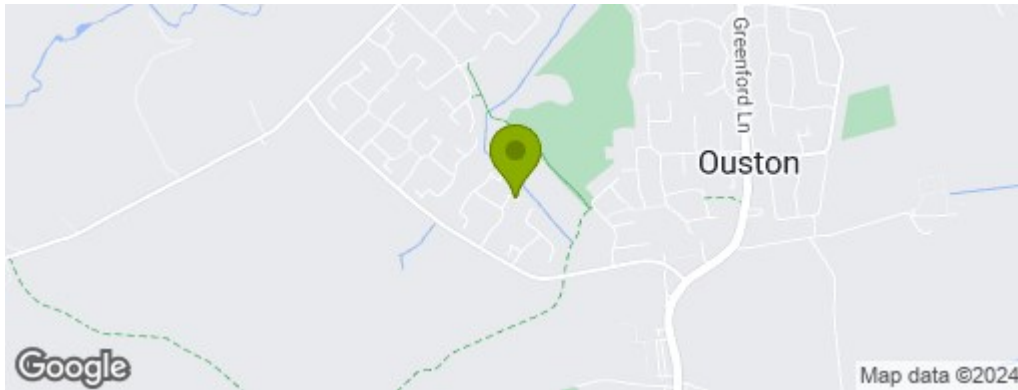

## Property Information

**0191 372 9898**

Suite 6, 15 North Burns, Chester-le-Street, County Durham, DH3 3TF  
[sales.cls@venturepropertiesuk.com](mailto:sales.cls@venturepropertiesuk.com)