



Redmires Close

Chester Le Street DH2 1SB

£245,000





This footer paragraph is an example only and should not be relied upon as complying with current legislation. These particulars, whilst believed to be accurate are set out as a general outline only for guidance and do not constitute any part of an offer or contract. Intending purchasers should not rely on them as statements of representation of fact, but must satisfy themselves by inspection or otherwise as to their accuracy. No person in this firm's employment has the authority to make or give any representation or warranty in respect of the property.

Redmires Close

Chester Le Street DH2 1SB



SOLD, SUBJECT TO CONTRACT, SIMILAR PROPERTIES REQUIRED FREEHOLD, SPACIOUS, EXTENDED FOUR BEDROOM SEMI DETACHED HOME situated in this QUIET CUL DE SAC of Redmires on the EVER POPULAR RESIDENTIAL DEVELOPMENT of Urpeth Grange, Ouston. The property offers GENEROUS QUANTITIES OF LIVING ACCOMMODATION OVER THREE RECEPTION ROOMS, REFITTED KITCHEN with built in appliances, FOUR DOUBLE BEDROOMS and a LUXURIOUSLY APPOINTED BATHROOM/SHOWER/WC. The property also has UPVC DOUBLE GLAZING, GAS CENTRAL HEATING VIA RADIATORS, OWNED SOLAR PANELS, ELECTRIC REMOTE GARAGE DOOR, MATURE GARDENS, LARGE TO THE REAR and AMPLE PARKING. CALL TO VIEW ON 0191 3729898...

EPC rating C
Council tax band C

ENTRANCE PORCH

ENTRANCE HALL

LOUNGE

15' x 11'7" (4.57m x 3.53m)

DINING ROOM

17'10" x 10'10" (5.44m x 3.30m)

CONSERVATORY

15'1" x 12'9" (4.60m x 3.89m)

KITCHEN

12'9" x 8'2" (3.89m x 2.49m)

FIRST FLOOR LANDING

MAIN BEDROOM

17'4" x 9'4" narrowing (5.28m x 2.84m narrowing)

BEDROOM 2

12'3" x 9'10" (3.73m x 3.00m)

BEDROOM 3

12' x 8'10" plus doorway (3.66m x 2.69m plus doorway)

BEDROOM 4

12' x 8'4" (3.66m x 2.54m)

BATHROOM/SHOWER/WC

OUTSIDE

GARAGE

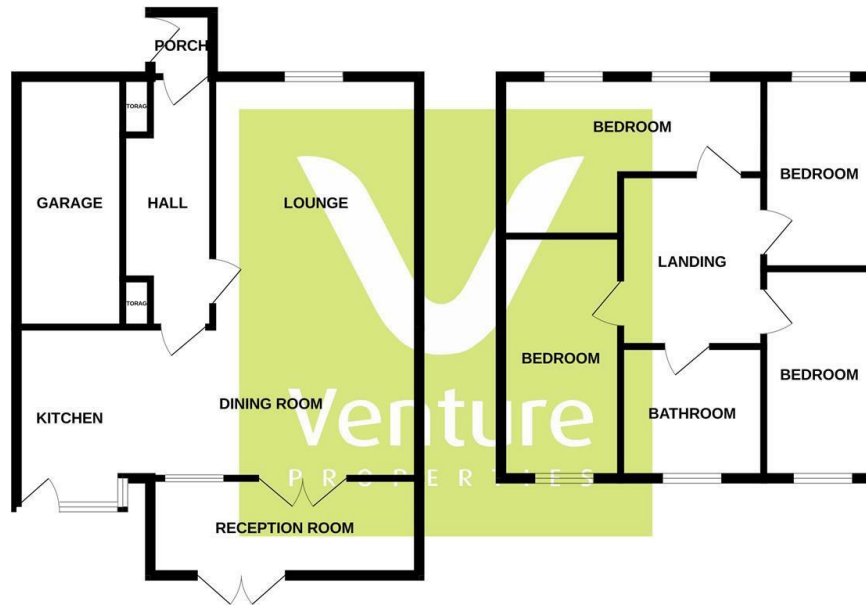

Whilst every attempt has been made to ensure the accuracy of the floorplan contained here, measurements of floors, windows, rooms and any other items are approximate and no responsibility is taken for any error, omission or mis-statement. This plan is for illustrative purposes only and should be used as such by any prospective purchaser. The services, systems and appliances shown have not been tested and no guarantee as to their operability or efficiency can be given.
Made with Metrogn ©2024.

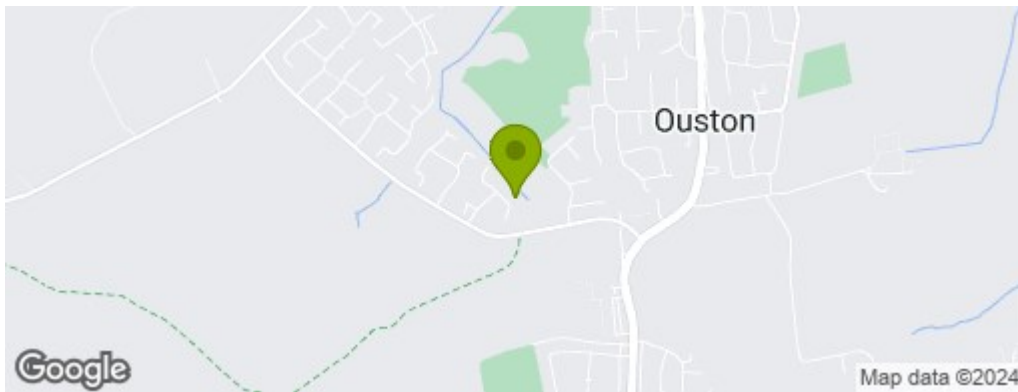

Property Information

0191 372 9898

Suite 6, 15 North Burns, Chester-le-Street, County Durham, DH3 3TF
sales.cls@venturepropertiesuk.com