

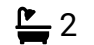

Eastern Quay Apartments, E16 1AX

£475,000

 2  2

Welcome to this exquisite two-bedroom flat on the 10th floor of Eastern Quay apartments in Royal Docks. Upon entering, you'll find a secure, modern communal entrance leading to a welcoming communal area served by two lifts for convenient access. Your 10th-floor sanctuary boasts an exclusive entrance door opening into the entrance hall.

- Private balcony
- EPC - C
- Gas central heating
- Double glazed windows
- Local amenities
- DLR within walking distance



Floor Area: 743 sq. ft.

Tenure: Leasehold

Service Charge: £ per annum

Ground Rent: £ per annum

Energy Efficiency Rating		
	Current	Potential
Very energy efficient - lower running costs		
(92 plus) A		
(81-91) B		
(69-80) C	80	82
(55-68) D		
(39-54) E		
(21-38) F		
(1-20) G		
Not energy efficient - higher running costs		
England & Wales	EU Directive 2002/91/EC	

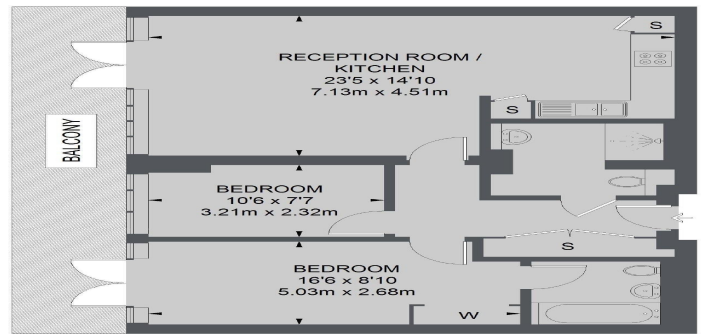

TOTAL APPROX. FLOOR AREA
777 SQ. FT. (72.14 SQ. M.)