



Gainsborough Road, London, N12

OIEO £450,000

 2 Bedrooms  1 Bathroom  1 Reception



Adam Hayes - North Finchley Office - Sales 365 Ballards Lane, North Finchley, London, N12 8LL
 Tel: 020 8445 4008 Email: info@adam-hayes.co.uk Web: www.adam-hayes.co.uk

Gainsborough Road, London, N12

Guide Price £450,000

 2 Bedrooms  1 Bathrooms  1 Receptions

Key Features

- Two bedrooms
- Ground floor conversion
- Private rear garden
- Long lease
- Rear access
- Open plan Kitchen/lounge

Other Information

Tenure: Leasehold
Length of Lease: 121 years
Ground Rent: £250 pa
Service Charge: £1400 pa
Council Tax Band: C

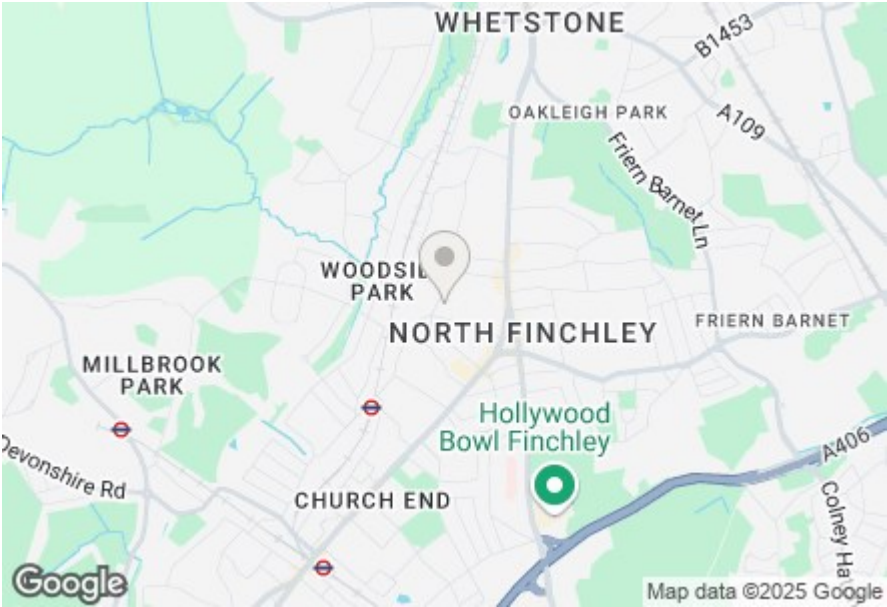

Nearest Stations

- Woodside Park Station 0.2miles
- West Finchley Station 0.5miles
- Totteridge & Whetstone Station 1.0miles

Property Description

A fantastic opportunity to acquire this two-bedroom ground floor garden flat located in the heart of North Finchley. The property boasts a wealth of natural light throughout and offers a generously sized open-plan kitchen/lounge which has retained attractive period features, two spacious bedrooms, a three-piece bathroom suite and a utility space providing direct access to private rear garden. The property is within close proximity to an array of local schools, amenities and transport links to include Woodside Park underground station and North Finchley High Street. Further benefits include double glazing throughout and rear access. Please contact us to arrange your viewing.

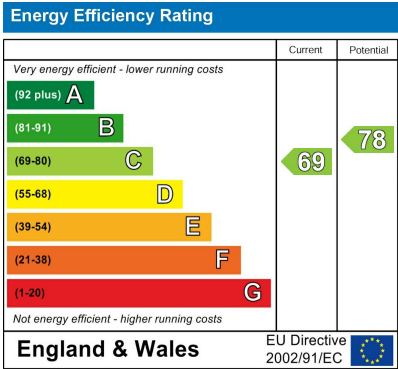

Approximate Gross Internal Area
636 sq ft - 59 sq m

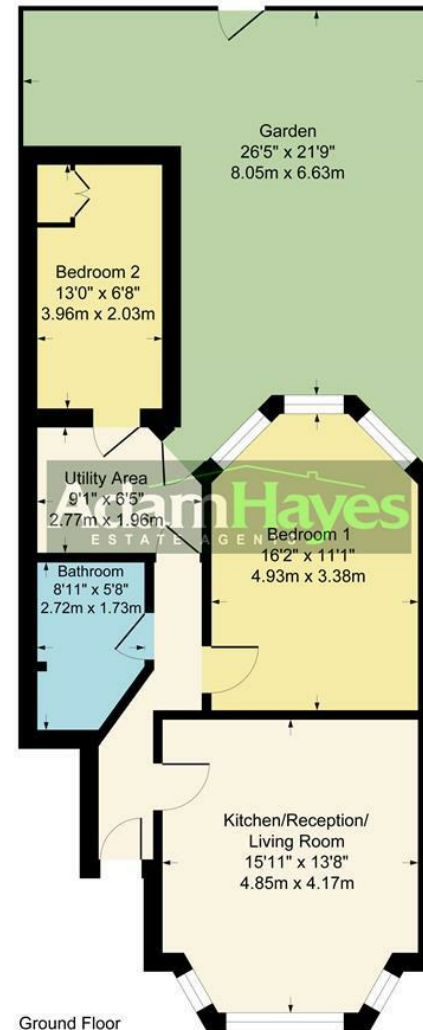

Ground Floor

Although every attempt has been made to ensure accuracy, all measurements are approximate.
This floorplan is for illustrative purposes only and not to scale.
Measured in accordance with RICS Standards.

These particulars, whilst believed to be accurate, are set out as a general outline only for guidance and do not constitute any part of an offer or contract. Intending purchasers or prospective tenants should not rely on them as statements or representation of fact, but must satisfy themselves by inspection or otherwise as to their accuracy. We have not carried out a detailed survey, not tested the services, appliances and specific fittings. Room sizes should not be relied upon for carpets and furnishings. The measurements given are approximate. No person in this firm's employment has the authority to make or give any representation or warranty in respect of the property.