

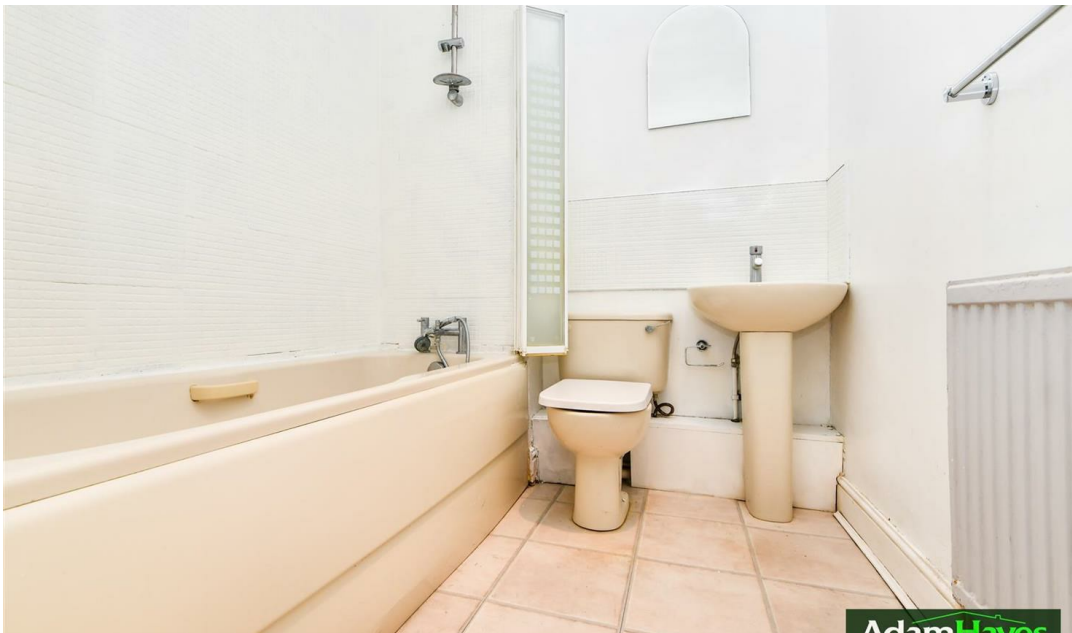

Bow Lane, North Finchley, N12

1 Bedroom 1 Bathroom 1 Reception

OIEO £325,000



Adam Hayes - North Finchley Office - Sales 365 Ballards Lane, North Finchley, London, N12 8LL
Tel: 020 8445 4008 Email: info@adam-hayes.co.uk Web: www.adam-hayes.co.uk

Bow Lane, North Finchley, N12

OIEO £325,000

1 Bedrooms 1 Bathrooms 1 Receptions

Key Features

- One Bedroom
- Duplex Apartment
- Modern Kitchen
- Off Street Parking
- Communal Gardens
- Chain Free

Other Information

Tenure: Leasehold
Length of Lease: 88 Years
Ground Rent: N/A
Service Charge: £1,788.00 P/A
Council Tax Band: C

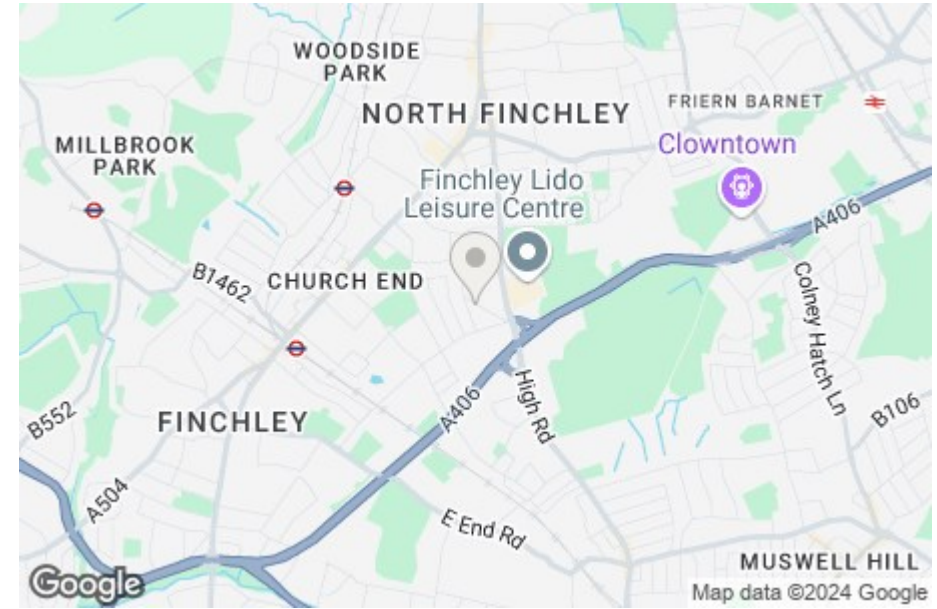

Nearest Stations

Finchley Central Station 0.6 miles
West Finchley Station 0.6 miles
Woodside Park Station 1.0 miles

Property Description

Located on a tree-lined street with easy access to local shops and amenities is this one-bedroom duplex apartment spanning the ground and first floors. The property is offered chain free and benefits from an approximately 16ft reception, a modern fitted kitchen, off-street parking for one car and use of communal gardens. This property offers an excellent opportunity for First Time Buyers or Buy to Let Investors as its offered with no onwads chain. To fully appreciate the size, condition, and location, an internal viewing is highly recommended through the vendor's sole agents, Adam Hayes Estate Agents.

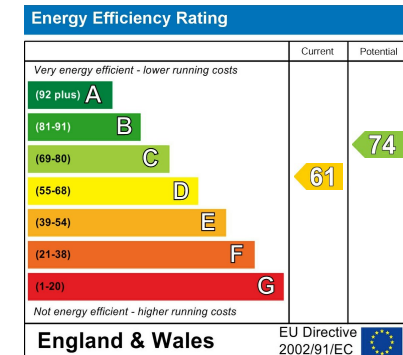

Adam Hayes - North Finchley Office - Sales 365 Ballards Lane, North Finchley, London, N12 8LL

Tel: 020 8445 4008 Email: info@adam-hayes.co.uk Web: www.adam-hayes.co.uk

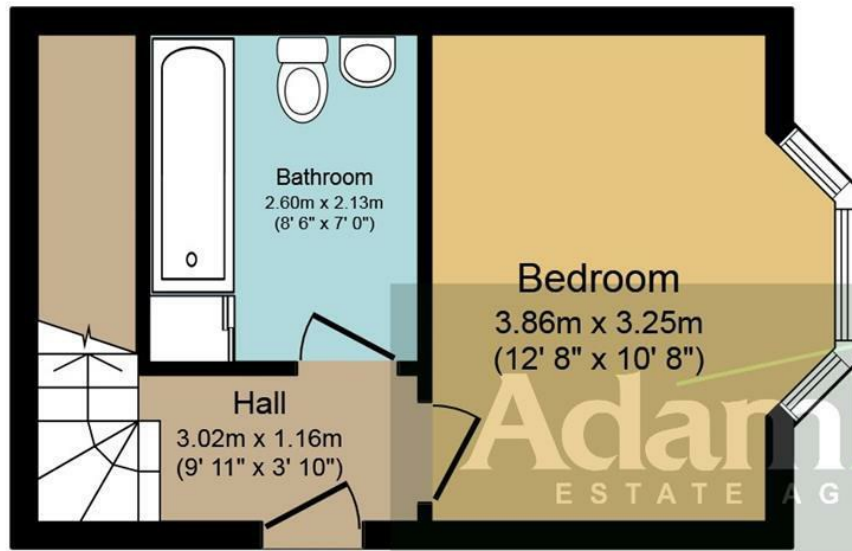

Ground Floor

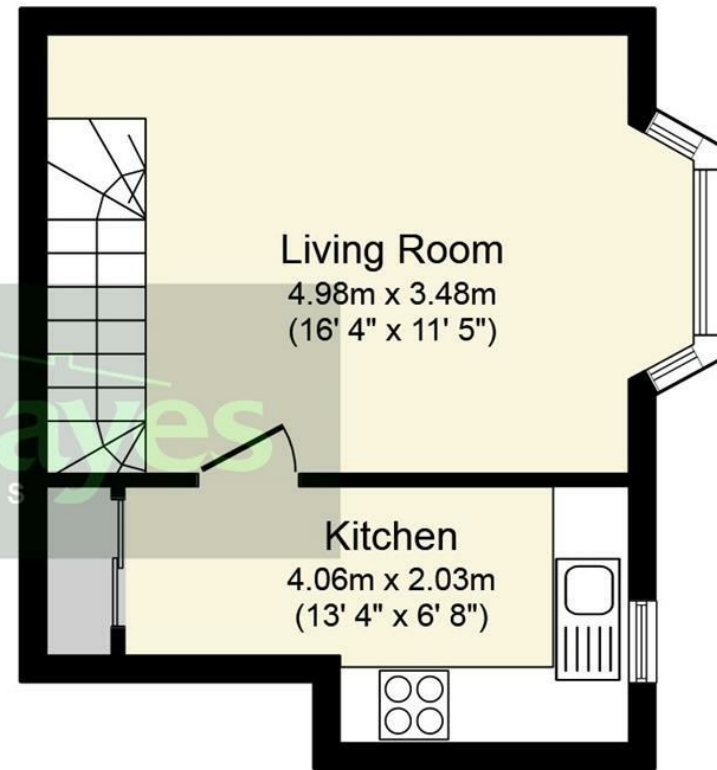

First Floor

Total floor area 48.4 sq. m. (521 sq. ft.) approx

This plan is for illustration purposes only and may not be representative of the property. Plan not to scale.

These particulars, whilst believed to be accurate, are set out as a general outline only for guidance and do not constitute any part of an offer or contract. Intending purchasers or prospective tenants should not rely on them as statements or representation of fact, but must satisfy themselves by inspection or otherwise as to their accuracy. We have not carried out a detailed survey, not tested the services, appliances and specific fittings. Room sizes should not be relied upon for carpets and furnishings. The measurements given are approximate. No person in this firm's employment has the authority to make or give any representation or warranty in respect of the property.