



Mays Lane, Barnet, EN5 2DY

 3  1  1

£2,000 PCM





Adam Hayes - North Finchley Office - Lettings 365 Ballards Lane, North Finchley, London, N12 8LL

Tel: 020 8445 4008 Email: info@adam-hayes.co.uk Web: www.adam-hayes.co.uk

Mays Lane, Barnet, EN5 2DY

£2,000 PCM

 3 Bedrooms  1 Bathrooms  1 Receptions

Key Features

- Three Bedroom House
- 15ft Lounge
- Separate Kitchen
- Wooden Flooring
- Close to Tube and Shops
- Garden
- Pet Friendly

Nearest Stations

- High Barnet

Property Description

PET FRIENDLY - A three bedroom family house situated within easy access of High Barnet Tube Station (Northern Line) and multiple shops and amenities. The property benefits from a 15ft lounge, a separate modern kitchen, wooden flooring, gas central heating and a rear private garden. Offered unfurnished. Early viewings highly recommended!

Other Information

Council Tax Band: D

Length of Tenancy: Long Let

Deposit: £2,300

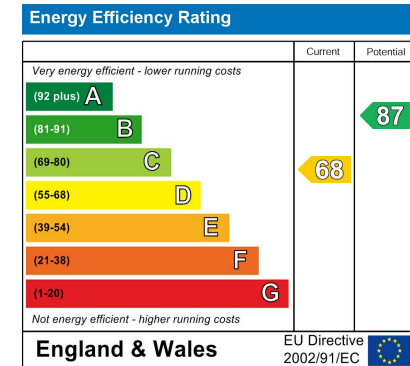

Adam Hayes - North Finchley Office - Lettings 365 Ballards Lane, North Finchley, London, N12 8LL

Tel: 020 8445 4008 Email: info@adam-hayes.co.uk Web: www.adam-hayes.co.uk

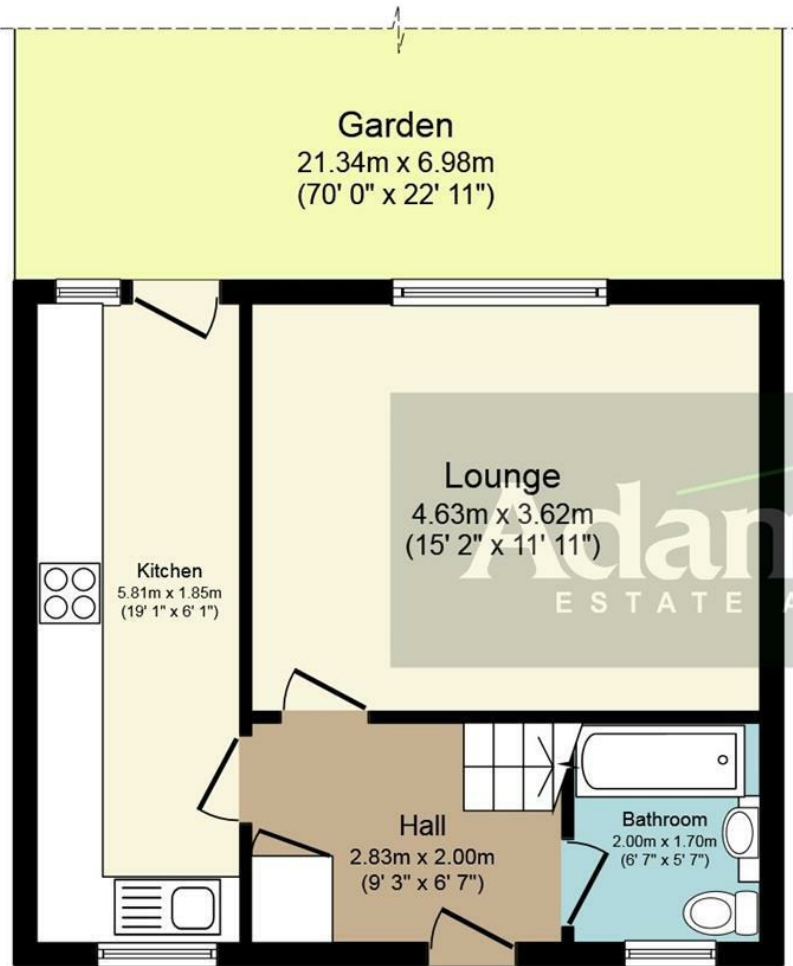

Ground Floor

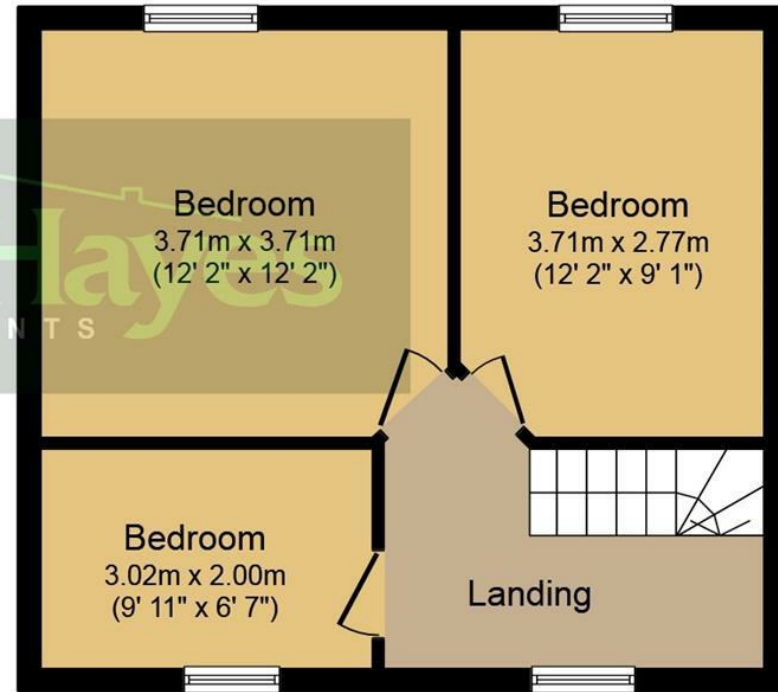

First Floor

Total floor area 76.0 sq. m. (818 sq. ft.) approx

This plan is for illustration purposes only and may not be representative of the property. Plan not to scale.

These particulars, whilst believed to be accurate, are set out as a general outline only for guidance and do not constitute any part of an offer or contract. Intending purchasers or prospective tenants should not rely on them as statements or representation of fact, but must satisfy themselves by inspection or otherwise as to their accuracy. We have not carried out a detailed survey, not tested the services, appliances and specific fittings. Room sizes should not be relied upon for carpets and furnishings. The measurements given are approximate. No person in this firm's employment has the authority to make or give any representation or warranty in respect of the property.