







Adam Hayes - North Finchley Office - Lettings 365 Ballards Lane, North Finchley, London, N12 8LL

Tel: 020 8445 4008 Email: info@adam-hayes.co.uk Web: www.adam-hayes.co.uk

Swan Lane, Whetstone, N20 0PL

£2,200 PCM

 3 Bedrooms  1 Bathrooms  1 Receptions

Key Features

- Three Bedroom Family House
- Spacious Reception
- Modern Kitchen
- Modern Bathroom
- Guest WC
- Garden
- Communal Parking

Other Information

Council Tax Band: D
Length of Tenancy: Long Let
Deposit: £2,535

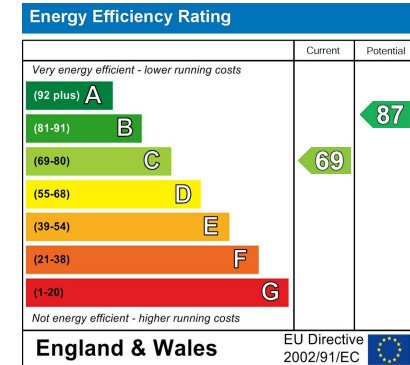

Nearest Stations

- Totteridge & Whetstone

Property Description

Discover this charming three-bedroom end-of-terrace house, ideally situated for easy access to local schools, Totteridge and Whetstone Tube Station (Northern Line), and various amenities. This delightful property features a spacious 29ft reception area that opens onto a sleek, modern open-plan kitchen. Additional highlights include a guest WC, a contemporary family bathroom, ample storage, a lovely private rear garden, and communal parking. Internal viewings are highly recommended through the landlord's sole agent, Adam Hayes Estate Agents.

Adam Hayes - North Finchley Office - Lettings 365 Ballards Lane, North Finchley, London, N12 8LL

Tel: 020 8445 4008 Email: info@adam-hayes.co.uk Web: www.adam-hayes.co.uk

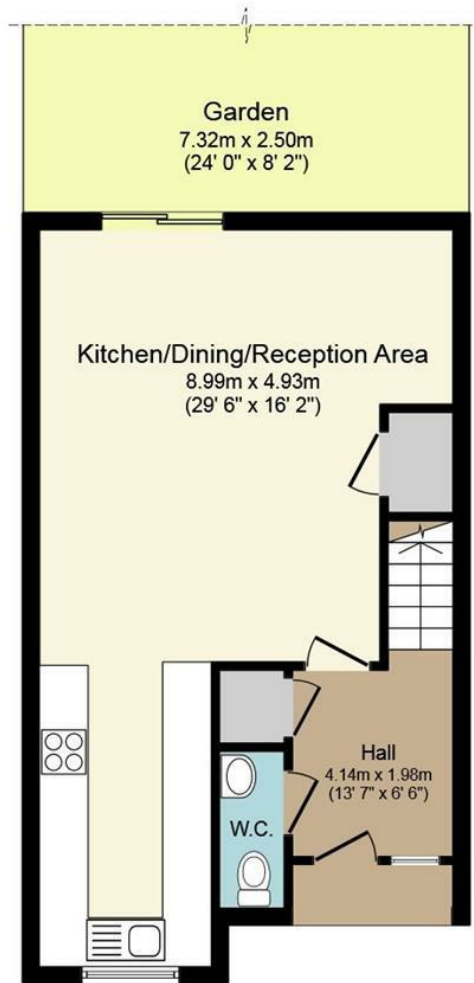

Ground Floor

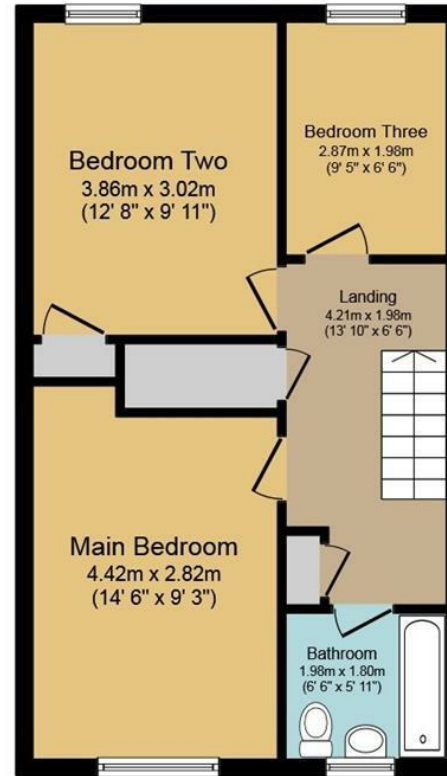

First Floor

Total floor area (969 sq. ft.) approx

This plan is for illustration purposes only and may not be representative of the property. Plan not to scale.

These particulars, whilst believed to be accurate, are set out as a general outline only for guidance and do not constitute any part of an offer or contract. Intending purchasers or prospective tenants should not rely on them as statements or representation of fact, but must satisfy themselves by inspection or otherwise as to their accuracy. We have not carried out a detailed survey, not tested the services, appliances and specific fittings. Room sizes should not be relied upon for carpets and furnishings. The measurements given are approximate. No person in this firm's employment has the authority to make or give any representation or warranty in respect of the property.