







Adam Hayes - North Finchley Office - Lettings 365 Ballards Lane, North Finchley, London, N12 8LL

Tel: 020 8445 4008 Email: info@adam-hayes.co.uk Web: www.adam-hayes.co.uk

Ballards Lane, North Finchley, N12 8LJ

£1,700 PCM

 2 Bedrooms  1 Bathrooms  1 Receptions

Key Features

- Two Bedroom Second Floor Flat
- Great Location
- Modern Kitchen
- Approx. 16ft Lounge
- Laminate Wooden Flooring
- Close To Tube And Shops

Nearest Stations

- Woodside Park
- West Finchley

Property Description

Experience the charm of this delightful two-bedroom second-floor flat, nestled above a commercial premises in the vibrant heart of North Finchley. Just moments away from an array of shops, cafes, restaurants, and local conveniences, this property offers a prime location. Step inside to discover a modern fitted kitchen and bathroom and a spacious approximately 16ft lounge. The property also boasts double glazing, gas central heating and has laminated wooden flooring. Supermarkets such as Aldi and Waitrose are nearby, along with PureGym and the North Finchley Bus Depot within easy reach. Early viewings are highly recommended via sole agents Adam Hayes Estate Agents.

Other Information

Council Tax Band: C
Length of Tenancy: Long Let
Deposit: £1,960

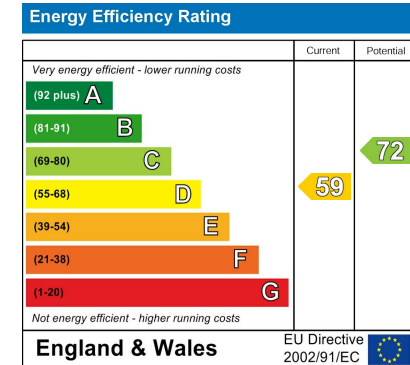

Adam Hayes - North Finchley Office - Lettings 365 Ballards Lane, North Finchley, London, N12 8LL

Tel: 020 8445 4008 Email: info@adam-hayes.co.uk Web: www.adam-hayes.co.uk

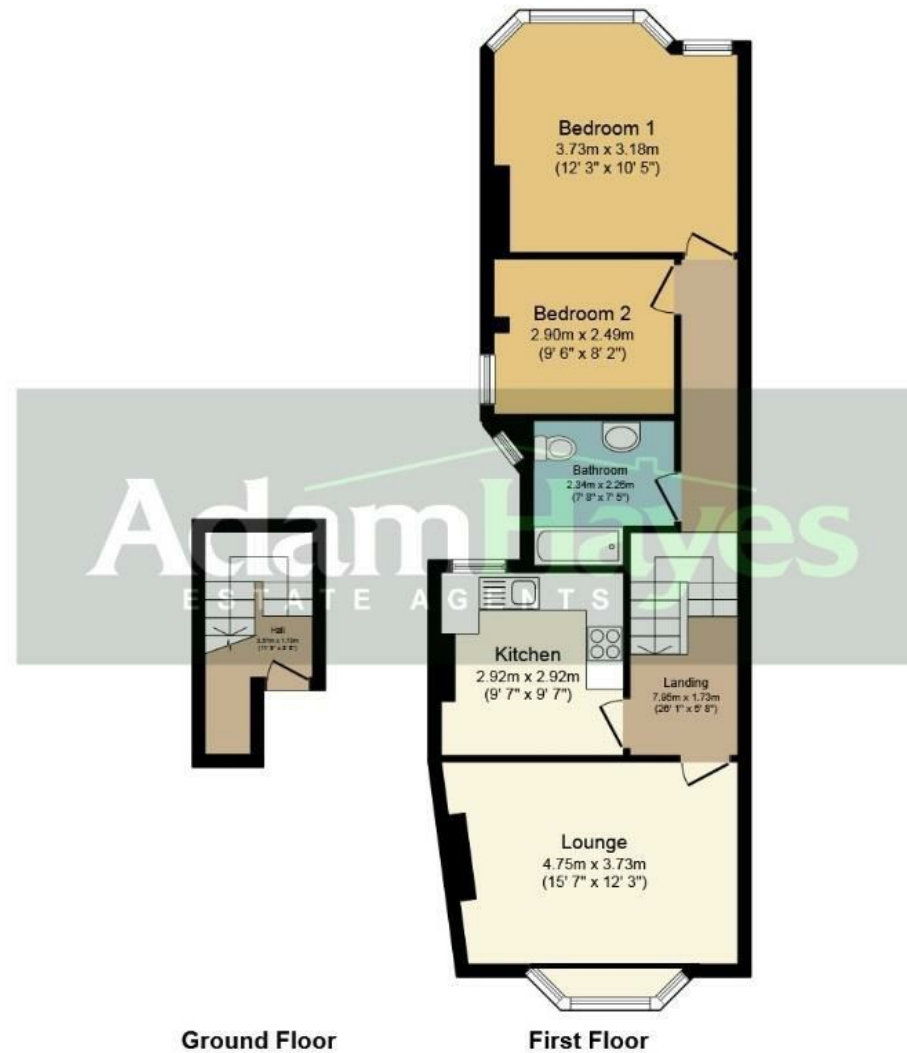

Total floor area 67.0 sq. m. (721 sq. ft.) approx

This plan is for illustration purposes only and may not be representative of the property. Plan not to scale.

These particulars, whilst believed to be accurate, are set out as a general outline only for guidance and do not constitute any part of an offer or contract. Intending purchasers or prospective tenants should not rely on them as statements or representation of fact, but must satisfy themselves by inspection or otherwise as to their accuracy. We have not carried out a detailed survey, not tested the services, appliances and specific fittings. Room sizes should not be relied upon for carpets and furnishings. The measurements given are approximate. No person in this firm's employment has the authority to make or give any representation or warranty in respect of the property.