



Torrington Park, North Finchley, N12 9PN

£1,800 PCM

 2  1  1



Adam Hayes - North Finchley Office - Lettings 365 Ballards Lane, North Finchley, London, N12 8LL

Tel: 020 8445 4008 Email: info@adam-hayes.co.uk Web: www.adam-hayes.co.uk

Torrington Park, North Finchley, N12 9PN

£1,800 PCM

 2 Bedrooms  1 Bathrooms  1 Receptions

Key Features

- Beautiful Two Bedroom Flat
- 2nd Floor Purpose Built Block
- Communal Parking
- Separate WC
- Modern Kitchen and Bathroom
- Close To Tube and Shops

Other Information

Council Tax Band: D
Length of Tenancy: Long Let
Deposit: £2,075

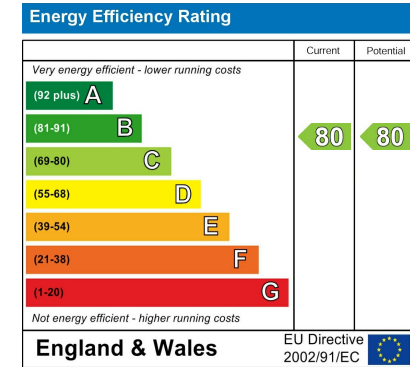

Nearest Stations

- Woodside Park Station 0.7 miles
- West Finchley Station 1.0 miles
- Totteridge & Whetstone Station 1.1 miles

Property Description

A beautiful two bedroom apartment set on the second floor of this modern development situated within easy access of Woodside Park Tube Station (Northern Line) and local amenities. The property is in excellent condition and benefits from an approx 20ft lounge, a modern fitted kitchen, a modern bathroom, double glazing and communal parking on a first come first serve basis. To really appreciate the size and location, an internal viewing is highly recommended via Adam Hayes Estate Agents.

Adam Hayes - North Finchley Office - Lettings 365 Ballards Lane, North Finchley, London, N12 8LL

Tel: 020 8445 4008 Email: info@adam-hayes.co.uk Web: www.adam-hayes.co.uk

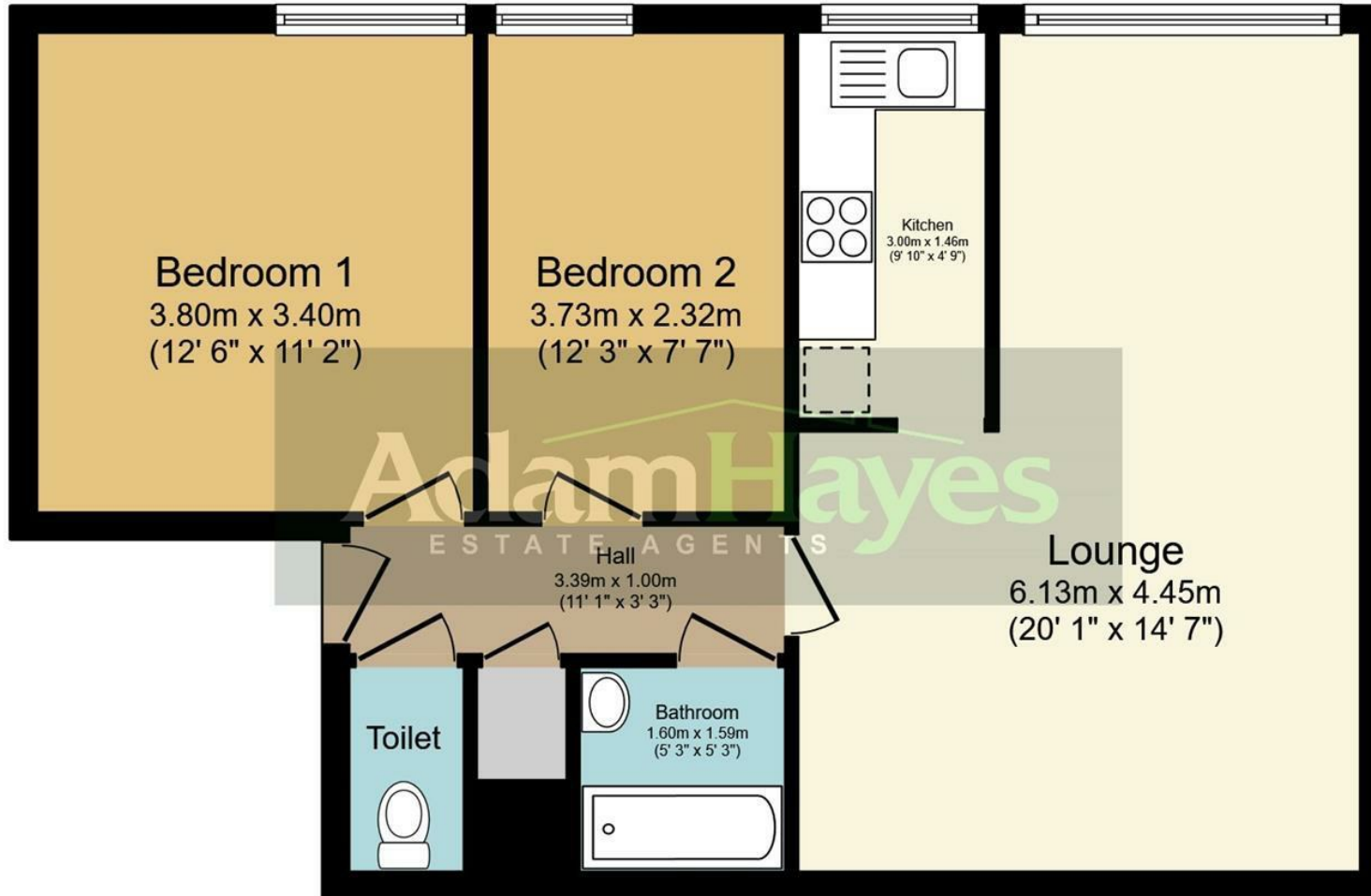

Floor Plan

Total floor area 60.3 sq.m. (649 sq.ft.) approx

This plan is for illustration purposes only and may not be representative of the property. Plan not to scale.

These particulars, whilst believed to be accurate, are set out as a general outline only for guidance and do not constitute any part of an offer or contract. Intending purchasers or prospective tenants should not rely on them as statements or representation of fact, but must satisfy themselves by inspection or otherwise as to their accuracy. We have not carried out a detailed survey, not tested the services, appliances and specific fittings. Room sizes should not be relied upon for carpets and furnishings. The measurements given are approximate. No person in this firm's employment has the authority to make or give any representation or warranty in respect of the property.