



Kingsway, North Finchley, N12

 2 Bedrooms  2 Bathrooms  1 Reception

**Adan**  
ESTATE AGENTS

The Property  
Ombudsman

OIEO £325,000



Adam Hayes - North Finchley Office - Sales 365 Ballards Lane, North Finchley, London, N12 8LL

Tel: 020 8445 4008 Email: [info@adam-hayes.co.uk](mailto:info@adam-hayes.co.uk) Web: [www.adam-hayes.co.uk](http://www.adam-hayes.co.uk)

Kingsway, North Finchley, N12

OIEO £325,000

2 Bedrooms 2 Bathrooms 1 Receptions

### Key Features

- Two Bedrooms
- Two Bathrooms
- Seventh Floor
- Chain Free
- Balcony
- Underground Parking

### Other Information

Tenure: Leasehold  
Length of Lease: 103 Years  
Ground Rent: £100.00 P/A  
Service Charge: £5,749.48 P/A  
Council Tax Band: D

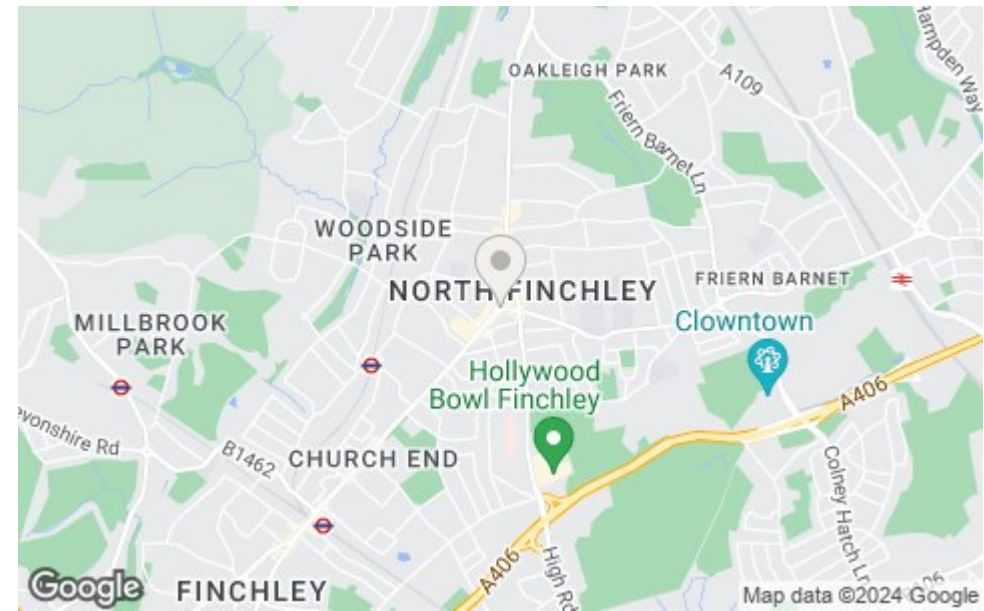

### Nearest Stations

Woodside Park Station 0.5 miles  
West Finchley Station 0.5 miles  
Finchley Central Station 1.0 miles

### Property Description

Situated in this popular lift serviced block in the heart of Tally Ho North Finchley, is well presented two bedroom, two bathroom (one en-suite shower) seventh floor luxury apartment. The property is offered chain free and benefits from a 24 hour concierge, an approximately 16ft reception with a modern open plan kitchen with integrated appliances, spectacular panoramic views overlooking London and underground parking. Early viewings highly recommended via the vendors sole agents Adam Hayes Estate Agents.

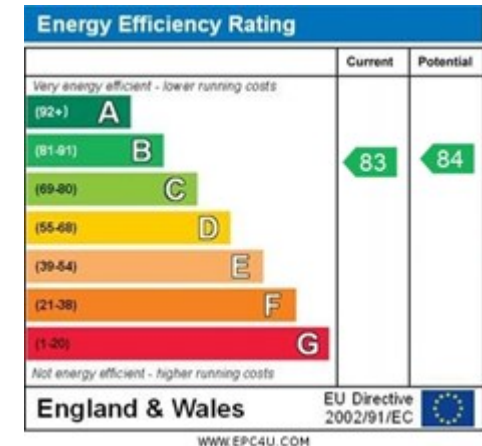

Adam Hayes - North Finchley Office - Sales 365 Ballards Lane, North Finchley, London, N12 8LL

Tel: 020 8445 4008 Email: info@adam-hayes.co.uk Web: www.adam-hayes.co.uk

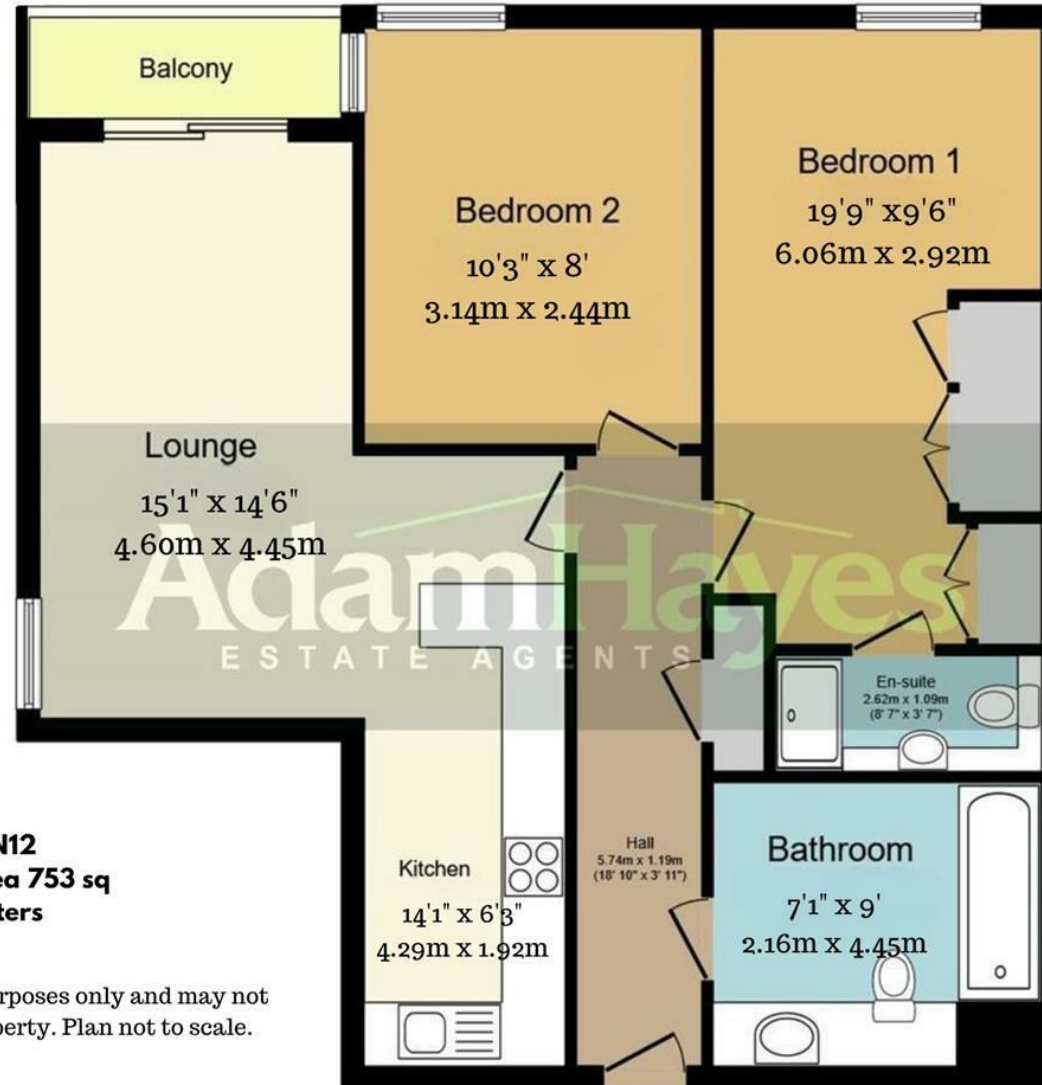

**Kingsway, N12**  
**Gross Internal Area 753 sq**  
**ft/ 70 sq meters**

This plan is for illustration purposes only and may not be representative of the property. Plan not to scale.

## Floor Plan

These particulars, whilst believed to be accurate, are set out as a general outline only for guidance and do not constitute any part of an offer or contract. Intending purchasers or prospective tenants should not rely on them as statements or representation of fact, but must satisfy themselves by inspection or otherwise as to their accuracy. We have not carried out a detailed survey, not tested the services, appliances and specific fittings. Room sizes should not be relied upon for carpets and furnishings. The measurements given are approximate. No person in this firm's employment has the authority to make or give any representation or warranty in respect of the property.