



Flat 1 34 Massey Road, Gloucester, Gloucestershire, GL1 4LQ

£750 PCM

TO LET

CHOSEN  
ESTATE AGENTS

- SITTING ROOM/KITCHEN
- SHOWER ROOM
- CENTRAL HEATING
- EPC B
- DOUBLE BEDROOM
- COURTYARD GARDEN
- DOUBLE-GLAZED
- COUNCIL TAX BAND A

## THE PROPERTY

Chosen Estate Agents have a fantastic opportunity to rent this ground floor one bedroom apartment with courtyard garden.

The property offers an open plan kitchen/sitting room, double bedroom and shower room. It also benefits from double-glazing and is warmed by gas-fired central heating.

Parking is on road. Sorry no pets.

Holding Deposit: £173.00 based on 1 weeks' rent of asking price

Security Deposit: £865.00 based on 5 weeks' rent of asking price

Council Tax band: A Local Authority: Tewkesbury Borough

EPC Band: B

Electricity supply: Mains Gas Supply: Mains Water supply: Mains

Sewerage: Mains

Heating: Gas Heating Mobile phone coverage: i.e. EE, Vodafone, Three, O2

If satisfactory references are not obtained or you withdraw your application any financial loss to Chosen Estate Agents or the Landlord will be deducted from your holding deposit. If you or your guarantor provides information that is inaccurate, false, incomplete, or adverse credit not being disclosed then we may retain your holding deposit and reject your application.

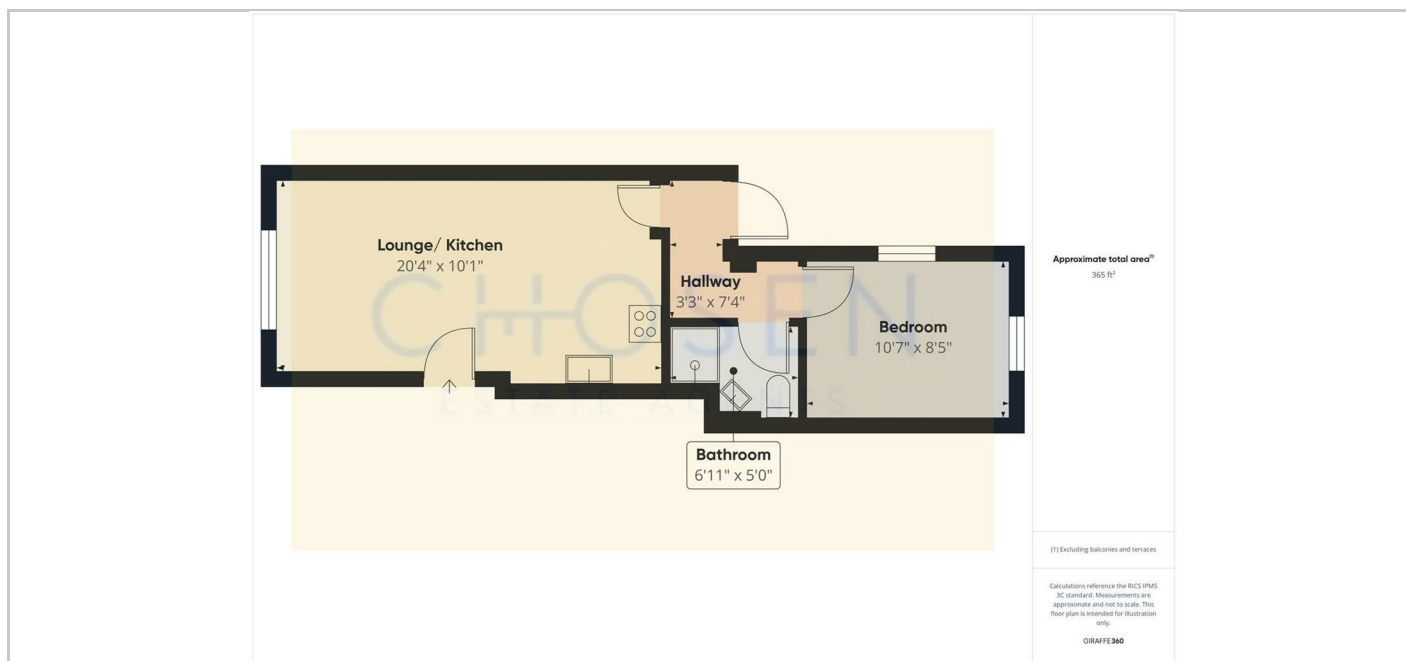

## SITUATION

## Directions

2 Church Road, Churchdown, Gloucestershire, GL3 2ER

Tel: 01452 857421 Email: [info@chosenestateagents.co.uk](mailto:info@chosenestateagents.co.uk) [www.chosenestateagents.co.uk](http://www.chosenestateagents.co.uk)