



39 Raleigh Close, Churchdown, GL3 1NT

£230,000

CHOSEN
ESTATE AGENTS

THE PROPERTY

Nestled in the charming Raleigh Close, of Churchdown, this delightful two-bedroom end terrace home is a perfect gem waiting to be discovered.

As you step inside, you are greeted by a welcoming living room, ideal for relaxing or entertaining guests. The light and airy kitchen boasts sliding doors to the rear garden.

The property features two double bedrooms, perfect for a small family or as a peaceful workspace.

The modern bathroom provides convenience and comfort for your daily routines, comprising a bath with shower over, low level WC, wash hand basin and heated towel rail.

Externally this lovely home offers a driveway that can accommodate two vehicles, ensuring parking is never a hassle. The enclosed rear garden provides a private outdoor space, perfect for enjoying a morning coffee or hosting summer barbecues.

Whether you are looking for your first home or an investment opportunity, this property ticks all the boxes. Get in touch to arrange your viewing!

Agents Note.

Freehold.

EPC Rating: D64

Tewkesbury Borough Council Band: B

Mains Gas, Electric and Water are connected.

Fibre Broadband is available in the area

- Two Bedroom End Terrace Home
- Enclosed Rear Garden
- Perfect First Time Purchase/Buy To Let Investment
- Council Tax Band: B
- Cul-de-Sac Location
- Driveway Providing Two Off Road Parking Spaces
- Modern Bathroom
- EPC Rating: D64

Energy Efficiency Rating

	Current	Potential
<i>Very energy efficient - lower running costs</i>		
(92 plus) A		
(81-91) B		88
(69-80) C		
(55-68) D	64	
(39-54) E		
(21-38) F		
(1-20) G		
<i>Not energy efficient - higher running costs</i>		
England & Wales	EU Directive 2002/91/EC	



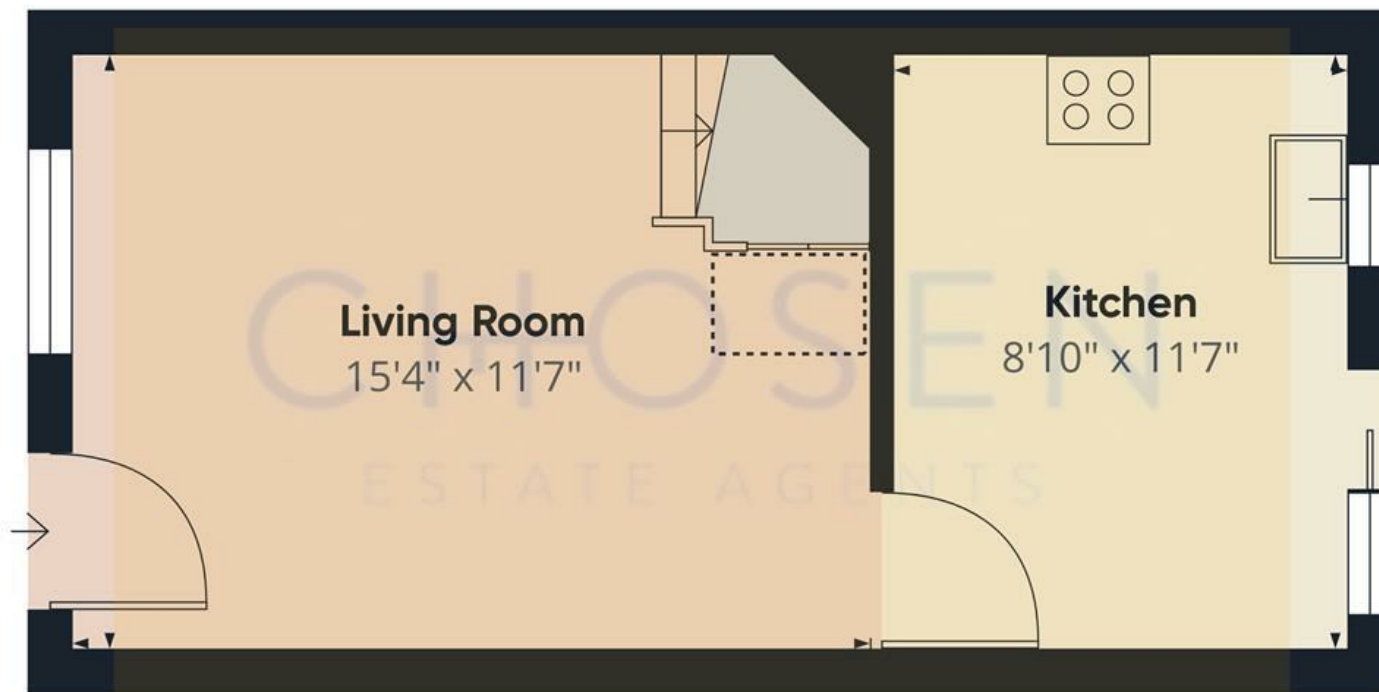

Floor 0

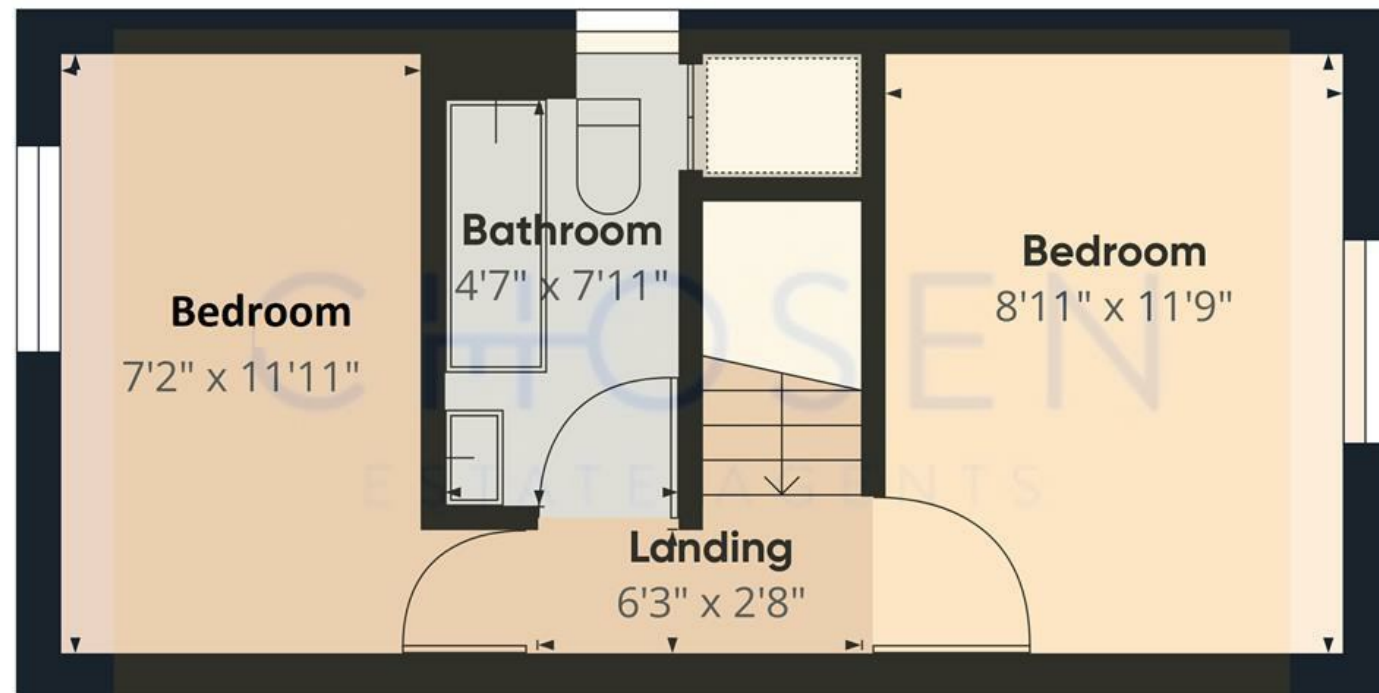

Floor 1

Approximate total area⁽¹⁾

544.31 ft²

Reduced headroom

6.26 ft²

(1) Excluding balconies and terraces

⌊ Reduced headroom
(below 1.5m/4.92ft)

While every attempt has been made to ensure accuracy, all measurements are approximate, not to scale. This floor plan is for illustrative purposes only.

GIRAFFE360