



West View, Ackworth, Pontefract

£525,000



West View, Ackworth, Pontefract

House

4 Bedrooms, 2 Bathroom

£525,000

- IMPRESSIVE INDIVIDUALLY BUILT RESIDENCE STANDING IN APPROX. 1/3 ACRE OF PRIVATE GROUNDS
- VERSATILE ACCOMMODATION TO CREATE YOUR IDEAL HOME
- FABULOUS HOME FOR ENTERTAINING
- CLOSE PROXIMITY TO RENOWNED ACKWORTH QUAKER SCHOOL
- OPEN FIELDS & COUNTRYSIDE NEARBY. IDEAL FOR KEEP FIT ENTHUSIASTS/DOG WALKERS
- WELL REGARDED PUBS & EATERIES WITHIN WALKING DISTANCE
- CENTRAL FOR MAJOR NORTHERN TOWNS & CITIES
- IDEAL FOR THE COMMUTER COMING HOME TO A VILLAGE LIFESTYLE
- WELL SERVED BY LOCAL AMENITIES & SUPERMARKET
- COUNCIL TAX BAND F

Welcome to this impressive family residence offering versatile expansive living accommodation. This substantial four-bedroom property is a dream home in waiting and invites you to an internal inspection. From the stunning grounds surrounding it to the impressive grand reception hall, this family home is ready to create your perfect home with space that works for the individual and make beautiful memories moving into your next chapter.

There are decorative substantial wrought iron double gates opening to extensive private grounds including an expansive Courtyard to allow for multiple vehicle parking and access to the detached double garage. There are partially tree lined landscaped wrap around gardens providing a high degree of privacy, including lawns and a choice of patio areas being ideal for outdoor entertaining.



Reception Hall

Classic timber double doors to the front aspect open to this statement reception hall, having a useful storage cupboard for coats and shoes, decorative spindle turnaround staircase leading to first floor, internal doors giving access to the kitchen, lounge, and further private hallway providing access to ground floor bedrooms and en-suite. Central heating radiator.

Cloaks/WC

Having a low flush WC, pedestal hand wash basin, chrome central heating towel radiator, and a frosted double-glazed window to front elevation.

Kitchen

Having a comprehensive range of wall, base, and drawer units, integrated double oven, gas hob with stainless steel cooker hood. There are roll edge laminate work surfaces incorporating a stainless steel sink and drainer. There are two double-glazed windows to the front aspect and a central heating radiator.

Lounge/Dining Room

This extremely spacious split level living area has double-glazed patio doors leading out to the beautifully landscaped garden, a double-glazed window to the rear elevation, a fireplace, and three central heating radiators.

Utility

This large utility room is fitted with wall and base units, stainless steel sink and drainer, plumbing for washing machine, wall mounted central heating boiler, central heating radiator, double-glazed window to side elevation, and double-glazed stable door to the front aspect.

Private Inner Hallway

Providing private access the the Master Bedroom and Bedroom Two.

Master Bedroom (Ground Floor)

This Master suite is a very large double bedroom with fitted furniture, central heating radiator, two double-glazed windows to rear elevation, and a luxury en-suite.



En-suite

A particularly spacious, fully tiled bathroom with corner bath, low flush WC, vanity hand wash basin unit and separate shower. Frosted double-glazed window to side elevation and towel radiator.

Bedroom Two (Ground Floor)

This second double bedroom has fitted furniture including a wardrobe. Double-glazed window to side elevation and central heating radiator.

First Floor Landing

Games/Entertainment Room

Open plan games room with built-in bar area, three central heating radiators, two double-glazed windows to the rear elevation, and one to the front elevation. Large double-glazed patio doors lead out onto the feature balcony with wrought iron balustrade looking over the side garden.

House Bathroom

A fully tiled bathroom comprising bath with shower over, pedestal hand wash basin, WC, useful storage, central heating radiator. Frosted double-glazed window to front elevation.

Private Inner Hallway

Giving access to two further double bedrooms. Decorative wrought iron staircase leading to the attic room.

Bedroom Three

A large double bedroom simply flooded with natural light, having a central heating radiator, two double-glazed windows to the side and rear elevation.

Bedroom Four

Another spacious and naturally light double bedroom, having fitted wardrobes, central heating radiator, and double-glazed window to front and side elevation

Attic Room

Accessed via a spiral staircase, this particularly versatile space has double-glazed windows to both side elevations, pitched ceiling, laminate flooring and storage into the eaves.

Outside

The property stands in approximately 1/3 acre and is accessed via double or pedestrian decorative wrought iron gates. Open courtyard providing ample off street parking for several vehicles and leading to a brick built double detached garage, with apex roof and power and light. Potting shed attached to the rear with separate access. The landscaped wrap around gardens which are enclosed and private in nature are ideal for children to play, dogs, and offer a choice of patios and seating areas ideal for outdoor entertaining, or simply relaxing on long summer days.

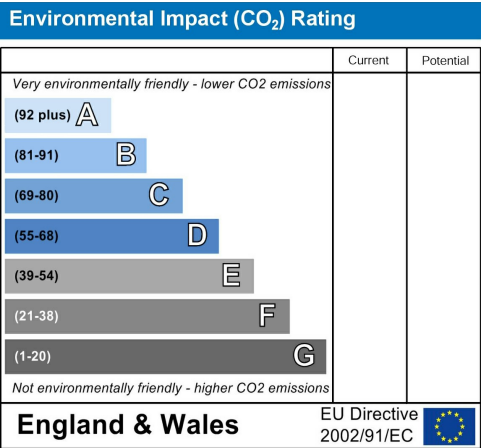
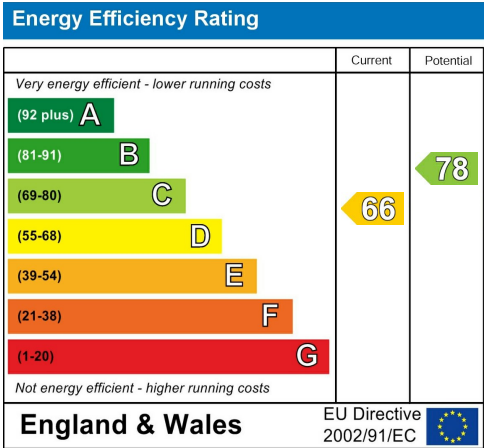





Floor 1



Floor 2

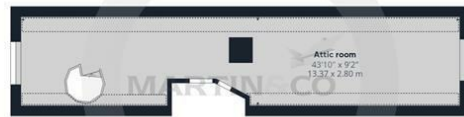

Floor 3



Approximate total area⁽¹⁾

2722.22 ft²
252.9 m²

Reduced headroom

267.84 ft²
24.88 m²

(1) Excluding balconies and terraces

⌄ Reduced headroom
(below 1.5m/4.92ft)

While every attempt has been made to ensure accuracy, all measurements are approximate, not to scale. This floor plan is for illustrative purposes only.

GIRAFFE360

Martin & Co Pontefract Sales
5 Cornmarket, Pontefract, West Yorkshire, WF8 1AN
01977 799550 . pontefract@martinco.com

01977 799550
<http://www.martinco.com>



Accuracy: References to the Tenure of a Property are based on information supplied by the Seller. The Agent has not had sight of the title documents. A Buyer is advised to obtain verification from their Solicitor. Items shown in photographs including but not limited to carpets, fixtures and fittings are not included unless specifically mentioned within the sales particulars. They may however be available by separate negotiation. Buyers must check the availability of any property and make an appointment to view before embarking on any journey to see a property. No person in the employment of the agent has any authority to make any representation about the property, and accordingly any information given is entirely without responsibility on the part of the agents, sellers(s) or lessors(s). Any property particulars are not an offer or contract, nor form part of one. **Sonic / laser Tape:** Measurements taken using a sonic / laser tape measure may be subject to a small margin of error. **All**

Measurements: All Measurements are Approximate. **Services Not tested:** The Agent has not tested any apparatus, equipment, Fixtures and Fittings or services and so cannot verify that they are in working order or fit for the purpose. A Buyer is advised to obtain verification from their Solicitor or Surveyor.

