



£1,300 pcm

Harbourne Gardens, Chartwell Green, West End



 2
Bedrooms

 1
Bathroom

32 Bridge Rd, Park Gate, Southampton SO31 7GF |
hello@chimneypotsestateagents.co.uk

01489 584 298



£1,300 pcm

Harbourne Gardens, Chartwell Green, West End



Tucked away in a peaceful cul-de-sac, this beautifully presented two-bedroom home is ready for you to move straight in. Freshly decorated throughout, it offers a bright and contemporary feel with a spacious living room, a well-equipped fitted kitchen/breakfast room which leads out to the garden. Two generously sized bedrooms and bathroom.

Additional benefits include designated parking and a location that combines convenience with tranquillity. Harbourne Gardens is perfectly placed for access to West End's local shops, Bitterne, the M27, and Southampton City Centre, making commuting and everyday errands a breeze. The property is available now for a long term let.



£1,300 pcm

Harbourne Gardens, Chartwell Green, West End





£1,300 pcm

Harbourne Gardens, Chartwell Green, West End



Approximate total area⁽¹⁾
51.2 m²
552 ft²

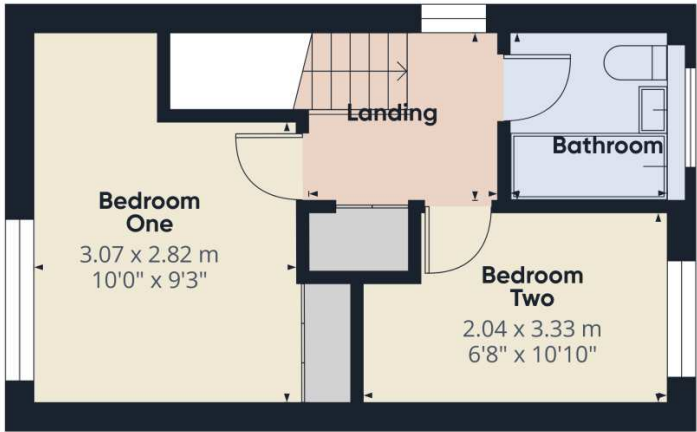

Floor 1

(1) Excluding balconies and terraces

Calculations reference the RICS IPMS 3C standard. Measurements are approximate and not to scale. This floor plan is intended for illustration only.

GIRAFFE360

Energy Efficiency Rating

	Current	Potential
Very energy efficient - lower running costs		
(92+) A		
(81-91) B		88
(69-80) C	69	
(55-68) D		
(39-54) E		
(21-38) F		
(1-20) G		
Not energy efficient - higher running costs		
England, Scotland & Wales	EU Directive 2002/91/EC	

Address: West End, SO18

