



9 Meggeson Avenue, Southampton, SO18 2ET  
**£1,150 Per Calendar Month**





Floor Plan

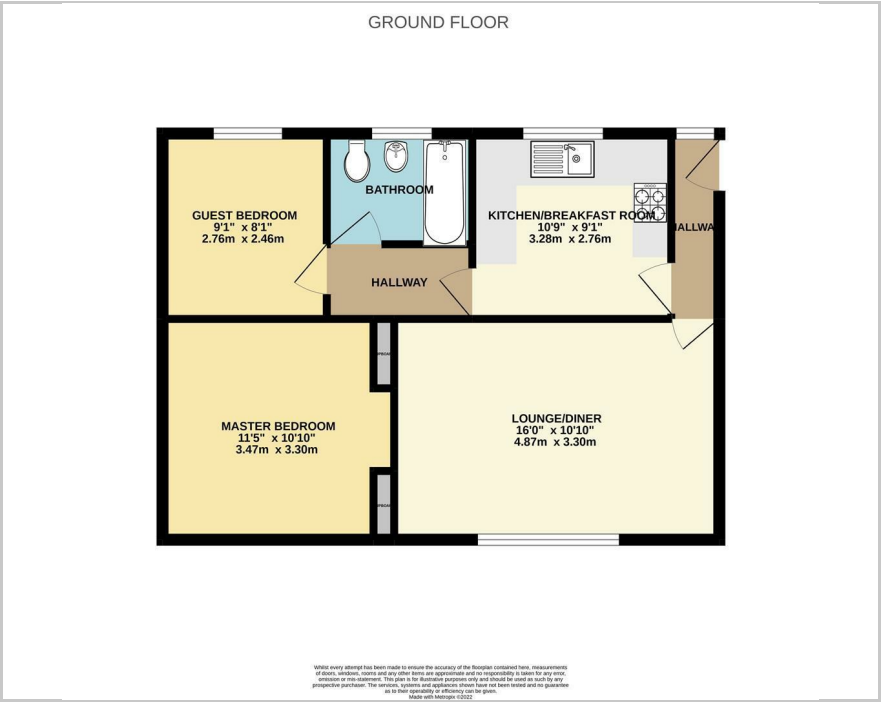

Area Map

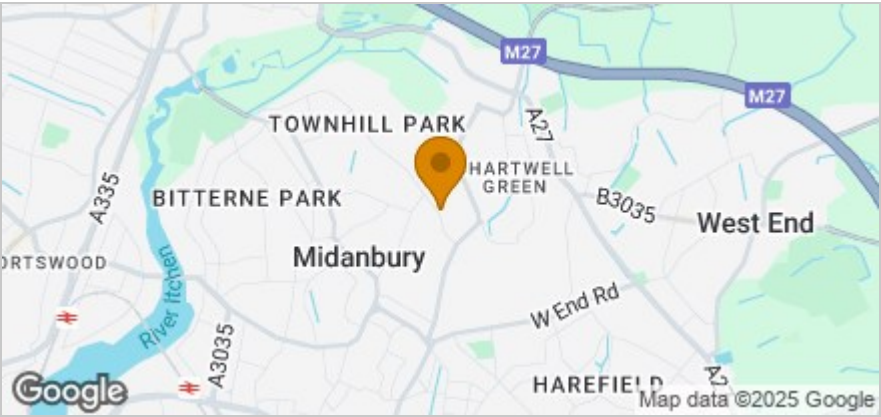

These particulars, whilst believed to be accurate are set out as a general outline only for guidance and do not constitute any part of an offer or contract. Intending purchasers should not rely on them as statements of representation of fact, but must satisfy themselves by inspection or otherwise as to their accuracy. No person in this firm's employment has the authority to make or give any representation or warranty in respect of the property.

32 Bridge Road, Park Gate, Southampton, Hampshire, SO31 7GF  
Tel: 01489 584298 Email: [hello@chimneyptsestateagents.co.uk](mailto:hello@chimneyptsestateagents.co.uk) <https://www.chimneyptsestateagents.co.uk>

Situated in the popular location of Townhill Park is this first-floor maisonette which is available from mid June, unfurnished for a long-term let. The property offers bright and spacious accommodation comprising a 15FT lounge/ diner. There is a modern fitted kitchen/ breakfast room with a fitted oven and hob. There are two double bedrooms and a modern bathroom.

The property is conveniently located within walking distance of the local shops and Bitterne Precinct, there are good public transport links and easy access to the M27.

\* NO PETS \*

Viewing

Please contact our Chimneypts Estate Agents Office on 01489 584298 if you wish to arrange a viewing appointment for this property or require further information.

Energy Efficiency Graph

