



The Granary Northwick Park, Blockley



The Granary is a delightful spacious Curtilage Listed Cotswold stone barn which was originally converted from a former driftwood barn in around 1990. The gas centrally heated accommodation, which is light and airy, briefly comprises: entrance hall/dining room with high vaulted ceilings, sitting room with full-length French windows to the rear terrace and arched window to the front, a feature fireplace and high vaulted ceilings, kitchen with fitted wall units and some integrated appliances. Down the hall you will find a family bathroom and two double bedrooms one of which has an en-suite shower room. Outside there is a area of private terrace at the front of the property and to the rear there is a private patio overlooking the well-maintained shared courtyard with a circular pond and range of mature planting. There is a single en-bloc garage with parking in front. Included with the purchase is full use of the communal parkland, croquet lawn, tennis courts, heated swimming pool and 24 hour security.

EPC: E

Council Tax Band: E

Tenure: Freehold

Service Charge: The current service charge is £1270 per quarter and is used to maintain the parkland and gardens, open air swimming pool, croquet lawn, tennis courts, 24 hour security and park lighting. There is also an electric vehicle charging facility on site.

Northwick Park is situated in thirty five acres of managed parkland in an area of Outstanding Natural Beauty in the heart of the North Cotswolds. The nearby town of Moreton-in-Marsh provide a wide range of day to day facilities, and Moreton-in-Marsh also has a mainline rail station serving London Paddington. The highly regarded village of Blockley is perhaps the closest and provides a genuine local community as well as a village store with Post Office, a pub, and a church.





3 The Granary Northwick Park Blockley GL56 9RJ
House Approx. Gross Internal Area:- 80.54 sq.m. 867 sq.ft.

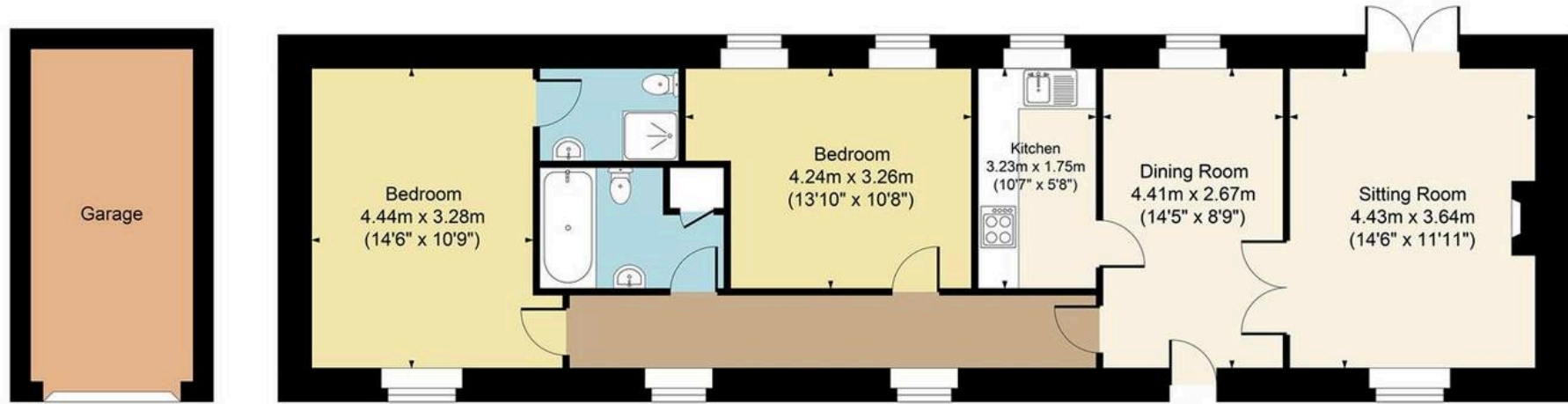

FOR ILLUSTRATIVE PURPOSES ONLY-NOT TO SCALE
The position & size of doors, windows, appliances and other features are approximate only.
[---] Denotes restricted head height
www.dmlphotography.co.uk