



*jordan fishwick*

Fernilee Close New Mills High Peak





## Fernilee Close New Mills High Peak SK22 4DZ

£220,000



### The Property

End mews property in a popular residential location with stunning open views over New Mills and the adjoining countryside. With scope for updating and improvement the property in brief comprises; Entrance porch, dining kitchen with bay window, living room, two double bedrooms, bathroom, front and rear gardens and allocated off road parking.





- End Mews Property in a Popular Residential Location
- Two Double Bedrooms
- Allocated Off Road Parking
- Stunning Open Views Across New Mills
- Dining Kitchen and Living Room
- Gas Central Heating and Double Glazing
- Convenient Cul de Sac Location
- Scope for Updating and Cosmetic Improvement

Postcode

SK22 4DZ

EPC Rating

D

Local Authority

High Peak Borough

Council Tax

B

Energy Efficiency Rating		
	Current	Potential
Very energy efficient - lower running costs		
(92 plus) A		
(81-91) B		
(69-80) C		75
(55-68) D	64	
(39-54) E		
(21-38) F		
(1-20) G		
Not energy efficient - higher running costs		
England & Wales	EU Directive 2002/91/EC 	



GROUND FLOOR  
386 sq.ft. (35.9 sq.m.) approx.

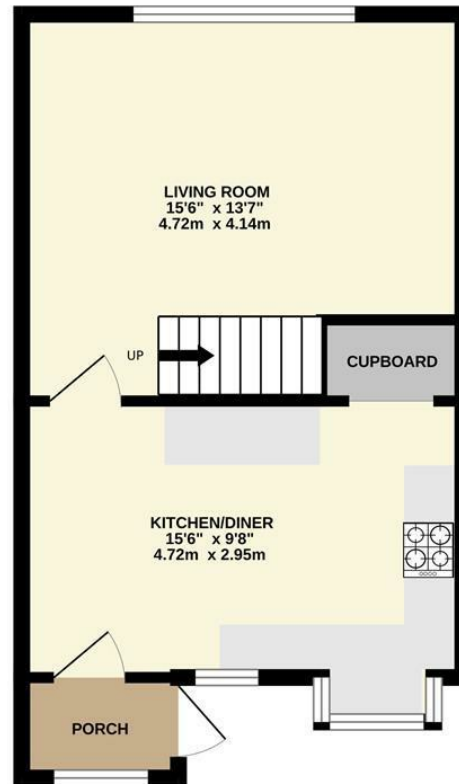

1ST FLOOR  
360 sq.ft. (33.5 sq.m.) approx.

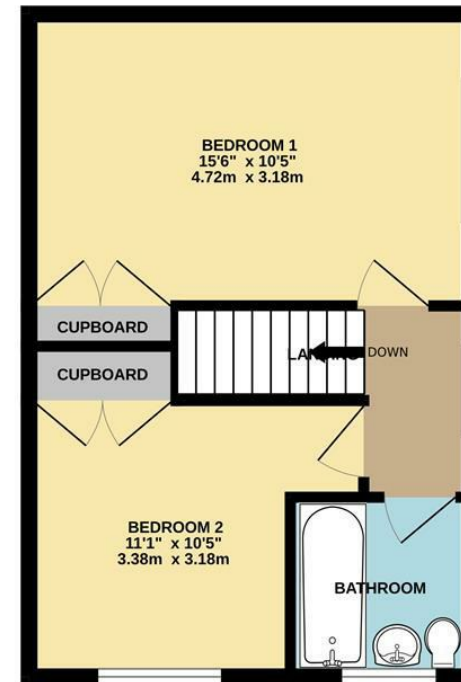

TOTAL FLOOR AREA: 746 sq.ft. (69.3 sq.m.) approx.

Whilst every attempt has been made to ensure the accuracy of the floorplan contained here, measurements of doors, windows, rooms and any other items are approximate and no responsibility is taken for any error, omission or mis-statement. This plan is for illustrative purposes only and should be used as such by any prospective purchaser. The services, systems and appliances shown have not been tested and no guarantee as to their operability or efficiency can be given.  
Made with Metropix ©2025



These particulars are believed to be accurate but they are not guaranteed and do not form a contract. Neither Jordan Fishwick nor the vendor or lessor accept any responsibility in respect of these particulars, which are not intended to be statements or representations of fact and any intending purchaser or lessee must satisfy himself by inspection or otherwise as to the correctness of each of the statements contained in these particulars. Any floorplans on this brochure are for illustrative purposes only and are not necessarily to scale.

Offices at: Chorlton, Didsbury, Disley, Hale, Glossop, Macclesfield, Manchester Deansgate, Manchester Whitworth Street, New Mills, Sale, Wilmslow and Withington

14 Market St, Disley, Cheshire, Stockport SK12 2AA

01663 767878

disley@jordanfishwick.co.uk

www.jordanfishwick.co.uk