



jordan fishwick

Albion Road New Mills High Peak



Albion Road New Mills High Peak SK22 3EY

£259,995



The Property

Beautifully presented following a comprehensive refurbishment throughout, a larger than average stone mid terrace property. With FOUR bedrooms, TWO reception rooms and OFF ROAD PARKING this stunning property is a must see. Quality fixtures and fittings and finished to a high standard - a true turn key home. Briefly comprising; entrance hall, living room and bedroom four/study to the first floor, the lower ground floor consists of a brand new contemporary kitchen, dining room, utility room, WC and access to the rear garden/parking area. There are there further bedrooms and newly installed family bathroom to the third floor. All within a convenient location for New Mills centre and train stations and benefitting from no onward chain.



- Completely Refurbished Throughout to a High Standard
- Larger Than Average Stone Terrace Property with Four Bedrooms and Two Reception Rooms
- Accommodation Over Three Floors Including Brand New Modern Kitchen and Bathroom
- Convenient Location and Off Road Parking/Garden to Rear
- Lower Ground Floor Utility Room and WC
- Neutral Colour Scheme and Brand New Flooring Throughout
- No Onward Chain

Postcode

SK22 3EY

EPC Rating

C

Local Authority

High Peak

Council Tax

A

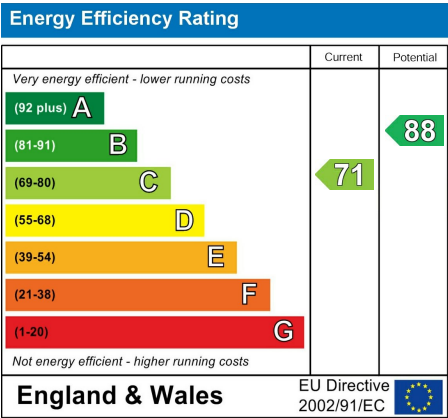

BASEMENT
360 sq.ft. (33.4 sq.m.) approx.

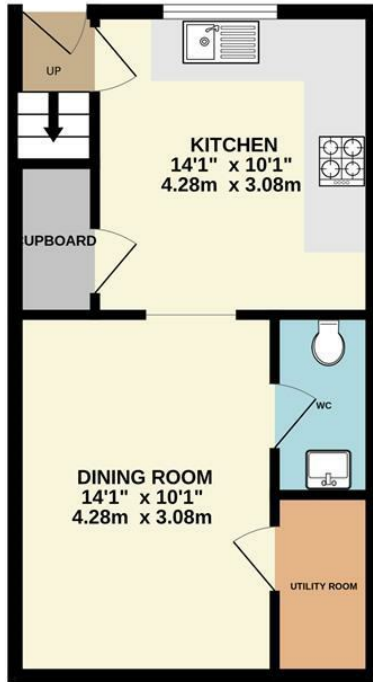

GROUND FLOOR
409 sq.ft. (38.0 sq.m.) approx.

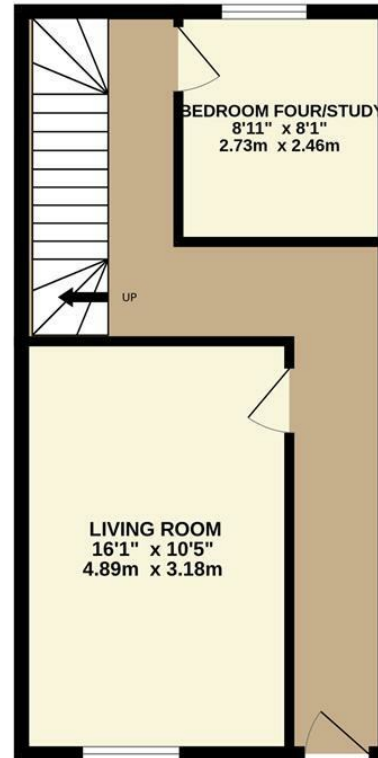

1ST FLOOR
409 sq.ft. (38.0 sq.m.) approx.

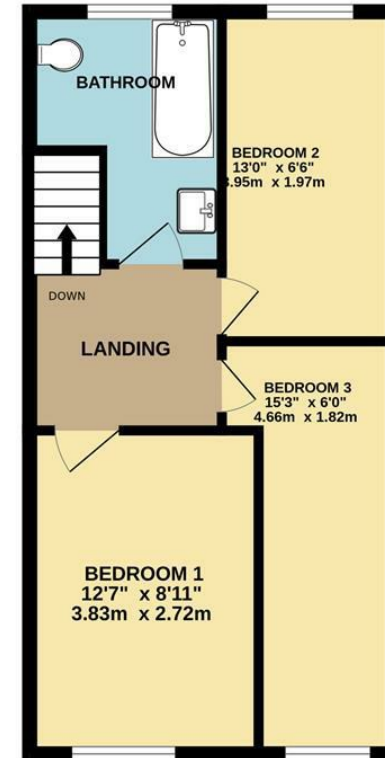

TOTAL FLOOR AREA : 1178 sq.ft. (109.4 sq.m.) approx.

Whilst every attempt has been made to ensure the accuracy of the floorplan contained here, measurements of doors, windows, rooms and any other items are approximate and no responsibility is taken for any error, omission or mis-statement. This plan is for illustrative purposes only and should be used as such by any prospective purchaser. The services, systems and appliances shown have not been tested and no guarantee as to their operability or efficiency can be given.
Made with Metropix ©2025



These particulars are believed to be accurate but they are not guaranteed and do not form a contract. Neither Jordan Fishwick nor the vendor or lessor accept any responsibility in respect of these particulars, which are not intended to be statements or representations of fact and any intending purchaser or lessee must satisfy himself by inspection or otherwise as to the correctness of each of the statements contained in these particulars. Any floorplans on this brochure are for illustrative purposes only and are not necessarily to scale.

Offices at: Chorlton, Didsbury, Disley, Hale, Glossop, Macclesfield, Manchester Deansgate, Manchester Whitworth Street, New Mills, Sale, Wilmslow and Withington

14 Market St, Disley, Cheshire, Stockport SK12 2AA

01663 767878

disley@jordanfishwick.co.uk
www.jordanfishwick.co.uk