



jordan fishwick

Hayfield Road Birch Vale High Peak



Hayfield Road Birch Vale High Peak SK22 1DF

Offers In The Region Of



The Property

A well presented three bedroom stone built mid-terrace property in the semi rural location of Birch Vale, with beautiful open aspect views to the rear. The property has been well maintained by the current owner and in brief comprises of: Front reception room with log burner, kitchen/diner with exposed brick featured wall and access to a utility area. To the first floor are two good sized double bedrooms with space for furnishings, whilst the loft conversion provides a third double bedroom and eaves storage on either side offering plenty of storage space. The property in recent years been improved by newly fitted PVC double glazing in 2018 and is also warmed by a gas central heating boiler. To the rear of the property is a small wooden decked area accessed off the utility room, this leads to a private and enclosed paved seating area where views of the beautiful open countryside can be truly appreciated. ****No Onward Chain****



- Three Bedroom Property
- Mid-Stone Terrace
- Over Three Floors
- Dining Kitchen & Utility Room
- No Onward Chain
- Open Aspect Rear Views
- Log Burning Stove
- Eaves Storage

Postcode

SK22 1DF

EPC Rating

D

Local Authority

High Peak Council

Council Tax

B

Energy Efficiency Rating		
	Current	Potential
Very energy efficient - lower running costs		
(92 plus) A	61	84
(81-91) B		
(69-80) C		
(55-68) D		
(39-54) E		
(21-38) F		
(1-20) G		
Not energy efficient - higher running costs		
EU Directive 2002/91/EC		
England & Wales		



GROUND FLOOR

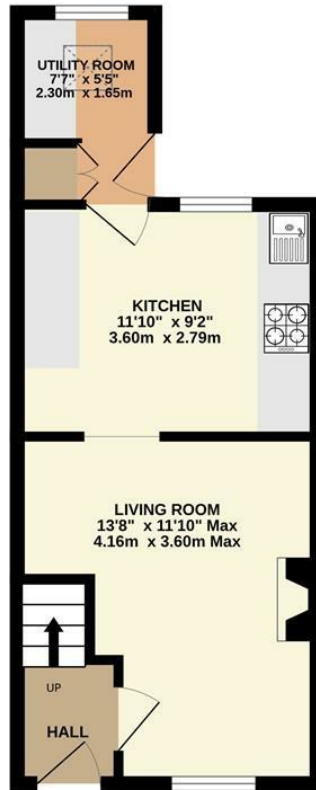

1ST FLOOR

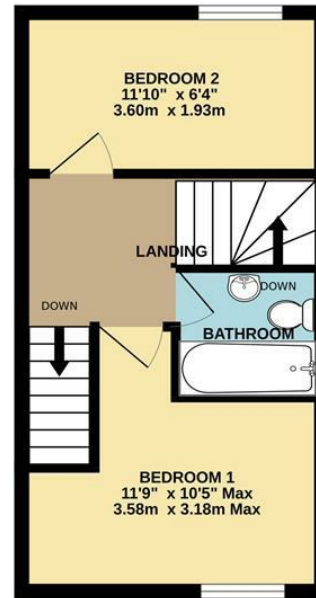

2ND FLOOR

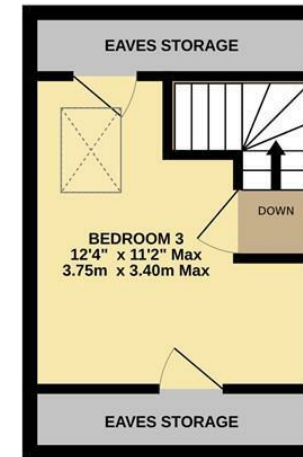

Whilst every attempt has been made to ensure the accuracy of the floorplan contained here, measurements of doors, windows, rooms and any other items are approximate and no responsibility is taken for any error, omission or mis-statement. This plan is for illustrative purposes only and should be used as such by any prospective purchaser. The services, systems and appliances shown have not been tested and no guarantee as to their operability or efficiency can be given.
Made with Metropix ©2024



These particulars are believed to be accurate but they are not guaranteed and do not form a contract. Neither Jordan Fishwick nor the vendor or lessor accept any responsibility in respect of these particulars, which are not intended to be statements or representations of fact and any intending purchaser or lessee must satisfy himself by inspection or otherwise as to the correctness of each of the statements contained in these particulars. Any floorplans on this brochure are for illustrative purposes only and are not necessarily to scale.

Offices at: Chorlton, Didsbury, Disley, Hale, Glossop, Macclesfield, Manchester Deansgate, Manchester Whitworth Street, New Mills, Sale, Wilmslow and Withington

2 Union Road, New Mills, High Peak, Derbyshire, SK22 3ES

01663 767878

newmills@jordanfishwick.co.uk

www.jordanfishwick.co.uk