



Jordan fishwick

High Lea Road New Mills High Peak



High Lea Road New Mills High Peak SK22 3DP

Offers Over £475,000



The Property

Derbyshire House is a stunning Victorian semi-detached property, deceptively spacious spanning four floors. Boasting original features, high ceilings and tasteful decor, this beautiful home offers a blend of character and modern living.

You are greeted by a warm and inviting entrance hall with stairs to the first floor and access to the open plan living and dining accommodation. Perfect for entertaining guests or relaxing with family and featuring a cosy wood-burning stove and a balcony overlooking stunning open views.

Additionally, the lower ground floor has a family snug, a recently fitted shower room and a large conservatory with open views and access into the garden.

The property comprises three generously sized bedrooms and a loft room with eaves storage and velux windows accessible via a fixed staircase, providing versatility for various needs. The family bathroom is stunning with both a free standing slipper bath and shower cubicle.

Outside, the property has a private walled rear garden with open views which adjoins a community orchard, alongside a shared drive.

This property truly offers a unique blend of Victorian charm, modern comforts, and picturesque surroundings. Don't miss the opportunity to make this house your home in the heart of Derbyshire.



- Stunning Semi Detached Victorian Property Bursting with Original Features
- Light and Bright Accommodation over Four Floors
- Open Plan Living/Dining Room with Wood Burning Stove and Rear Balcony
- Modern Fitted Kitchen and Bathroom
- Lower Ground Floor Snug, Shower Room and Conservatory
- Three Good Sized Bedrooms Plus Loft Room
- Walled Rear Garden with Open Views Backing onto an Orchard
- Tastefully Decorated Throughout

Postcode SK22 3DP

EPC Rating D

Local Authority High Peak Borough

Council Tax C

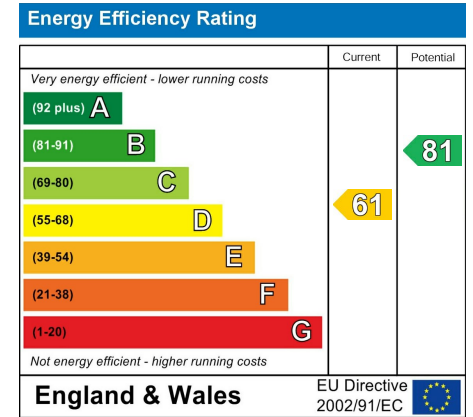

BASEMENT LEVEL

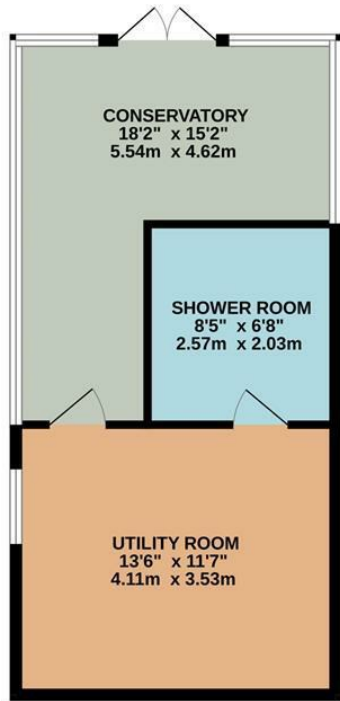

GROUND FLOOR

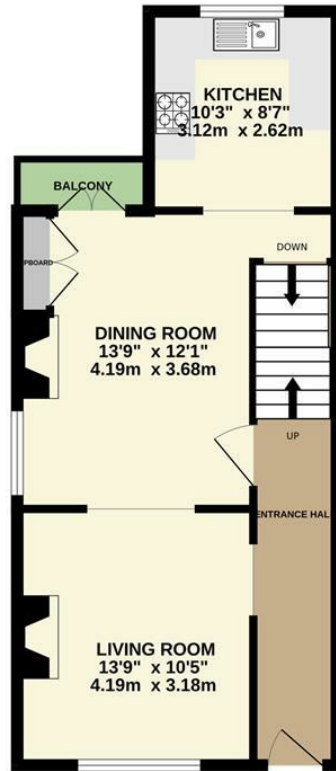

1ST FLOOR



2ND FLOOR

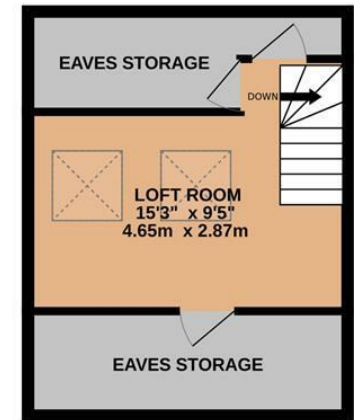

Whilst every attempt has been made to ensure the accuracy of the floorplan contained here, measurements of doors, windows, rooms and any other items are approximate and no responsibility is taken for any error, omission or mis-statement. This plan is for illustrative purposes only and should be used as such by any prospective purchaser. The services, systems and appliances shown have not been tested and no guarantee as to their operability or efficiency can be given.
Made with Metropix ©2024



These particulars are believed to be accurate but they are not guaranteed and do not form a contract. Neither Jordan Fishwick nor the vendor or lessor accept any responsibility in respect of these particulars, which are not intended to be statements or representations of fact and any intending purchaser or lessee must satisfy himself by inspection or otherwise as to the correctness of each of the statements contained in these particulars. Any floorplans on this brochure are for illustrative purposes only and are not necessarily to scale.

Offices at: Chorlton, Didsbury, Disley, Hale, Glossop, Macclesfield, Manchester Deansgate, Manchester Whitworth Street, New Mills, Sale, Wilmslow and Withington

2 Union Road, New Mills, High Peak, Derbyshire, SK22 3ES

01663 767878

newmills@jordanfishwick.co.uk

www.jordanfishwick.co.uk