

These particulars are believed to be accurate but they are not guaranteed and do not form a contract. Neither Jordan Fishwick nor the vendor or lessor accept any responsibility in respect of these particulars, which are not intended to be statements or representations of fact and any intending purchaser or lessee must satisfy himself by inspection or otherwise as to the correctness of each of the statements contained in these particulars. Any floorplans on this brochure are for illustrative purposes only and are not necessarily to scale.

Whilst every attempt has been made to ensure the accuracy of the floorplan contained here, measurements of doors, windows, rooms and any other items are approximate and no responsibility is taken for any error, omission or mis-statement. This plan is for illustrative purposes only and should be used as such by any prospective purchaser. The services, systems and appliances shown have not been tested and no guarantee as to their operability or efficiency can be given.  
 Made with Metropix ©2024

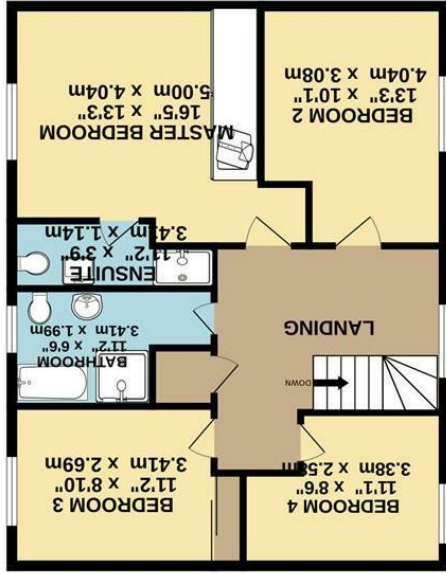

1ST FLOOR  
 739 sq.ft. (68.7 sq.m.) approx.



GROUND FLOOR  
 1312 sq.ft. (121.9 sq.m.) approx.



3 Lantern Pike View, Birch Vale, High Peak, SK22 1BJ

£550,000



### The Property

Lantern Pike View is a stunning detached house located in the picturesque Birch Vale, High Peak. This property boasts three reception rooms, perfect for entertaining guests or simply relaxing with your family. With four spacious bedrooms, master with en suite and a modern family bathroom, there is plenty of room for everyone in the household.

The modern kitchen with integrated appliances and granite worktop, has French doors leading onto the patio area of the garden and also opens up into a bright dining room, perfect for entertaining.

Situated in a serene location, this house offers parking for three vehicles alongside a double garage ensuring convenience for you and your visitors. The property is beautifully presented with a high spec finish, providing a luxurious and comfortable living space.

One of the highlights of this home is its proximity to the Sett Valley Trail, offering endless opportunities for outdoor activities and leisurely walks in the beautiful surroundings. The open aspect to the rear of the property provides a sense of space and tranquillity, making it a perfect retreat from the hustle and bustle of everyday life.

Don't miss the chance to make this charming property your new home. Contact us today to arrange a viewing and experience the beauty and elegance of Lantern Pike View for yourself.



- Immaculate Detached Four Bedroom Family Home
- Stunning Kitchen with Granite Worktops
- Rear Garden Backing onto Farmland
- Large Living Room with Morso Stove
- Three Reception Rooms
- Energy Rating: C Council Tax: F
- Idyllic Location Close to The Sett Valley Trail
- Cul de Sac Location and Rear Views
- Block Paved Drive and Double Garage

Postcode - SK22 1BJ  
 EPC Rating - C  
 Local Authority - High Peak  
 Council Tax - F

