



Jordan fishwick

Low Leighton Road New Mills High Peak

Low Leighton Road New Mills High Peak SK22 4PJ

Reduced To £415,999



The Property

Immaculately presented and deceptively spacious! Arranged over three floors with upto four bedrooms, this stunning, stone built end of terrace home is a real box ticker. Contemporary neutral decor with open plan living accommodation complimented by wood burning stoves. Pvc double glazing, gas central heating, enclosed lawn garden with store and off road parking. Comprising: entrance hall, 25ft living dining room, study/bedroom four, lower ground floor breakfast kitchen with sitting area, utility room and wc, three first floor double bedrooms with fitted wardrobes including an en-suite to the master bedroom and a family bathroom. Viewing highly recommended.



- Superbly Presented
- Deceptively Spacious
- Upto Four Bedrooms
- Stone Built End Of Terrace
- Gardens and Parking
- Convenient Location
- Open Plan Reception Rooms
- Wood Burning Stoves
- Utility Room

Postcode SK22 4PJ

EPC Rating C

Local Authority High Peak

Council Tax C

Energy Efficiency Rating		
	Current	Potential
Very energy efficient - lower running costs		
(92 plus) A		
(81-91) B		
(69-80) C	74	85
(55-68) D		
(39-54) E		
(21-38) F		
(1-20) G		
Not energy efficient - higher running costs		
England & Wales	EU Directive 2002/91/EC 	



LOWER GROUND FLOOR

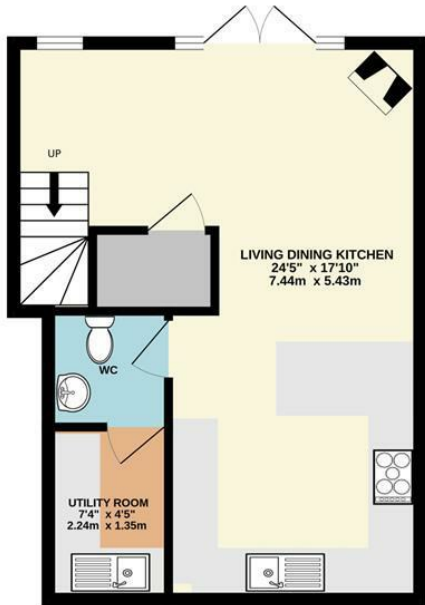

GROUND FLOOR

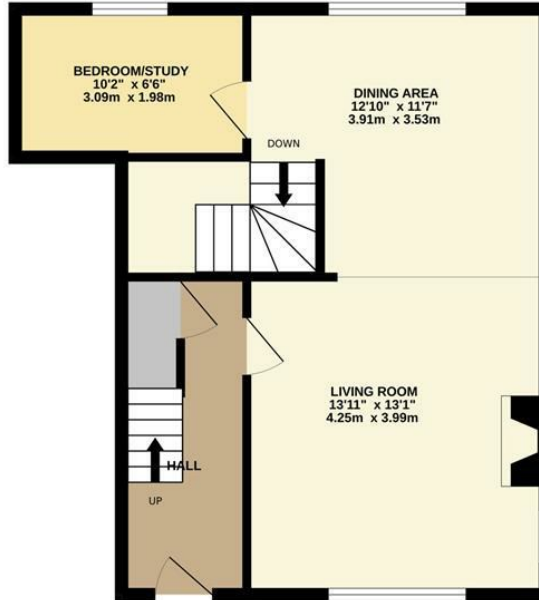

1ST FLOOR

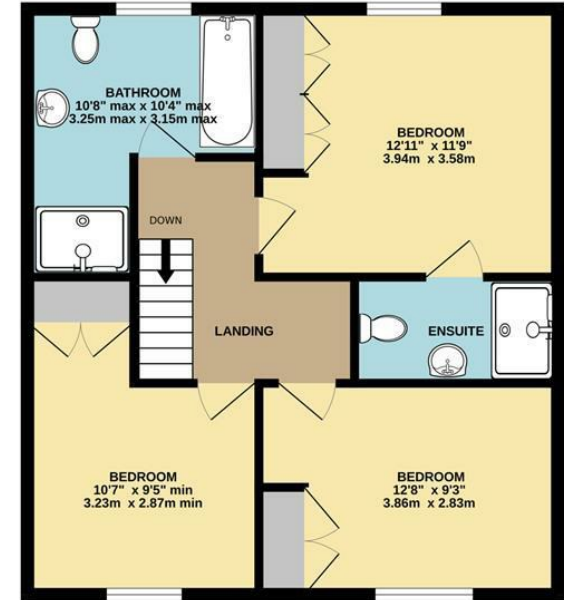

Whilst every attempt has been made to ensure the accuracy of the floorplan contained here, measurements of doors, windows, rooms and any other items are approximate and no responsibility is taken for any error, omission or mis-statement. This plan is for illustrative purposes only and should be used as such by any prospective purchaser. The services, systems and appliances shown have not been tested and no guarantee as to their operability or efficiency can be given.
Made with Metropix ©2023



These particulars are believed to be accurate but they are not guaranteed and do not form a contract. Neither Jordan Fishwick nor the vendor or lessor accept any responsibility in respect of these particulars, which are not intended to be statements or representations of fact and any intending purchaser or lessee must satisfy himself by inspection or otherwise as to the correctness of each of the statements contained in these particulars. Any floorplans on this brochure are for illustrative purposes only and are not necessarily to scale.

Offices at: Chorlton, Didsbury, Disley, Hale, Glossop, Macclesfield, Manchester Deansgate, Manchester Whitworth Street, New Mills, Sale, Wilmslow and Withington

2 Union Road, New Mills, High Peak, Derbyshire, SK22 3ES

newmillsforward@jordanfishwick.co.uk

www.jordanfishwick.co.uk