



Underhill Llanmadoc, Gower, Swansea, City & County Of Swansea, SA3 1DB

£499,995

A one of a kind opportunity. Surrounded by colourful countryside this exceptional plot has planning permission granted for a substantial five bedroom, detached, farmhouse style family home. Tucked away at the end of a country lane in Britain's First Designated Area Of Outstanding Natural Beauty the elevated plot of approximately 1.7 acres boasts enviable sea vistas whilst the rural location allows for high levels of privacy.

Special mention should be made to the quality of design which will allow for extensive accommodation (approximately 4300 Sq Ft) perfectly suited to modern family life whilst the vast amount of glazing throughout will allow light to fill the property and serve to magnify the spectacular outlook.

The accommodation will comprise: To the ground floor, entrance lobby, hallway with glass link to sun room, cloakroom, lounge, open plan living/kitchen/dining room and a utility room. To the first floor, landing with

Current Dwelling

Proposed Plans



Aerial



Plot

Aerial



Aerial



Aerial

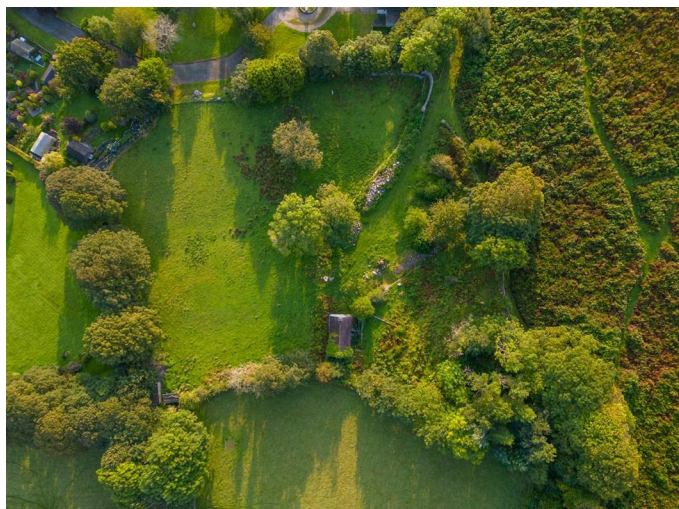

Plot



Aerial

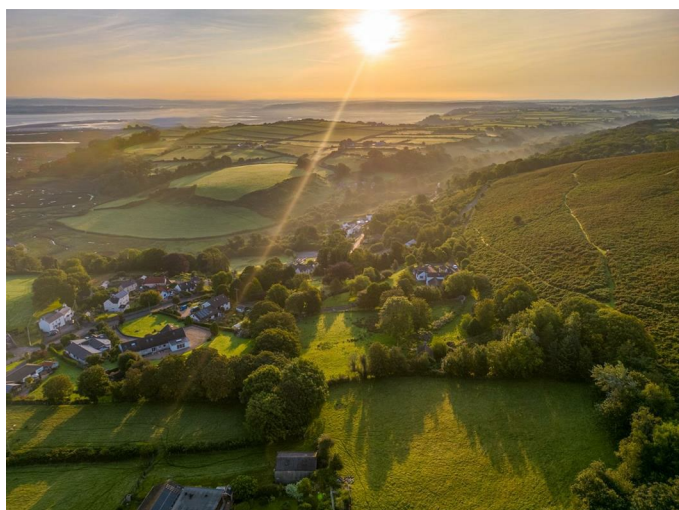

Plot



Plot



Plot



Plot



Plot

Plot



Plot



Plot



Access is fully established and registered with the Land Registry.

Floor Plan

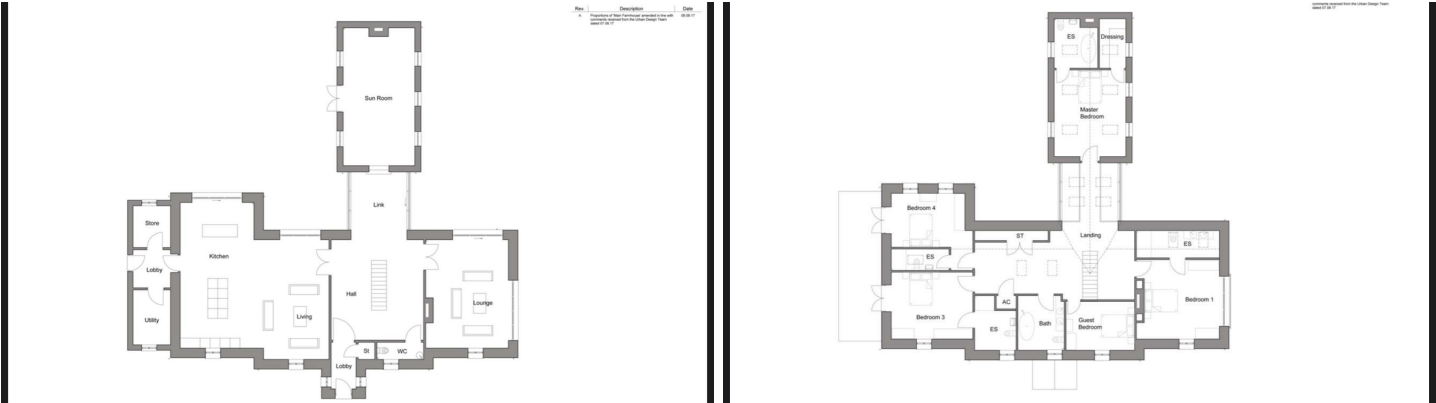

Area Map



Energy Efficiency Graph

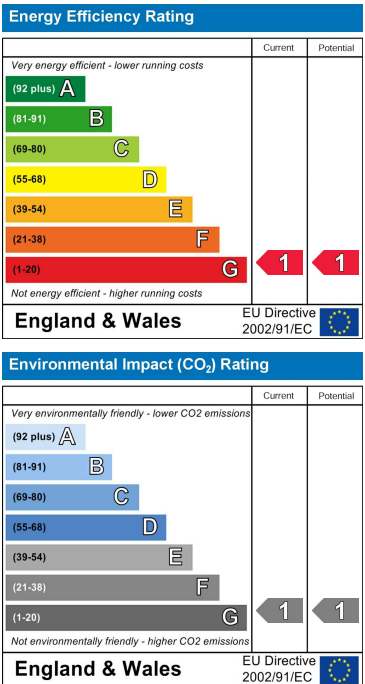

These particulars, whilst believed to be accurate are set out as a general outline only for guidance and do not constitute any part of an offer or contract. Intending purchasers should not rely on them as statements of representation of fact, but must satisfy themselves by inspection or otherwise as to their accuracy. No person in this firms employment has the authority to make or give any representation or warranty in respect of the property.