



£160,000

🔑 TENURE: **Freehold**

📊 EPC RATING: **C**

🏠 COUNCIL TAX BAND: **A**

Market Drayton

Victoria Road
Market Drayton Shropshire TF9



If you are looking for a pretty cottage style terraced home then you won't find much better than this lovely home which has been well looked after and is well presented throughout.

The home, which has a private cottage rear garden with lawn and sun terrace is ideal for a young family, first time buyers or downsizers. Comprising living room with chimney breast recess, fitted breakfast kitchen with built in cooking facilities, rear porch and family bathroom. To the first floor there are two bedrooms.

- Cottage Style Mid Terraced Home
- Lounge & Breakfast Kitchen
- Two First Floor Bedrooms
- Ground Floor Bathroom
- Lovely Private Lawned Rear Garden
- Popular Location

You can reach us **9am to 9pm**, 7 days a week

28/29 High Street, Market Drayton, Shropshire, TF9 1QF

01630 658888

hellomarketdrayton@dourishandday.co.uk



Living Room 10' 11" x 11' 11" (3.32m x 3.64m)

Composite half glass double glazed front entrance door, chimney breast recess with tiled hearth, radiator and double glazed window to the front.

Dining Kitchen 11' 11" x 8' 11" (3.64m x 2.73m)

Fitted with a range of base and wall units, work surfaces to three sides and inset stainless steel sink unit, drainer and mixer tap. Integrated four ring electric hob with cooker hood over and electric oven below. Tiling to the floor, stairs to the first floor with under stair cupboard below, radiator and double glazed window to the rear.

Rear Hallway

Having radiator, half glass double glazed door to the rear garden and door to the bathroom.



Bathroom 8' 8" x 6' 5" (2.65m x 1.95m)

Fitted with a white suite comprising low level WC, pedestal wash basin and panel bath with electric shower over. Tiling to the walls, radiator and double glazed window to the side.

Landing

Doors off to the two bedrooms.

Bedroom One 12' 0" x 10' 11" (3.65m x 3.32m)

A spacious double bedroom with radiator and double glazed window to the front.

Bedroom Two 11' 11" x 9' 2" (3.64m x 2.8m)

Airing cupboard and additional over stair cupboard. Loft access with loft ladder to a part boarded loft with power and lighting.

Outside Rear

The home has a lovely private cottage style garden with paved patio leading onto the lawned garden with further sun terrace and garden shed.



GROUND FLOOR

1ST FLOOR

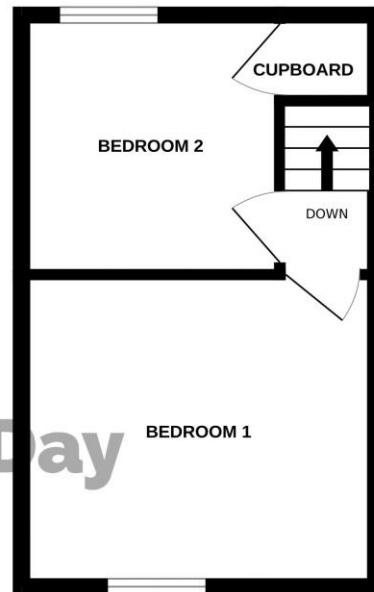
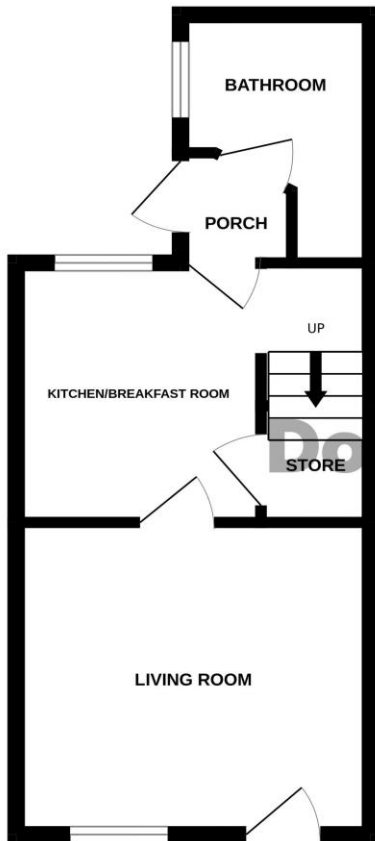

Dourish&Day

Whilst every attempt has been made to ensure the accuracy of the floorplan contained here, measurements of doors, windows, rooms and any other items are approximate and no responsibility is taken for any error, omission or mis-statement. This plan is for illustrative purposes only and should be used as such by any prospective purchaser. The services, systems and appliances shown have not been tested and no guarantee as to their operability or efficiency can be given.
Made with Metropix 5/2024

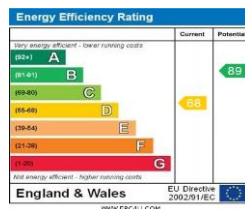

IMPORTANT NOTICE Dourish & Day for themselves and for the vendor or lessors of this property whose agents they are given notice that: (i) the particulars are set out as a general outline only for the guidance of intending purchasers or lessees, and do not constitute, nor constitute part of, an offer of contract, (ii) all descriptions, dimensions, references to condition and necessary permissions for use and occupation, and other details are given in good faith and are believed to be correct but any intending purchasers or tenants should not rely on them as statement or representation of fact but must satisfy themselves by inspection or otherwise as to the correctness of each of them, (iii) no person in the employment of Dourish & Day has any authority to make or give any representation or warranty whatever in relation to this property.

You can reach us **9am to 9pm**, 7 days a week

28/29 High Street, Market Drayton, Shropshire, TF9 1QF

01630 658888

hellomarketdrayton@dourishandday.co.uk