



£375,000

🔑 TENURE: Freehold

📊 EPC RATING: C

💷 COUNCIL TAX BAND: D

## Market Drayton

Frogmore Road  
Market Drayton Shropshire



This is one of the most stylish detached bungalows we have seen for a little while and offers a fantastic opportunity to drop in your belongings and relax. And relax is what you will do, as this home has been designed with this in mind, embracing Al-Fresco dining to the contemporary style of living. The hub of the home is the large open plan lounge/dining/kitchen area offering lots of natural light through the large bi-fold doors opening onto the garden and ideal for entertaining. The kitchen area offers an extensive range of units, including island and various built in appliances. There is also two double bedrooms with the larger having a modern en-suite shower room, as well as a modern family shower room and utility off the kitchen. There is off road parking and detached garage and a landscaped rear garden.

- Stylish Two Bedroom Detached Bungalow
- Immaculately Presented Throughout
- Open Plan Kitchen, Dining & Living Room
- Large Bi-Fold Doors For El Fresco Dining
- Contemporary En-Suite & Shower Room
- Landscaped Gardens, Driveway & Garage

You can reach us **9am to 9pm**, 7 days a week

28/29 High Street, Market Drayton, Shropshire, TF9 1QF

**01630 658888**

hellomarketdrayton@dourishandday.co.uk





## Entrance Hallway

Accessed through a composite double glazed front entrance door and side panel, two contemporary column style radiators, inset ceiling spot lighting and loft access.

## Family Living Space

The hub of the home is the stylish open plan living area which includes a lounge, dining area and kitchen.

## Lounge/Dining Room 19' 8" x 19' 11" (6.0m x 6.07m)

This large reception area has a lots of natural light and is ideal for El-Fresco dining in conjunction with the sun terrace to the rear thanks to the bi-fold doors onto the garden and further double glazed window to the side in the dining area. Inset ceiling spot lighting and contemporary column radiator.

## Kitchen Area 15' 7" x 11' 4" (4.75m x 3.45m)

Fitted with a range of stylish base and wall units with wood block work surfaces to two sides incorporating an enamel sink, drainer and mixer tap. Integral appliances include five burner induction hob, electric oven and microwave. There is also a matching central island which incorporated a breakfast bar and also has an integrated wine cooler. Inset ceiling spot lighting and double glazed window to the front.



You can reach us **9am to 9pm**, 7 days a week

28/29 High Street, Market Drayton, Shropshire, TF9 1QF

**01630 658888**

[hellomarketdrayton@dourishandday.co.uk](mailto:hellomarketdrayton@dourishandday.co.uk)

## **Utility** 8' 9" x 4' 1" (2.67m x 1.25m)

Fitted with matching base and larder units plus work surface to match the kitchen. Space for a washer and double glazed window to the front.

## **Bedroom One** 12' 11" x 10' 11" (3.94m x 3.34m)

A spacious double bedroom with a contemporary column style radiator and double glazed window to the rear.

## **Bedroom One En-Suite** 7' 2" x 6' 2" (2.18m x 1.88m)

Fitted with a modern suite comprising double width tiled shower enclosure, vanity wash basin with mixer taps and low level WC with concealed cistern and vanity shelf over. Corner cupboard, contemporary column style radiator and double glazed window to the side.

## **Bedroom Two** 10' 0" x 10' 11" (3.04m x 3.34m)

A further double bedroom again with a contemporary column style radiator and double glazed window to the front.

## **Shower Room** 7' 3" x 5' 5" (2.22m x 1.64m)

Fitted with a modern suite comprising tiled shower enclosure, vanity wash basin with mixer taps and low level WC with concealed cistern and vanity shelf over. Corner cupboard and contemporary column style radiator.

## **Outside Front**

To the front of the bungalow is a decorative paved driveway and garden which extends to the side to provide further parking to the detached garage. There is also a block paved path to the front entrance door and access to the rear garden.

## **Detached Garage** 23' 11" x 12' 0" (7.3m x 3.66m)

A timber framed garage which has double doors to the front. power, lighting and windows to the side and rear.

## **Outside Rear**

The enclosed rear garden has been landscaped and is well stocked throughout. There is a stone paved sun terrace shaded by a fixed gazebo and bench. The large lawned garden is fringed with shaped borders with an lots of established plants and shrubs.

## **ID Checks**

Once an offer is accepted on a property marketed by Dourish & Day estate agents we are required to complete ID verification checks on all buyers and to apply ongoing monitoring until the transaction ends. Whilst this is the responsibility of Dourish & Day we may use the services of MoveButler, to verify Clients' identity. This is not a credit check and therefore will have no effect on your credit history. You agree for us to complete these checks, and the cost of these checks is £30.00 inc. VAT per buyer. This is paid in advance, when an offer is agreed and prior to a sales memorandum being issued. This charge is non-refundable.





## GROUND FLOOR

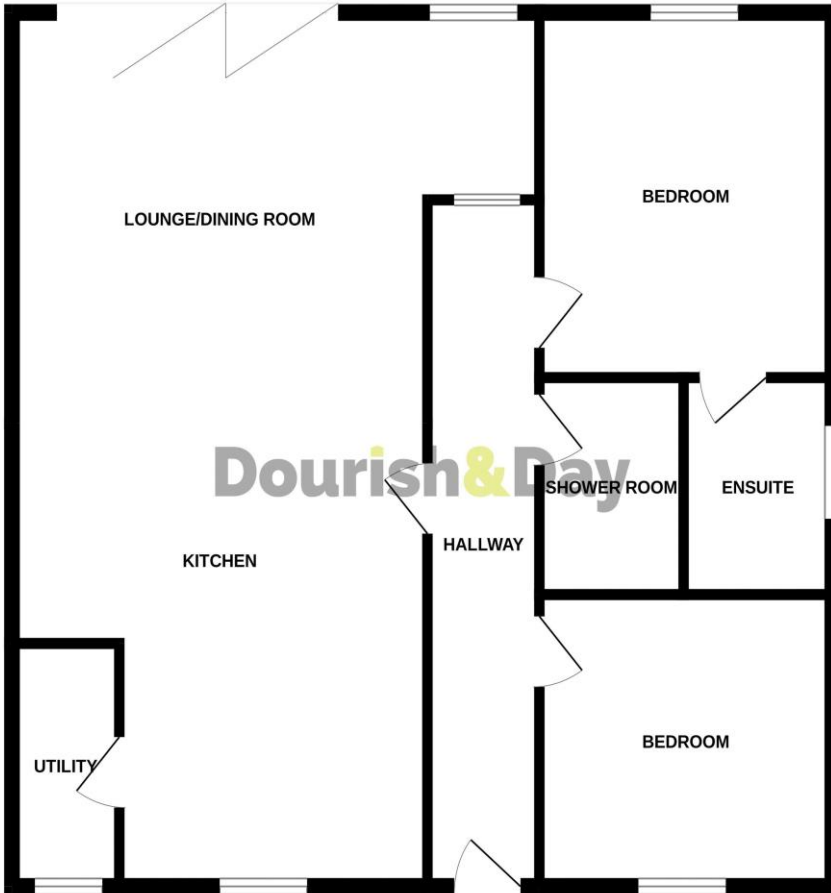

Whilst every attempt has been made to ensure the accuracy of the floorplan contained here, measurements of doors, windows, rooms and any other items are approximate and no responsibility is taken for any error, omission or mis-statement. This plan is for illustrative purposes only and should be used as such by any prospective purchaser. The services, systems and appliances shown have not been tested and no guarantee as to their operability or efficiency can be given.  
Made with Metropix ©2024



Energy Efficiency Rating		Current	Potential
<small>Energy Efficiency Rating (EPC) is a measure of the energy efficiency of a building. It is based on the building's energy performance relative to a standard building of the same type and size. The rating is expressed as a letter from A to G, with A being the most efficient and G being the least efficient.</small>			
A	B	C	D
E	F	G	
<small>Energy Efficiency Rating (EPC) is a measure of the energy efficiency of a building. It is based on the building's energy performance relative to a standard building of the same type and size. The rating is expressed as a letter from A to G, with A being the most efficient and G being the least efficient.</small>			
England & Wales		EU Directive 2002/91/EC	

**IMPORTANT NOTICE** Dourish & Day for themselves and for the vendor or lessors of this property whose agents they are given notice that: (i) the particulars are set out as a general outline only for the guidance of intending purchasers or lessees, and do not constitute, nor constitute part of, an offer of contract, (ii) all descriptions, dimensions, references to condition and necessary permissions for use and occupation, and other details are given in good faith and are believed to be correct but any intending purchasers or tenants should not rely on them as statement or representation of fact but must satisfy themselves by inspection or otherwise as to the correctness of each of them, (iii) no person in the employment of Dourish & Day has any authority to make or give any representation or warranty whatever in relation to this property.

You can reach us **9am to 9pm, 7 days a week**

**28/29 High Street, Market Drayton, Shropshire, TF9 1QF**

**01630 658888**

[hellomarketdrayton@dourishandday.co.uk](mailto:hellomarketdrayton@dourishandday.co.uk)