



£90,000

🔑 TENURE: Leasehold 📊 EPC RATING: TBC 💷 COUNCIL TAX BAND: A

Market Drayton

Stafford Street
Market Drayton Shropshire



This generous sized first floor flat is located in the centre of town, within walking distance of all the local facilities and offered with no onward chain!

The double bay fronted flat is bound to be popular with investors, first time buyers and anyone looking to down size to an affordable home so don't delay in viewing. Comprising hallway with stairs to the first floor, lounge with dining area, fitted kitchen, two bedrooms and bathroom.

- Double Bay Fronted First Floor Flat
- Town Centre Location
- Lounge With Dining Area
- Two Double bedrooms
- Kitchen & Bathroom
- Ideal Investment Opportunity. No Chain

You can reach us **9am to 9pm**, 7 days a week

28/29 High Street, Market Drayton, Shropshire, TF9 1QF

01630 658888

hellomarketdrayton@dourishandday.co.uk



Entrance Hallway

A part glazed door to the front leads into the hallway with stairs to the first floor accommodation. At the top of the staircase there are doors off to the kitchen and bathroom.

Lounge 12' 2" x 11' 1" (3.7m x 3.38m)

Having electric wall heater and double glazed window. Steps lead to the dining area.

Dining Area 5' 11" x 5' 8" (1.8m x 1.73m)

Double glazed window.

Kitchen 11' 1" x 8' 6" (3.38m x 2.59m)

Fitted with a range of base and wall units, work surfaces and stainless steel sink unit, drainer and mixer tap. Four ring electric hob with cooker hood over and separate electric oven. Spaces for washing machine and fridge freezer. Part tiling to the walls, electric wall heater and double glazed window.



You can reach us **9am to 9pm**, 7 days a week

28/29 High Street, Market Drayton, Shropshire, TF9 1QF

01630 658888

hellomarketdrayton@dourishandday.co.uk

Bedroom One 12' 2" x 11' 2" (3.71m x 3.4m)

A generous sized double bedroom with electric wall heater and sash bay window.

Bedroom Two 11' 2" x 8' 8" (3.4m x 2.64m)

Airing cupboard, loft access, electric wall heater and sash bay window.

Bathroom 6' 1" x 6' 4" (1.86m x 1.93m)

Fitted with a white suite comprising panel bath, pedestal wash basin with tiled splash back and low level WC. Extractor fan, electric wall heater and double glazed window with privacy glass.



GROUND FLOOR

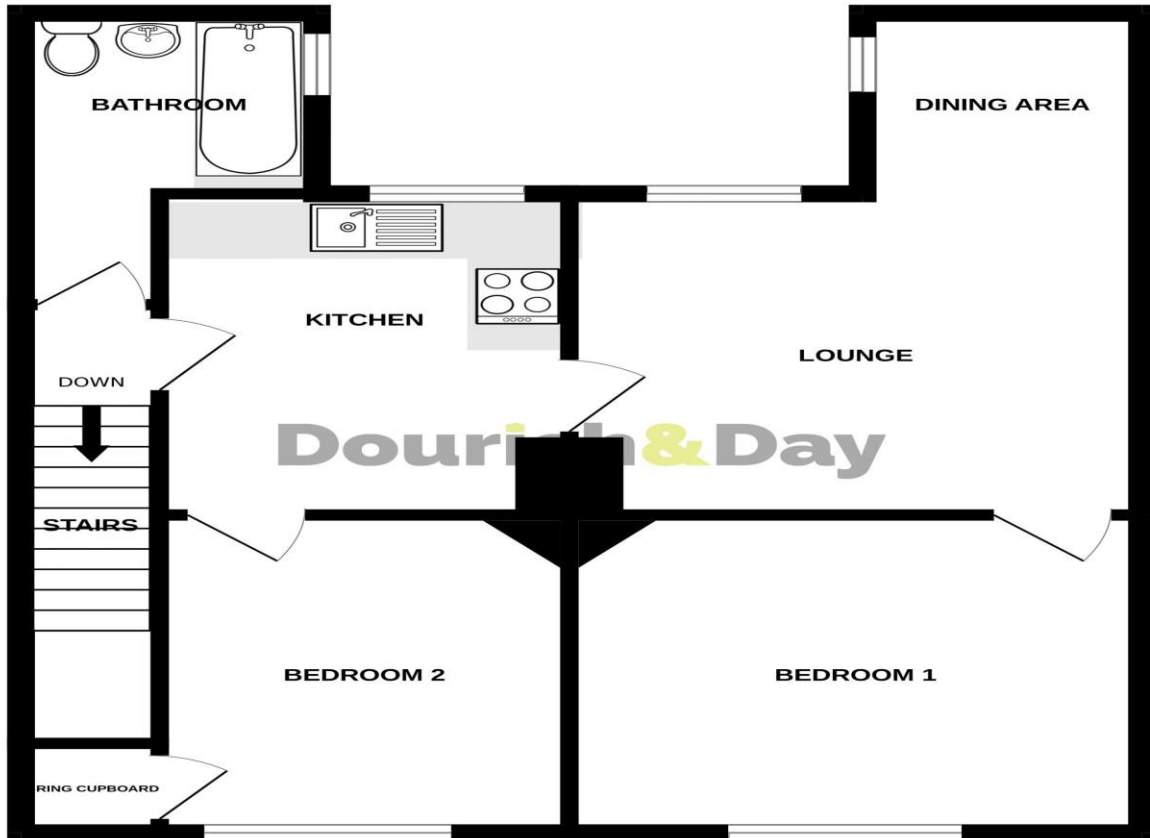

Whilst every attempt has been made to ensure the accuracy of the floorplan contained here, measurements of doors, windows, rooms and any other items are approximate and no responsibility is taken for any error, omission or mis-statement. This plan is for illustrative purposes only and should be used as such by any prospective purchaser. The services, systems and appliances shown have not been tested and no guarantee as to their operability or efficiency can be given.
Made with Metrofix ©2024



Score	Energy rating	Current	Potential
92+	A		
81-91	B		
69-80	C		69 C
55-68	D	56 D	
39-54	E		
21-38	F		
1-20	G		

IMPORTANT NOTICE Dourish & Day for themselves and for the vendor or lessors of this property whose agents they are given notice that: (i) the particulars are set out as a general outline only for the guidance of intending purchasers or lessees, and do not constitute, nor constitute part of, an offer of contract, (ii) all descriptions, dimensions, references to condition and necessary permissions for use and occupation, and other details are given in good faith and are believed to be correct but any intending purchasers or tenants should not rely on them as statement or representation of fact but must satisfy themselves by inspection or otherwise as to the correctness of each of them, (iii) no person in the employment of Dourish & Day has any authority to make or give any representation or warranty whatever in relation to this property.

You can reach us **9am to 9pm**, 7 days a week

28/29 High Street, Market Drayton, Shropshire, TF9 1QF

01630 658888

hellomarketdrayton@dourishandday.co.uk