



£650,000

🔑 TENURE: Freehold

📊 EPC RATING: D

🏠 COUNCIL TAX BAND: F

## Hookgate Market Drayton

Lovers Lane Hookgate  
Market Drayton Shropshire

🛏️ 3    🚿 1    🛋️ 3

*For those with equestrian needs or a family that is looking for a character home in the form of a farmhouse with large gardens, in a desirable rural setting then we have a treat to offer you.*

Set in 2.94 acres including two paddocks and stabling facilities and formal gardens with lots of parking the home offers lots of character throughout plus barn with potential for further development (subject to planning approval). The home comprises porch, entrance hall with WC off, spacious lounge with dual aspect including French doors to the garden, dining room with open fire with rustic brick surround and separate study. A breakfast kitchen is again a generous size and there is a separate utility. Upstairs there are three bedrooms, each with wash facilities and fabulous views plus family bathroom.

- Detached Country Cottage
- Set In Approx. 1.9 Acres of Land
- Includes Gardens, Paddocks, Barn & Stables
- Three Reception Rooms & Three Bedrooms
- Kitchen, Separate Utility & First Floor Bathroom
- Great Potential For Further Development

You can reach us **9am to 9pm**, 7 days a week

4 Crown Bridge, Penkridge, Staffordshire, ST19 5AA

**01785 715555**

hellopenkridge@dourishandday.co.uk



## **Porch Porch**

Accessed via a wooden front entrance door with engineered wood floor which continues into the inner hallway and dining room. Radiator and double glazed window to the rear.

## **Inner Hallway**

Having exposed beams to the walls and ceiling and doors off to the principle rooms.

## **Guest WC**

Fitted with a pedestal wash basin with mixer tap and splash back.

## **Lounge** 20' 2" x 10' 6" (6.15m x 3.19m)

A spacious reception room with marble fireplace, inset and hearth with exposed rustic brick inset to the chimney breast, beams to the ceiling, inset ceiling spot lighting, two radiators, double glazed bay window to the side and double glazed French doors to the rear garden.

## **Dining Room** 11' 11" x 14' 10" (3.63m x 4.51m)

A characterful room which has a rustic brick chimney with deep set open fireplace with tiled hearth and timber mantle over. There is a feature stone wall adjacent to the staircase to the first floor, radiator and double glazed window to the side and two to the front.



You can reach us **9am to 9pm**, 7 days a week

**4 Crown Bridge, Penkridge, Staffordshire, ST19 5AA**

**01785 715555**

[hellopenkridge@dourishandday.co.uk](mailto:hellopenkridge@dourishandday.co.uk)

## **Study** 8' 10" x 8' 6" (2.7m x 2.58m)

Fitted with wall shelving, radiator and double glazed window to the front.

## **Breakfast Kitchen** 20' 2" x 14' 11" (6.15m x 4.55m)

Fitted with a range of base and wall units, work surfaces to three sides, inset one and a half bowl sink unit, drainer and mixer tap. Integrated four ring electric hob with cooker hood over and eye level double oven. Further spaces for an upright fridge freezer and under counter dish washer. Double glazed windows to the side and rear.

## **Utility Room** 6' 10" x 10' 0" (2.08m x 3.04m)

Fitted with base and wall units, work surface and inset stainless steel sink unit, drainer and mixer tap. Majority tiling to the walls, spaces for a washer and dryer, radiator, stable type door to the side and double glazed window to the side.

## **First Floor Landing**

Airing cupboard and doors off to the bedrooms.

## **Bedroom One** 12' 3" x 11' 0" (3.74m x 3.36m)

A double bedroom with fitted wardrobes, recess with vanity wash basin. Radiator and double glazed windows to the front and side.

## **Bedroom Two** 12' 4" x 12' 7" (3.76m x 3.83m)

Fitted wardrobes, corner shower cubicle with electric shower, radiator and double glazed windows to the front and side.

## **Bedroom Three** 9' 9" x 11' 10" (2.97m x 3.6m)

Vanity wash basin, radiator and double glazed window to the rear.

## **Bathroom** 7' 7" x 7' 4" (2.32m x 2.24m)

Fitted with a bath with tiled surround which continues to the walls surrounding the suite area, pedestal wash basin and low level WC. Radiator and double glazed window to the rear.

## **Barn** 19' 8" x 21' 2" (6.0m x 6.45m)

There is a large barn which has a partial divide down the middle providing two areas.

## **Annexe Room** 12' 6" x 9' 9" (3.8m x 2.98m)

Linked to the barn is a room currently utilised as a bedroom with shower room off and has a electric wall heaters and window.

## **Annexe Shower Room**

Fitted with a shower cubicle with electric shower, pedestal wash basin and low level WC.

## **Grounds**

The home sits in approximately 2.94 acre of formal gardens and two paddocks including one to the front fronting the roadside and the second to the rear adjacent to Lovers Lane. There is also a stabling facility for equestrian requirements and the barn offers the potential of further development. The formal gardens include lawns with a variety of established planted areas.

## **Agents Note(s):**

The hot water is provided by oil central heating. Drainage is to a septic tank.



GROUND FLOOR

1ST FLOOR

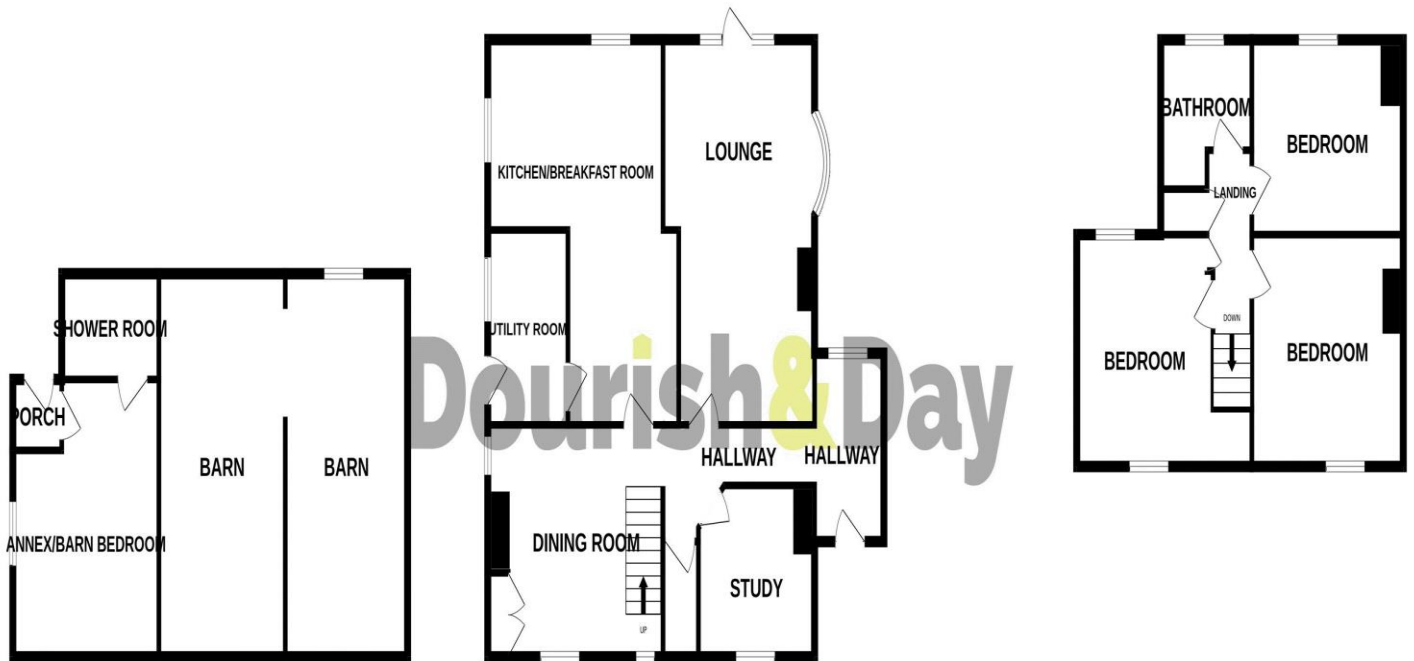

Whilst every attempt has been made to ensure the accuracy of the floorplan contained here, measurements of doors, windows, rooms and any other items are approximate and no responsibility is taken for any error, omission or mis-statement. This plan is for illustrative purposes only and should be used as such by any prospective purchaser. The services, systems and appliances shown have not been tested and no guarantee as to their operability or efficiency can be given.  
Made with Metropix ©2024

Energy Efficiency Rating		Current	Potential
Energy efficient - lower running costs			
(92+)	A		
(81-91)	B		
(69-80)	C		79
(55-68)	D		
(39-54)	E	55	
(15-38)	F		
(1-14)	G		
EU energy efficient - higher rental rates			
England & Wales		EU Directive 2002/91/EC	
www.epc.org.uk			



**IMPORTANT NOTICE** Dourish & Day for themselves and for the vendor or lessors of this property whose agents they are given notice that: (i) the particulars are set out as a general outline only for the guidance of intending purchasers or lessees, and do not constitute, nor constitute part of, an offer of contract, (ii) all descriptions, dimensions, references to condition and necessary permissions for use and occupation, and other details are given in good faith and are believed to be correct but any intending purchasers or tenants should not rely on them as statement or representation of fact but must satisfy themselves by inspection or otherwise as to the correctness of each of them, (iii) no person in the employment of Dourish & Day has any authority to make or give any representation or warranty whatever in relation to this property.

You can reach us **9am to 9pm, 7 days a week**

**4 Crown Bridge, Penkridge, Staffordshire, ST19 5AA**

**01785 715555**

hellopenkridge@dourishandday.co.uk