



EVANS  
ESTATES



## Smorrall Lane , Bedworth, CV12 0JP Offers over £375,000

Nestled on the desirable Smorrall Lane in Bedworth, this extended detached residence presents a wonderful opportunity for families seeking a spacious and comfortable home. The property is conveniently located, providing easy access to Bedworth, Coventry, and the M6 motorway network, making it ideal for commuters.

Upon entering, you are greeted by a welcoming reception hall that leads to a generous lounge, perfect for relaxation and entertaining. The family room, which, offers a unique space for leisure and enjoyment. The breakfast kitchen is well-appointed, providing a delightful area for family meals, while the utility room and guest cloakroom/shower room add to the practicality of the home.

The first floor comprises a landing that leads to three well-proportioned bedrooms, ensuring ample space for family living. The family bathroom is conveniently located to serve all bedrooms.

Externally, the property boasts a double garage with useful loft space, providing additional storage or potential for conversion. The in-and-out driveway enhances accessibility, while the larger than average rear garden offers a private outdoor retreat, perfect for children to play or for hosting summer gatherings.

- Three Bedrooms
- Refitted Ground Floor Shower Room
- Extensive Rear Garden
- Off Road Parking

### Viewing

Please contact our Evans Estates Office on 02476333363 if you wish to arrange a viewing appointment for this property or require further information.



3



2



3





Floor Plan

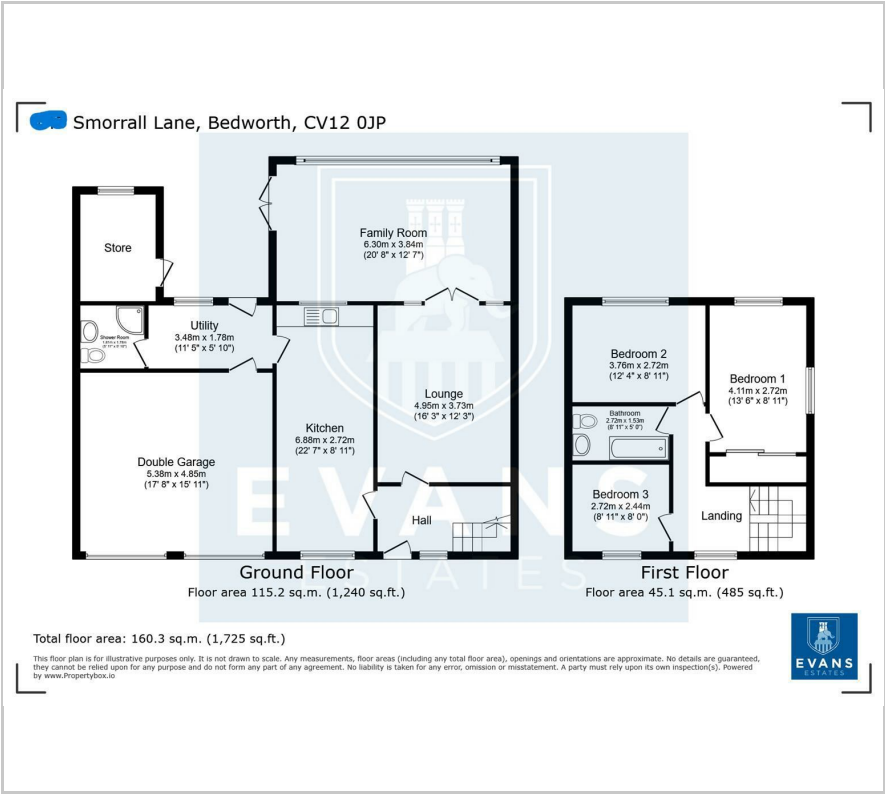

Area Map



Energy Efficiency Graph



These particulars, whilst believed to be accurate are set out as a general outline only for guidance and do not constitute any part of an offer or contract. Intending purchasers should not rely on them as statements of representation of fact, but must satisfy themselves by inspection or otherwise as to their accuracy. No person in this firms employment has the authority to make or give any representation or warranty in respect of the property.