

EVANS
ESTATES



Rookery Lane , Coventry, CV6 4GQ Offers over £200,000

Evans Estates is delighted to present this charming three-bedroom Semi Detached family home, ideally located on Rookery Lane in the desirable Holbrooks area of Coventry. This property is offered with no upward chain, making it an excellent opportunity for those looking to move in without delay.

The home benefits from double glazing and gas central heating, ensuring comfort throughout the seasons. Upon entering, you are welcomed by a spacious entrance hall that leads to a well-proportioned lounge, perfect for relaxation and family gatherings. Adjacent to the lounge is a dining room, providing an inviting space for meals and entertaining. The kitchen is conveniently situated, offering practicality for everyday living.

On the first floor, you will find three generous bedrooms, each providing ample space for family members or guests. The family bathroom is also located on this level, designed to cater to the needs of a busy household.

Externally, the property boasts a lovely rear garden, ideal for outdoor activities, gardening, or simply enjoying the fresh air. Additionally, there are two allocated parking spaces at the front of the house, providing convenience for residents and visitors alike.

- No Upward Chain
- Extensive Rear Garden
- Two Allocated Parking Spaces
- Three Bedrooms

Viewing

Please contact our Evans Estates Office on 02476333363 if you wish to arrange a viewing appointment for this property or require further information.



Floor Plan

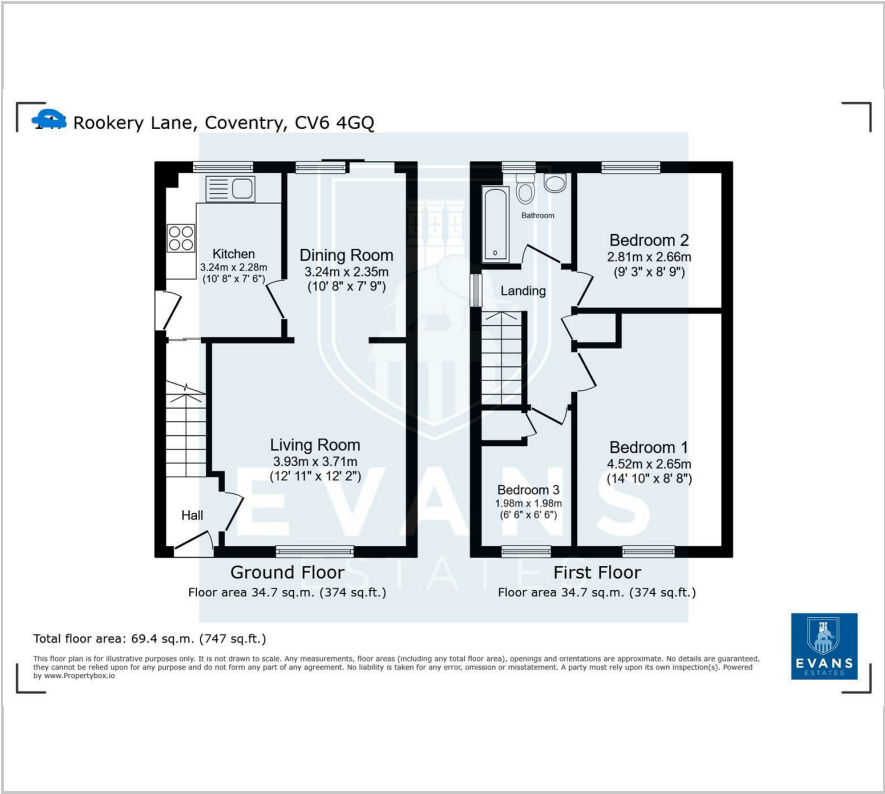

Area Map



Energy Efficiency Graph

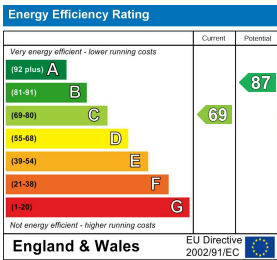

These particulars, whilst believed to be accurate are set out as a general outline only for guidance and do not constitute any part of an offer or contract. Intending purchasers should not rely on them as statements of representation of fact, but must satisfy themselves by inspection or otherwise as to their accuracy. No person in this firms employment has the authority to make or give any representation or warranty in respect of the property.