



**EVANS**  
ESTATES



**EVANS**  
ESTATES

## Farm Close , Coventry, CV6 2GD Offers over £210,000

Nestled in the desirable area of Keresley, Coventry, this charming mid-terrace family home on Farm Close is a splendid opportunity for those seeking a comfortable and convenient living space. Offered with no upward chain, this property is ready for you to make it your own.

Upon entering, you are welcomed by a spacious entrance hall that leads to two inviting reception rooms, perfect for both relaxation and entertaining. The lounge provides a warm and cosy atmosphere, while the dining room offers an ideal setting for family meals and gatherings. The refitted kitchen is both functional and stylish, catering to all your culinary needs, and is complemented by a convenient ground floor shower room.

As you ascend to the first floor, you will find three well-proportioned bedrooms, each offering ample space for rest and personalisation. The family bathroom is thoughtfully designed, ensuring comfort for all members of the household.

This property benefits from double glazing and gas central heating, providing warmth and energy efficiency throughout the year. Its location within the catchment area of The President Kennedy School adds to its appeal, making it an excellent choice for families.

- No Upward Chain
- Lounge and Dining Room
- Refitted Kitchen
- Ground Floor Shower Room

### Viewing

Please contact our Evans Estates Office on 02476333363 if you wish to arrange a viewing appointment for this property or require further information.



3



2



2



C



Floor Plan

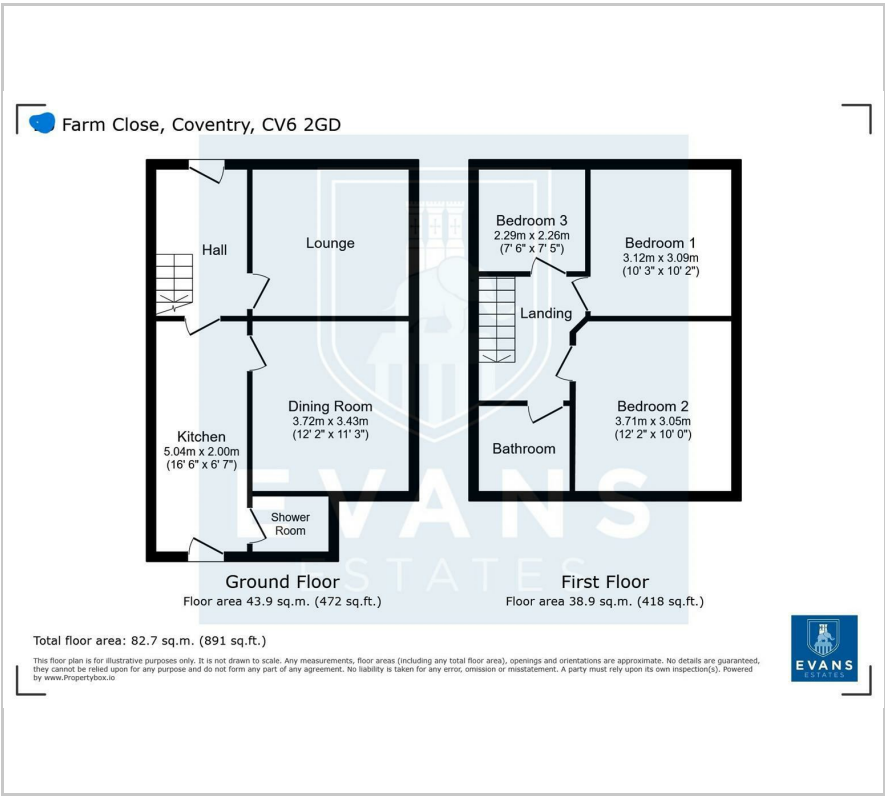

Area Map



Energy Efficiency Graph

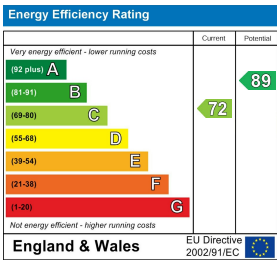

These particulars, whilst believed to be accurate are set out as a general outline only for guidance and do not constitute any part of an offer or contract. Intending purchasers should not rely on them as statements of representation of fact, but must satisfy themselves by inspection or otherwise as to their accuracy. No person in this firms employment has the authority to make or give any representation or warranty in respect of the property.