



EVANS
ESTATES



EVANS
ESTATES

Tackford Road , Coventry, CV6 7HT Offers over £210,000

Evans estates is very proud to present this charming end of terrace house, ideally situated in a location with easy access to public transport links and nearby schools. The property, which is in good condition, features a generous layout with three bedrooms and two bathrooms catering to all your family's needs.

The highlight of the house is its well-appointed open-plan kitchen, which offers a dining space and is bathed in natural light, making it the perfect place to enjoy meals and entertain guests. The property also boasts a single reception room, offering a cosy space for relaxation and family time.

Additional features include an extension and a convenient downstairs toilet, providing you extra space and functionality to suit your lifestyle. This property is ideal for first-time buyers, investors, and families looking for a comfortable and homely setting in a favourable location.

In summary, this home provides a wonderful opportunity to acquire a well-maintained property, offering both comfort and convenience. Offering space, light and practicality, this property is waiting for you to make it your own. Don't miss out on this fantastic opportunity, contact us today to arrange a viewing.

Viewing

Please contact our Evans Estates Office on 02476333363 if you wish to arrange a viewing appointment for this property or require further information.



3



2



1



10+

Floor Plan

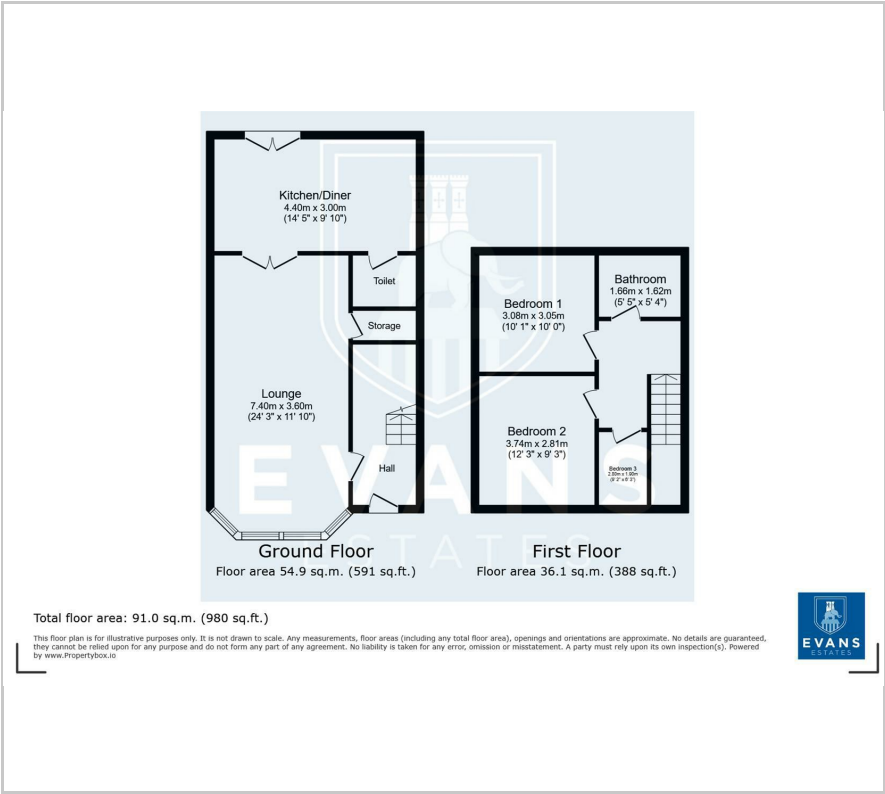

Area Map

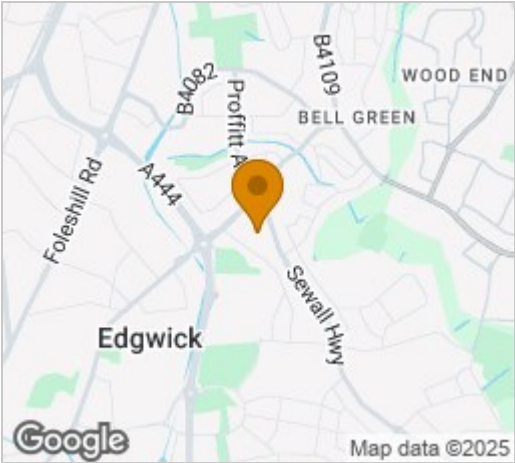

Energy Efficiency Graph

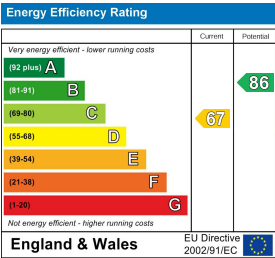

These particulars, whilst believed to be accurate are set out as a general outline only for guidance and do not constitute any part of an offer or contract. Intending purchasers should not rely on them as statements of representation of fact, but must satisfy themselves by inspection or otherwise as to their accuracy. No person in this firms employment has the authority to make or give any representation or warranty in respect of the property.