

Overslade Crescent , Coventry, CV6 2AU Offers over £260,000

Evans Estates are Very Proud to Present this Extended Family Home. The property is situated in the Coundon area of the city and has the benefits of double glazing and gas central heating (as specified). The accommodation comprises of an entrance hall, ground floor wc and through lounge diner. There is an extended refitted kitchen diner and utility room. To the first floor there are three bedrooms and a refitted family bathroom. Externally there is a rear landscaped garden and a hard standing to the front. The front aspect is a lovely green.

Viewing

Please contact our Evans Estates Office on 02476333363 if you wish to arrange a viewing appointment for this property or require further information.

- Stunning Extended Family Home
- Ground Floor WC
- Utility Room
- Extended Kitchen Diner
- Refitted Family Bathroom



Floor Plan

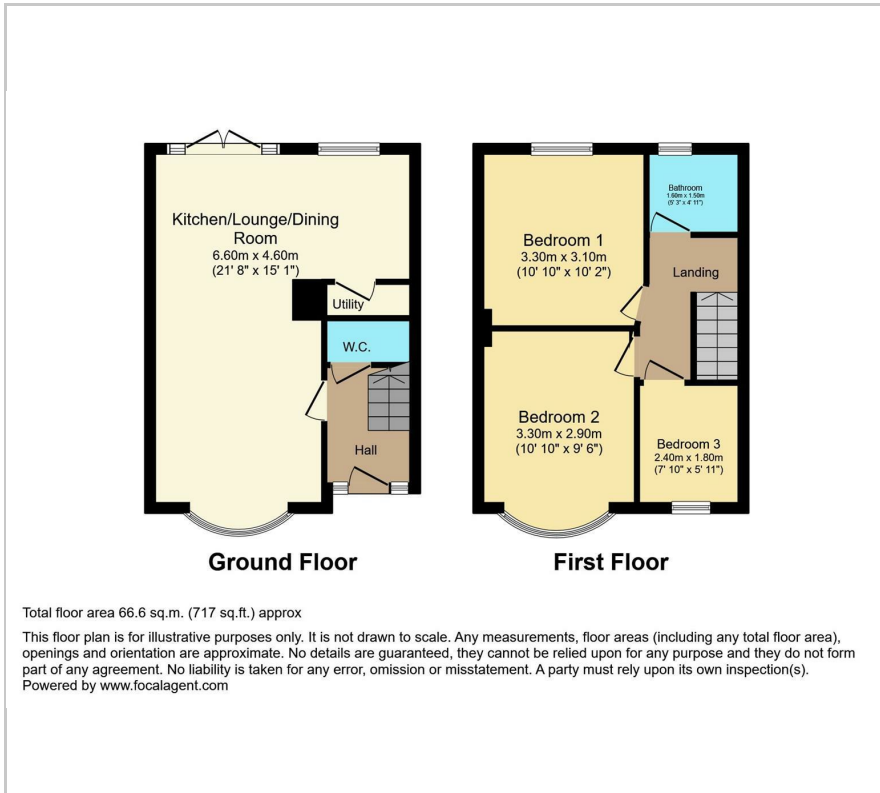

Area Map

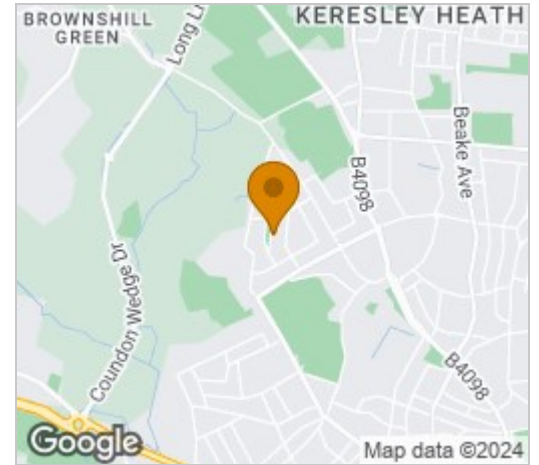

Energy Efficiency Graph

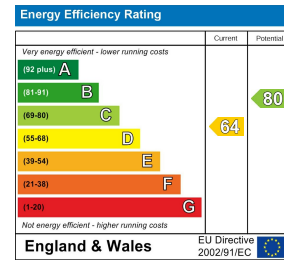

These particulars, whilst believed to be accurate are set out as a general outline only for guidance and do not constitute any part of an offer or contract. Intending purchasers should not rely on them as statements of representation of fact, but must satisfy themselves by inspection or otherwise as to their accuracy. No person in this firm's employment has the authority to make or give any representation or warranty in respect of the property.

47 Headington Avenue, Coventry, West Midlands, CV6 2GX

Tel: 02476333363 Email: info@evans-estates.co.uk <https://www.evans-estates.co.uk>