



## Scholfield Road

Keresley End, Coventry, CV7 8LJ

Offers over £200,000

Evans Estates are Very Proud to Present this Three Bedroom Semi Detached Family Home Offered with No Upward Chain. The property has the benefits of double glazing and gas central heating (as specified) and is situated in the Keresley End area of the city. The accommodation comprises of an entrance hall, lounge, kitchen diner, ground floor shower room and conservatory. To the first floor there are three bedrooms and a shower room. Externally there are gardens to the front and rear with gated off road parking to the front.

- Semi Detached Family Home
- Lounge and Kitchen Diner
- Ground Floor Shower Room
- Conservatory
- Gated Off Road Parking

### Viewing

Please contact our Evans Estates Office on 02476333363 if you wish to arrange a viewing appointment for this property or require further information.



3



2



2



D



## Floor Plan

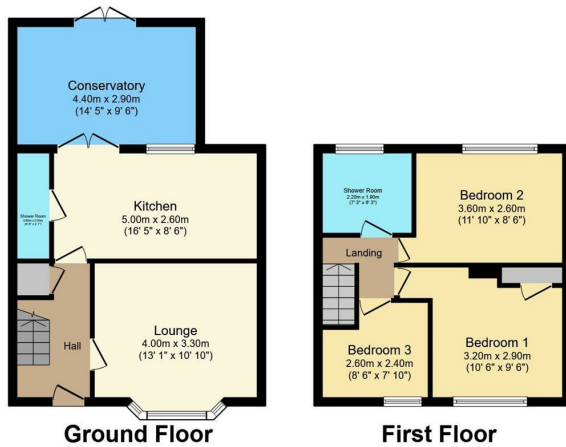

Total floor area 85.1 m<sup>2</sup> (916 sq.ft.) approx

This floor plan is for illustrative purposes only. It is not drawn to scale. Any measurements, floor areas (including any total floor area), openings and orientation are approximate. No details are guaranteed, they cannot be relied upon for any purpose and they do not form part of any agreement. No liability is taken for any error, omission or misstatement. A party must rely upon its own inspection(s).

Powered by [www.focalagent.com](http://www.focalagent.com)

## Area Map



## Energy Efficiency Graph

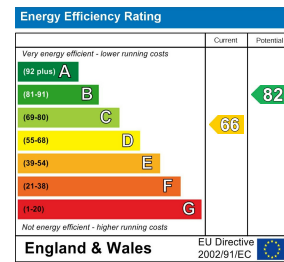

These particulars, whilst believed to be accurate are set out as a general outline only for guidance and do not constitute any part of an offer or contract. Intending purchasers should not rely on them as statements of representation of fact, but must satisfy themselves by inspection or otherwise as to their accuracy. No person in this firm's employment has the authority to make or give any representation or warranty in respect of the property.

47 Headington Avenue, Coventry, West Midlands, CV6 2GX

Tel: 02476333363 Email: [info@evans-estates.co.uk](mailto:info@evans-estates.co.uk) <https://www.evans-estates.co.uk>