



EVANS  
ESTATES



## Whitmore Manor Close , Coventry, CV6 2PH Offers over £260,000

Evans Estates are Very Proud to Present this Very Well Presented Town House Offered with No Upward Chain. The property is situated in the Whitmore Park area of the city and within The President Kennedy School Catchment. The property has the benefits of double glazing and gas central heating (as specified). The accommodation comprises of an entrance hall, ground floor cloakroom, kitchen diner and lounge. To the first floor there are two bedrooms and a family bathroom. To the second floor there is a master bedroom with en suite shower room. Externally there are gardens to the front and rear with off road parking.

- No Upward Chain
- Well Presented Town House
- Master Bedroom with En Suite
- Ground Floor Cloakroom
- Off Road Parking

### Viewing

Please contact our Evans Estates Office on 02476333363 if you wish to arrange a viewing appointment for this property or require further information.



3



2



2



B

## Floor Plan

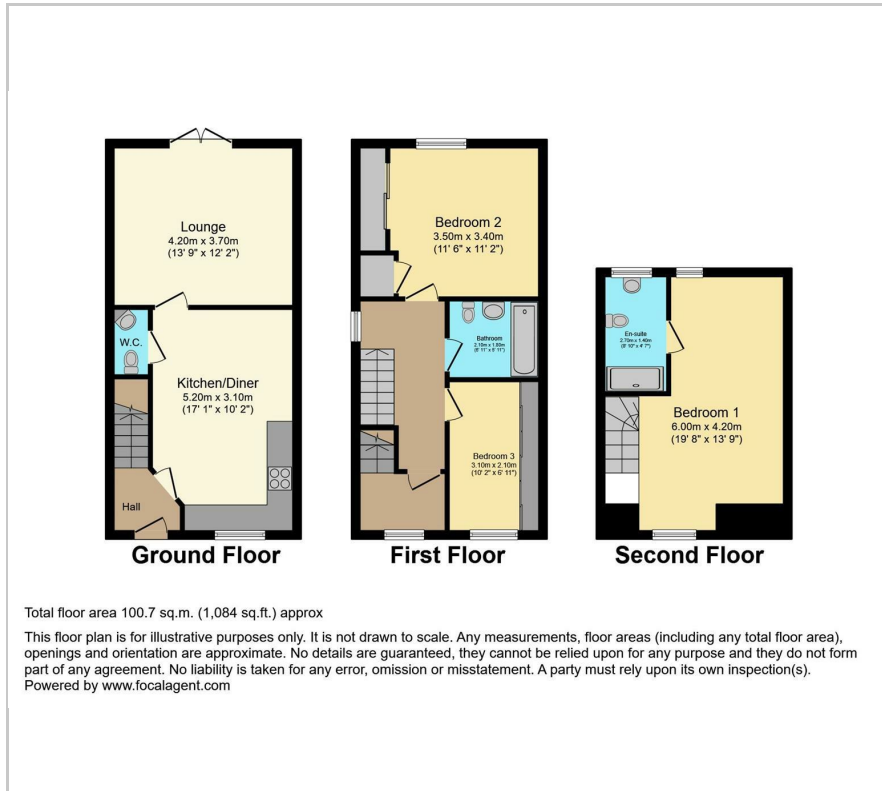

## Area Map



## Energy Efficiency Graph

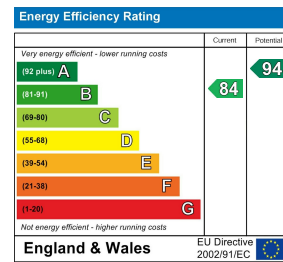

These particulars, whilst believed to be accurate are set out as a general outline only for guidance and do not constitute any part of an offer or contract. Intending purchasers should not rely on them as statements of representation of fact, but must satisfy themselves by inspection or otherwise as to their accuracy. No person in this firm's employment has the authority to make or give any representation or warranty in respect of the property.

47 Headington Avenue, Coventry, West Midlands, CV6 2GX  
Tel: 02476333363 Email: info@evans-estates.co.uk <https://www.evans-estates.co.uk>