

180 Totterdown Street

, London, SW17 8TD

£2,600 Per month

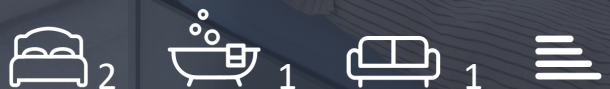

Floor Plan

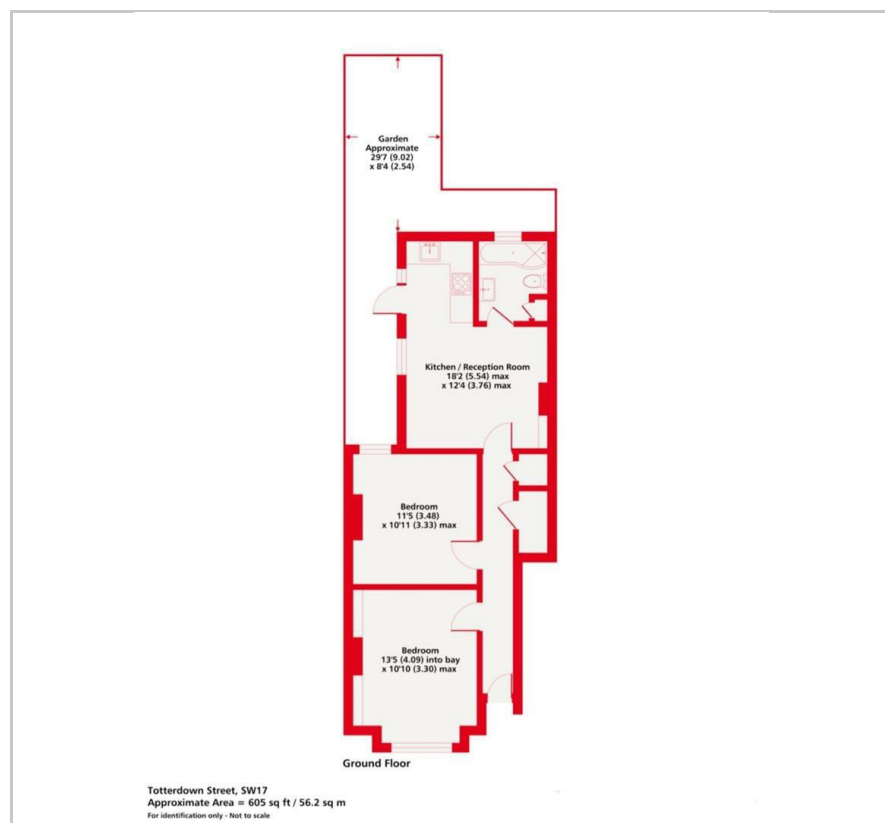

Area Map

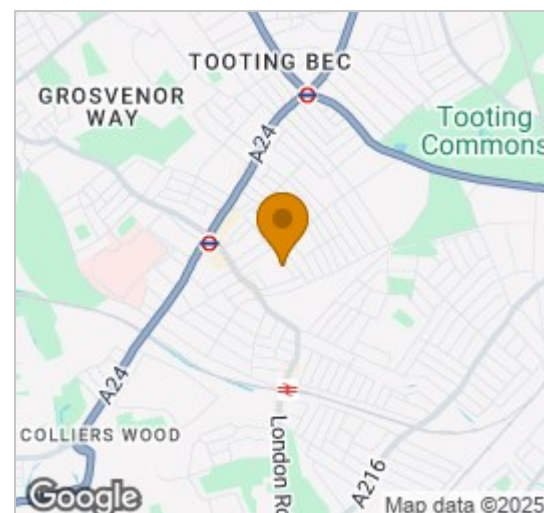

Energy Efficiency Graph

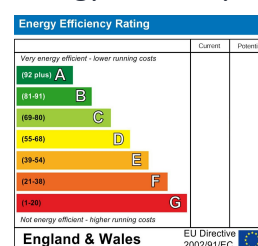

Viewing

Please contact our Head Office Office on 07561471669 if you wish to arrange a viewing appointment for this property or require further information.

- Two Double Bedrooms
- Available Early September
- South West Facing Garden
- Furnished
- Excellent Condition
- Moments From Tooting Broadway Station



A charming and sophisticated two double bedroom ground floor garden maisonette available to rent furnished. Conveniently located within moments of Tooting Broadway underground station and amenities.

This stylish home offers 605 sq ft of accommodation comprising of two genuine double bedrooms, reception room, beautiful kitchen and modern bathroom. The property benefits further from a South Westerly facing rear garden.



These particulars, whilst believed to be accurate are set out as a general outline only for guidance and do not constitute any part of an offer or contract. Intending purchasers should not rely on them as statements of representation of fact, but must satisfy themselves by inspection or otherwise as to their accuracy. No person in this firm's employment has the authority to make or give any representation or warranty in respect of the property.

4-5 Gough Square, London, EC4A 3DE

Tel: 07561471669 Email: tim@threesixtyproperty.co.uk <https://www.threesixtyproperty.co.uk>