



Flat 12, 119 Eloise House Portland Road

, London, SE25 4UN

£330,000



1



1



1



Floor Plan

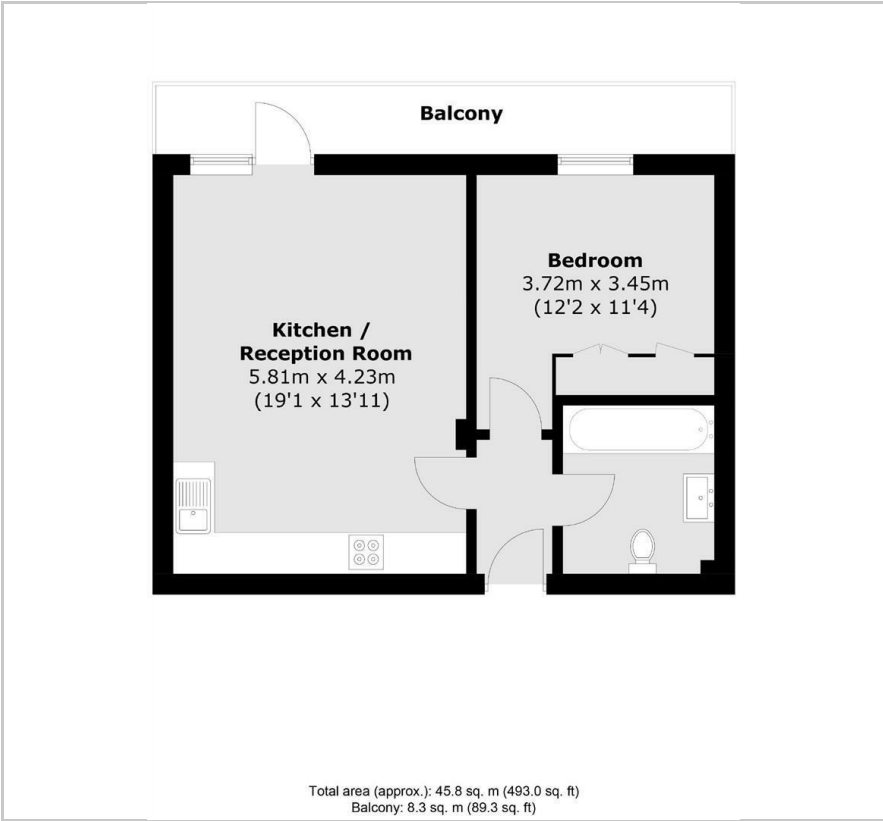

Area Map

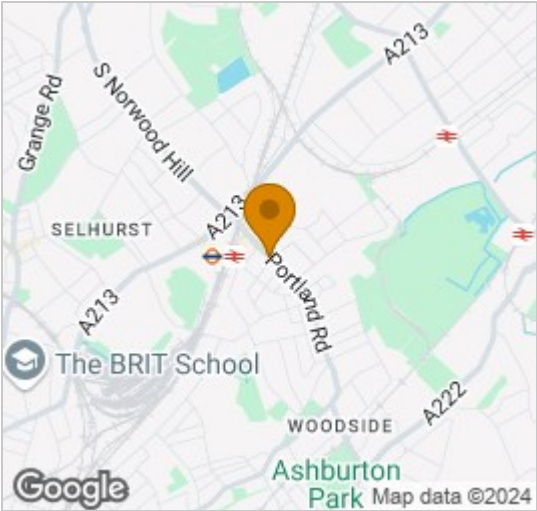

Energy Efficiency Graph

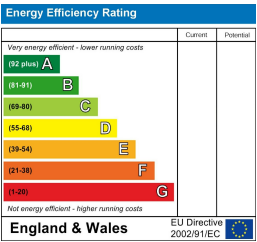

Viewing

Please contact our Head Office Office on 07561471669 if you wish to arrange a viewing appointment for this property or require further information.

- 493 sqft / 45.8 sqm
- Built in wardrobes
- Lift access
- Moments from Norwood Junction Station
- Large one bedroom apartment
- Never been lived in before apartment
- New private development
- 12 minutes to London Bridge Station



This spacious, brand-new one-bedroom apartment offers 493 sq. ft. (45.8 sqm) of comfortable, contemporary living space and is available to for sale through Three Sixty Property.

Situated in the exclusive boutique development of Eloise House, the apartment boasts a thoughtfully designed interior, complete with built-in wardrobes in the bedroom and a private terrace with peaceful rear views of the development.

Eloise House offers an ideal location in the vibrant South Norwood community, surrounded by a variety of shops, cafés, and local amenities. For commuters, Norwood Junction station is just 0.2 miles away, providing a convenient 12-minute direct train to London Bridge



These particulars, whilst believed to be accurate are set out as a general outline only for guidance and do not constitute any part of an offer or contract. Intending purchasers should not rely on them as statements of representation of fact, but must satisfy themselves by inspection or otherwise as to their accuracy. No person in this firms employment has the authority to make or give any representation or warranty in respect of the property.