



Flat 19, 119, Eloise House Portland Road

, London, SE25 4UN

£449,995



Floor Plan

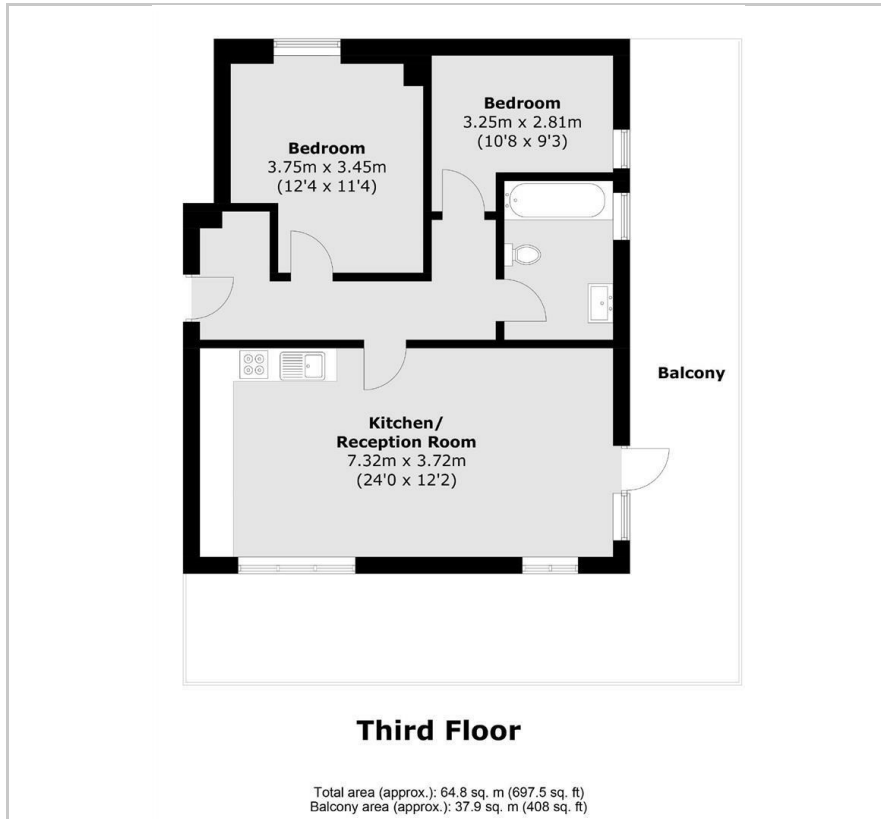

Area Map



Energy Efficiency Graph

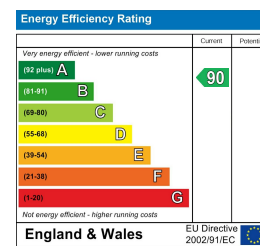

Viewing

Please contact our Head Office Office on 07561471669 if you wish to arrange a viewing appointment for this property or require further information.

- 697.5 sqft / 64.8 sqm
- 2 Double Bedroom Apartment
- Large wrap around roof terrace
- Top Floor
- New Development
- Available Start of December
- Moments From Norwood Junction Station
- Lift Access

Top floor, never been lived in, new and expertly crafted 697.5 sqft / 64.8 sqm 2 bedroom, 1 bathroom apartment with generously sized wrap around roof terrace available for sale with Three Sixty Property.

A well proportioned two bedroom, one bathroom apartment on the third floor of this newly built development with wrap around roof terrace with views over London.

Set in the heart of South Norwood, this boutique development has only 19 units offering a mixture of 1, 2 & 3 bedroom apartments. Eloise House is set in a thriving local community with an abundance of shops close by, Norwood Junction is 0.2 miles away with a 12 minute train ride into London Bridge.

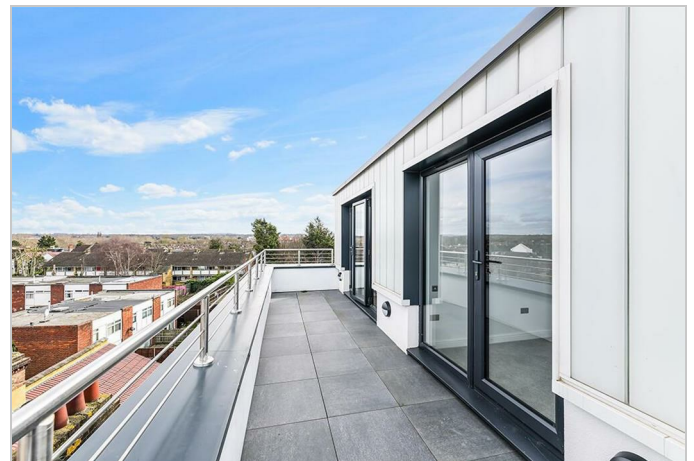

These particulars, whilst believed to be accurate are set out as a general outline only for guidance and do not constitute any part of an offer or contract. Intending purchasers should not rely on them as statements of representation of fact, but must satisfy themselves by inspection or otherwise as to their accuracy. No person in this firm's employment has the authority to make or give any representation or warranty in respect of the property.

4-5 Gough Square, London, EC4A 3DE

Tel: 07561471669 Email: tim@threesixtyproperty.co.uk <https://www.threesixtyproperty.co.uk>