



Flat 6, 119 Eloise House Portland Road

, London, SE25 4UN

Asking price £500,000





## Floor Plan

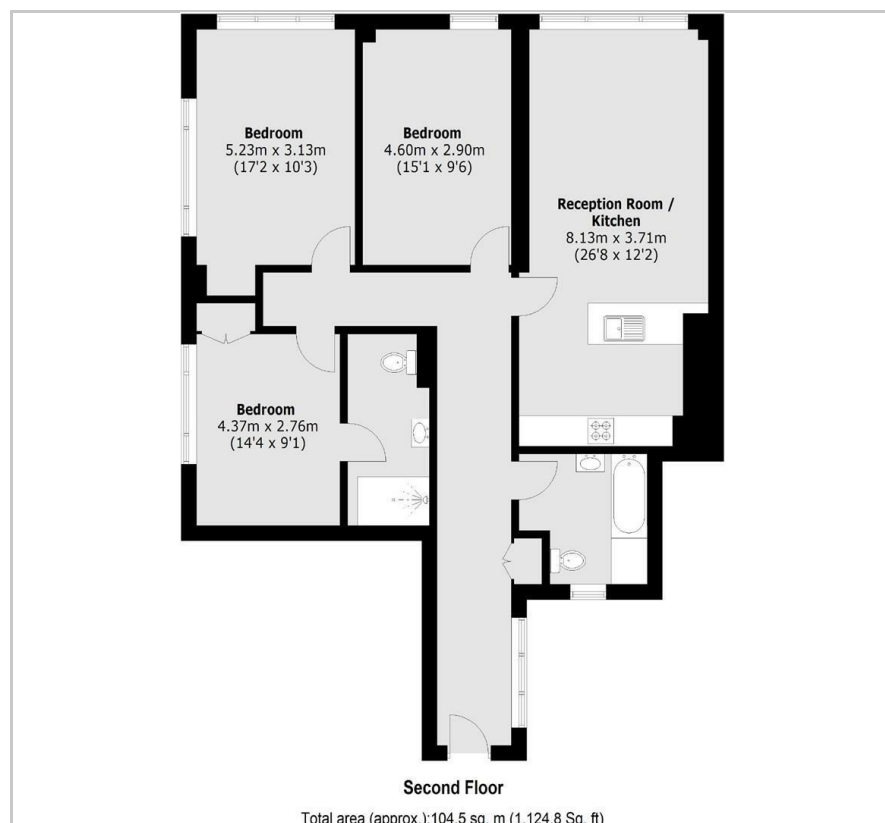

## Area Map

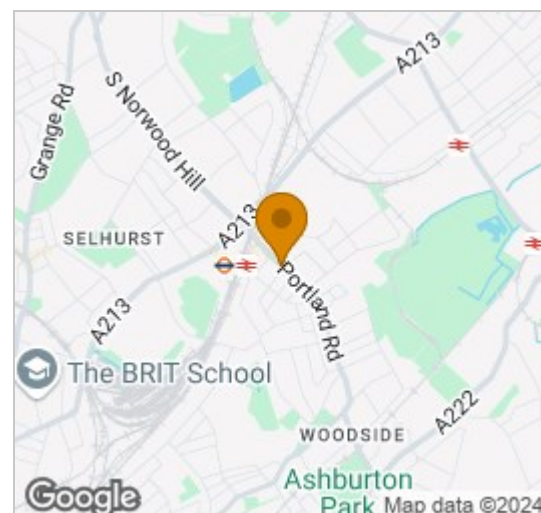

## Energy Efficiency Graph

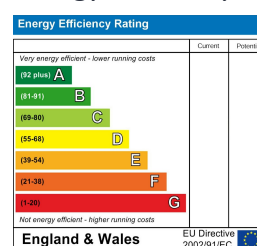

## Viewing

Please contact our Head Office Office on 07561471669 if you wish to arrange a viewing appointment for this property or require further information.

- 1125 sqft / 104.5 sqm
- 2 bathrooms
- Large living space, lots of natural light
- Lift Access
- Moments from Norwood Junction Station
- Large 3 double bedroom apartment
- Fitted Wardrobes
- Never been lived in before apartment
- Private Development



Large lateral, never been lived in before, new and expertly crafted 1124.8 sqft / 104.5sqm 3 bedroom, 2 bathroom apartment available for sale with Three Sixty Property.

A well proportioned three double bedroom (two with fitted wardrobes), two bathroom apartment on the second floor of this newly built development.

Set in the heart of South Norwood, this boutique development has only 19 units offering a mixture of 1, 2 & 3 bedroom apartments. Eloise House is set in a thriving local community with an abundance of shops close by, Norwood Junction is 0.2 miles away with a 12 minute train ride into London Bridge.



These particulars, whilst believed to be accurate are set out as a general outline only for guidance and do not constitute any part of an offer or contract. Intending purchasers should not rely on them as statements of representation of fact, but must satisfy themselves by inspection or otherwise as to their accuracy. No person in this firm's employment has the authority to make or give any representation or warranty in respect of the property.

4-5 Gough Square, London, EC4A 3DE

Tel: 07561471669 Email: [tim@threesixtyproperty.co.uk](mailto:tim@threesixtyproperty.co.uk) <https://www.threesixtyproperty.co.uk>