



## 23 William Wailes Walk, Gateshead, NE9 5EW

**£895**

A modern top floor apartment with panoramic views across Saltwell Park.... Available immediately, Unfurnished

Bell Estate Agents are pleased to welcome to the market this unique top floor apartment with a wrap around balcony offering excellent views across Saltwell Park and Gateshead. The internal accommodation briefly comprises of a communal entrance with lift providing access to all levels. Moving inside the apartment there is an L Shape hallway leading to two bedrooms both with balcony access, a family bathroom with shower over bath and open plan living space, offering a fitted kitchen with integrated appliances.

Parking is provided via an allocated space in the secure garage situated in the basement of the apartment block. Viewings are highly recommended.





Floor Plan

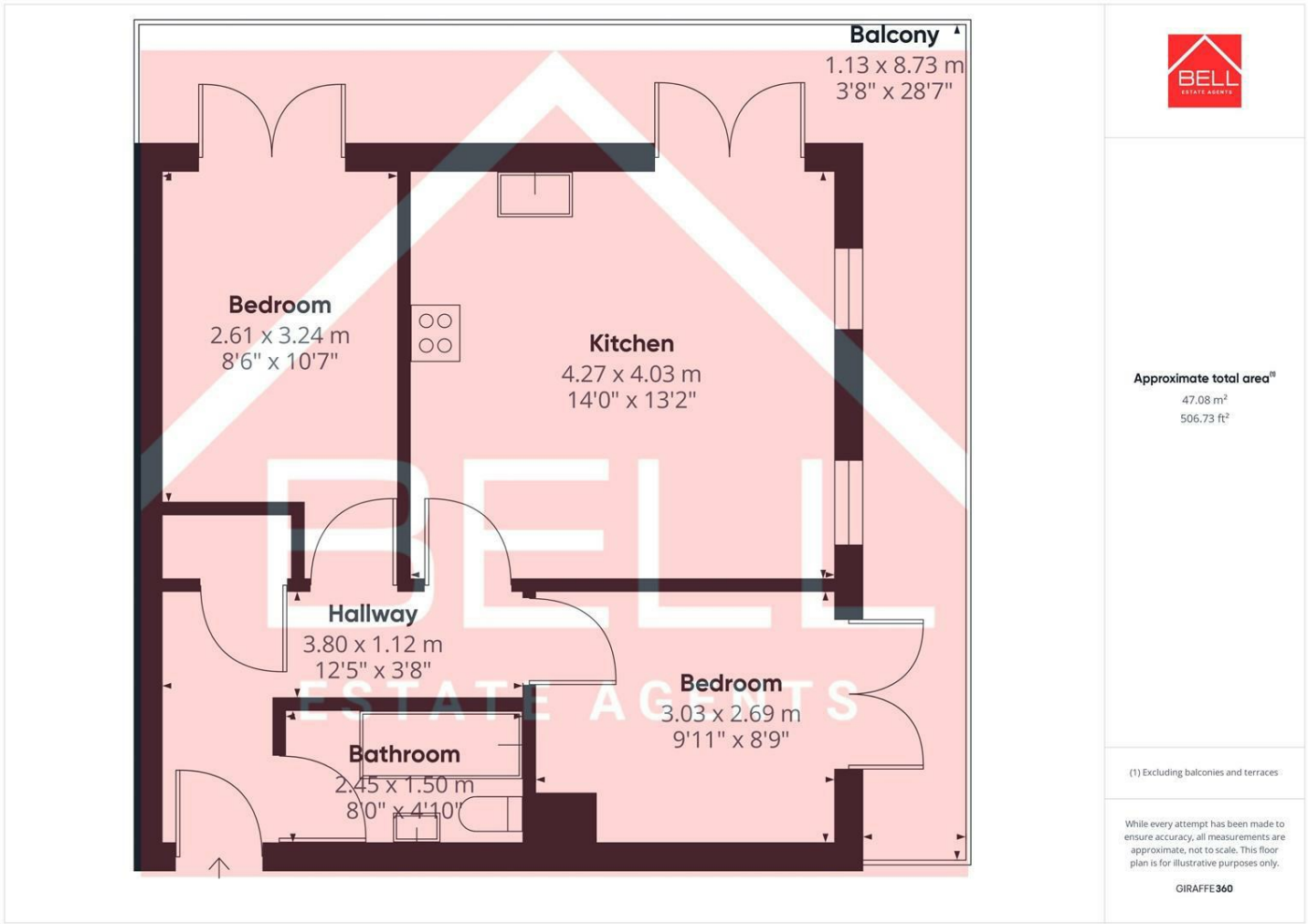

Area Map



Energy Efficiency Graph

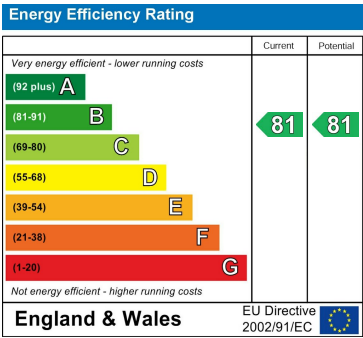

These particulars, whilst believed to be accurate are set out as a general outline only for guidance and do not constitute any part of an offer or contract. Intending purchasers should not rely on them as statements of representation of fact, but must satisfy themselves by inspection or otherwise as to their accuracy. No person in this firms employment has the authority to make or give any representation or warranty in respect of the property.