



FOR SALE



11 Trigo House, Worsdell Drive, Gateshead, NE8 2DA

Offers Over £158,000

- Balcony
- Open Plan Living Space
- Secure Communal Entrance
- Two Bathrooms
- EPC Rating - C
- Second Floor Apartment
- Grey Open Plan Fitted Kitchen
- Allocated Parking Space
- Two Double Bedrooms
- Viewings Highly Recommended

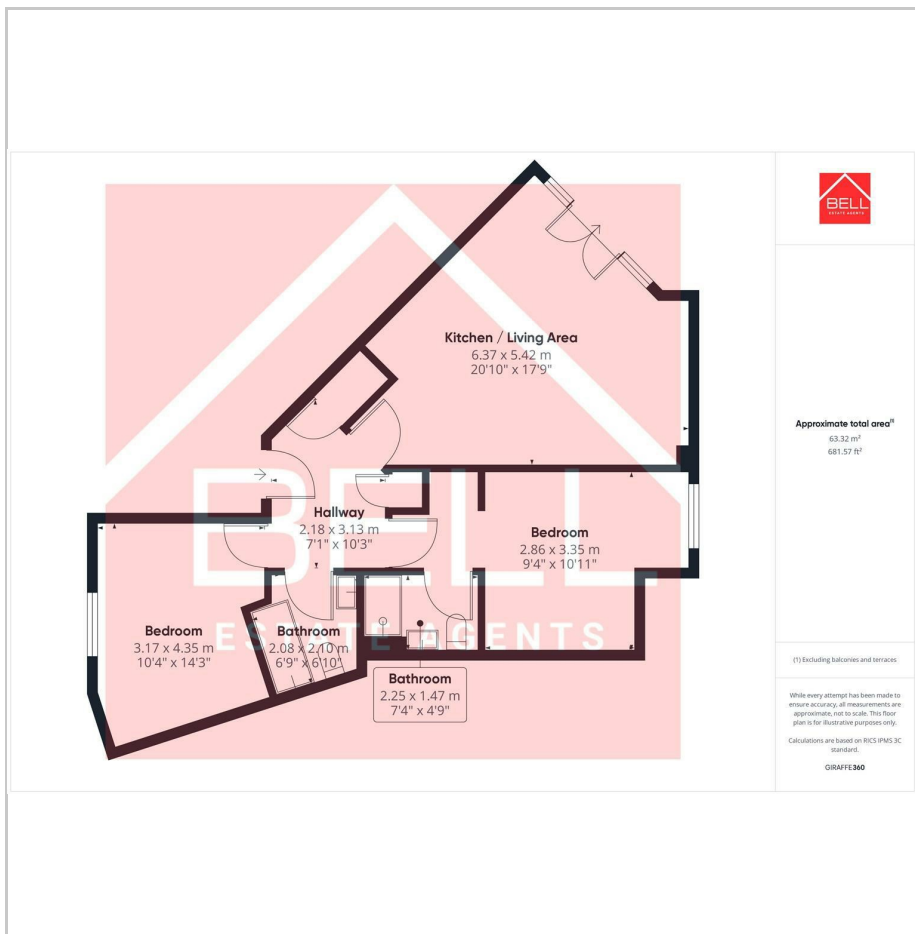

THE PROPERTY

Bell Estate Agents are pleased to welcome to the market this modern apartment situated within the prestigious Worsdell Drive which is less than two miles from Newcastle. The internal accommodation briefly comprises of a secure communal entrance with an elevator/stairs that can be used to access the first floor. Entering into the apartment is a lobby with spotlights. Moving on there is an open plan lounge/kitchen/dining room with modern fitted kitchen with integrated appliances and a Balcony accessed via french doors. The property also has two double bedrooms, the master suite of which has a part tiled shower room. Completing the layout is a three piece family bathroom which is again part tiled with a shower over bath. Parking is available via an allocated parking space. Viewings are highly recommended.

The Quayside is an area along the banks of the River Tyne in Newcastle upon Tyne and Gateshead. The area was once an industrial area and busy commercial dockside, while the Newcastle side also hosted a regular street market. In recent years the docks have closed and the area has since been heavily redeveloped to provide a contemporary lively environment for the modern arts, music and culture, as well as new housing developments. The Newcastle Gateshead initiative now lists the Quayside as a top ten attraction, with it becoming one of the most popular areas in Newcastle and Gateshead. Along the Newcastle side is an area that houses restaurants, bars and night clubs, as well as housing developments and the Newcastle Law Courts. Each Sunday there is an artisan market on Newcastle Quayside, with a vibrant variety of crafts, produce and food stalls. The Gateshead side of the river is designated and signposted as Gateshead Quays. It is the site of the BALTIC Centre for Contemporary Art and The Sage Gateshead performing arts and conference centre. Gateshead also has the Gateshead Riverside walk, which is a promenade right on the waterfront with breathtaking views.

