

1 Rosefinch Lodge Beaconsfield Road, Gateshead, NE9 5EU

£42,500

- 70% Shared Ownership
- Sought After Central Low Fell Location
- Shower Room
- Lift Service
- Viewings Highly Recommended
- Ground Floor
- Double Bedroom
- Secure Communal Entrance
- Private Parking
- Retirement Flat for Over 55's

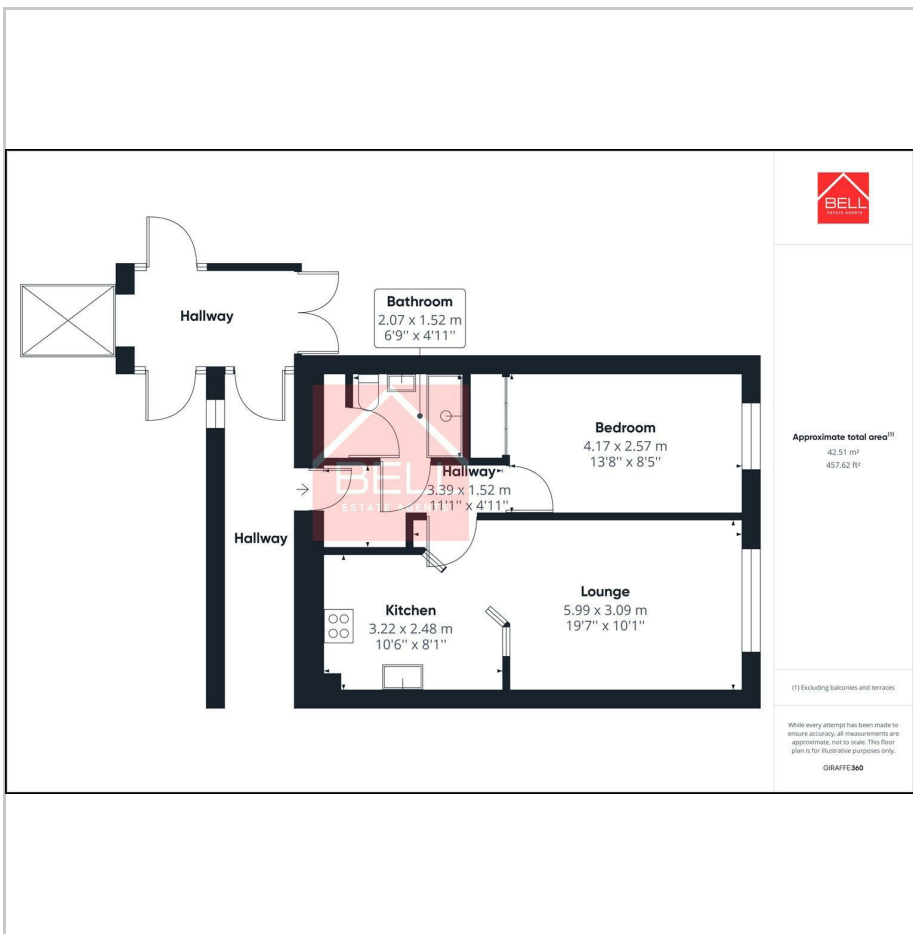

THE PROPERTY

Bell Estate Agents are pleased to welcome to the market this bottom floor over 55's retirement apartment situated in the centre of Low Fell...

Rosefinch lodge is a centrally located apartment situated on the ground floor. The apartment is offered for sale with a 70% shared ownership with Karbon Homes. The internal accommodation briefly comprises of a communal entrance lobby with stairs and lift to all levels. Stepping into the apartment the layout comprises of an entrance lobby leading to a modern shower room with storage cupboard, a double bedroom with integrated storage, a well kept lounge area with feature fireplace and a L shape kitchen with a range of wall/base units for storage. The building benefits from a communal laundry area and private parking to the rear of the property.

Originating in the 16th century Low Fell has quickly developed into one of the more popular of the two dozen or so villages which now comprise the Metropolitan Borough of Gateshead. The Durham Road area has now become a vibrant commercial hub with thriving shops, bars and restaurants as well as some banks and small offices. Whilst also offering it's own running and rugby clubs and highly regarded local schools demand for properties increases to grow as more buyers look to move into the area. The area also offers excellent links to the A1, Metrocentre and Team Valley for commuters.

